

STW

TENSION WEIGHT - SPRING TECHNOLOGY

PATENTED

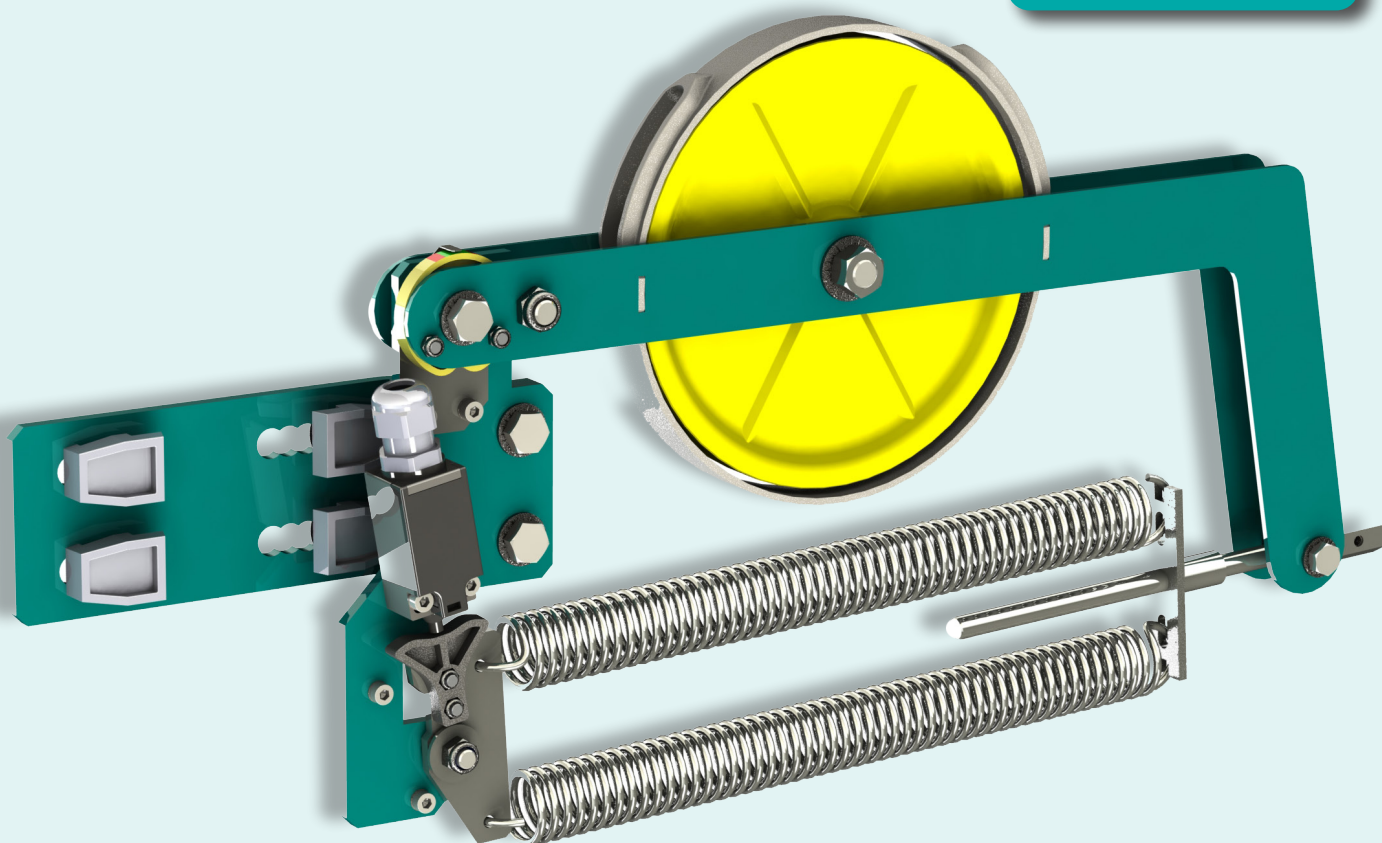

FEATURES

Extremely compact size pulley Ø 180 mm pulley, due to modern dual-spring technology

Applications for new elevator installations and modernizations

Spring failure monitoring system certified according to EN81-20

Nominal speed up to 1,75 m/s

Rope diameter 6 mm pulley Ø 180 mm

Suitable with Wittur OL20 Overspeed Governor

Suitable for most common used guide rails: T70 / T82 / T89 / T90

Easy and rapid installation

Maintenance free

Tension Force of 400N (minimum)

Compliance with Seismic requirements according to EN81-77

Compact dimensions

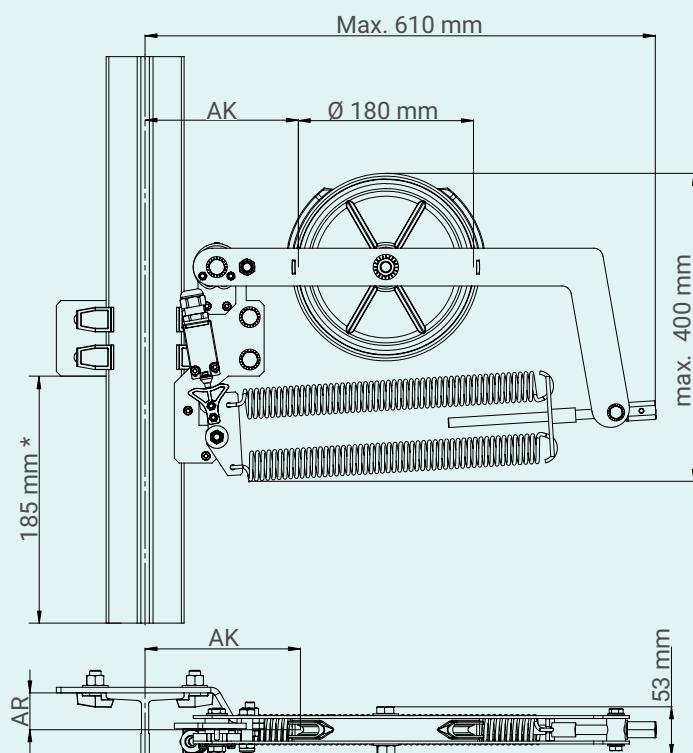

(*) Minimum high for installation from PIT floor

Indicator for visual inspection of rope tension from outside the shaft

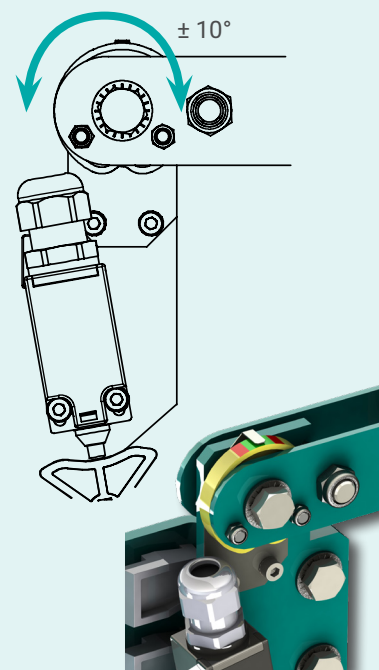

Safety Contact (IP67)

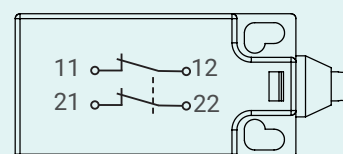

Two NC contacts 11/12 & 21/22

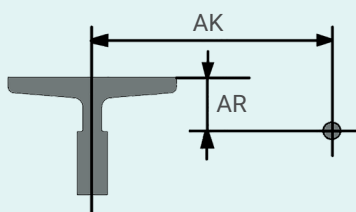

AK / AR	MRL Standing
165 / 25-38	✓
165 / 39-52	✓



WITTUR

YOUR GLOBAL PARTNER FOR COMPONENTS,
MODULES AND SYSTEMS IN THE ELEVATOR INDUSTRY



WITTUR.COM



STW on
wittur.com



ADVANCING THE ELEVATOR INDUSTRY®

STW - 05.17.066643 EN - English - July 2023

Subject to change without notice!