

ELEVATOR ACCORDING TO MACHINE DIRECTIVE

HHL W Line

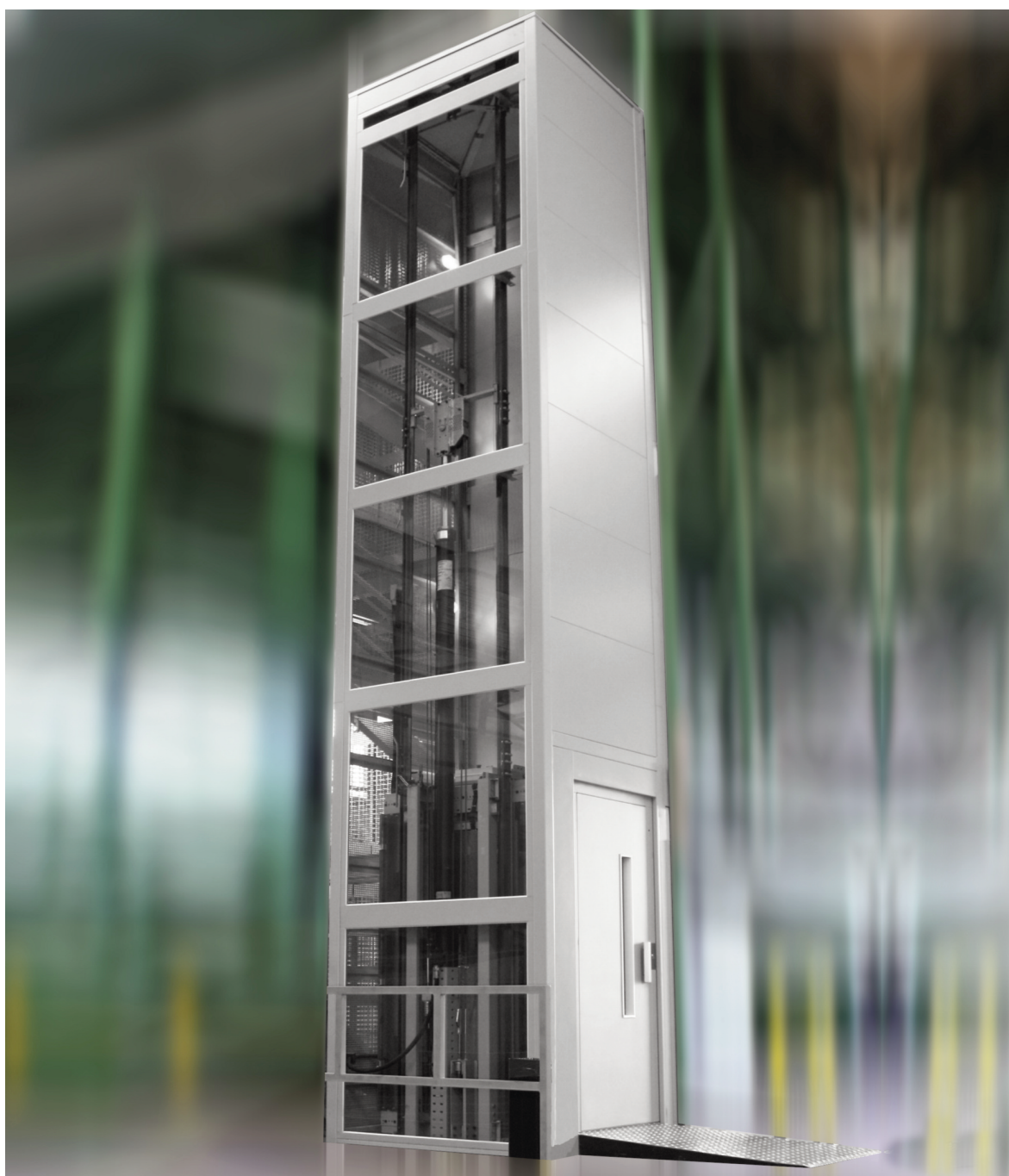

FOR A SUSTAINABLE WORLD FREE OF BARRIERS

safety *in* motion™

ADVANCED FEATURES

HHL W Line

A NEW WORLD FREE OF STAIRS

The HHL W Line, Wittur's machine roomless system, is the ideal solution for removing architectural barriers and for improving accessibility as well as the mobility of the aged and less able.

The HHL W Line has been designed specifically to satisfy all the requirements of residential, public and commercial buildings up to 8 stops with minimal impact on existing and new buildings, and with minimal use of space.

NORM COMPLIANT

The HHL W Line fulfills all the requirements of the Machine Directive 2006/42/EC. Wittur additionally offers the option of supplying the HHL W Line to comply with the EN81-28 and the EN81-70.

The HHL W Line is furthermore fully compliant with the Russian Lift Directive RL 782.

HHL W Line is structured according to EN81-41:2010 designed for passengers with reduced mobility:

- 250 kg load with car 850 x 1250 mm, for one single passenger either standing or sitting in a wheelchair type A
- 315 kg load with car 900 x 1400 mm, for a wheelchair type A or B and companion
- 385 kg load with car 1100 x 1400 mm, for a wheelchair type A or B with companion and adjacent entrances.

COMPACT DESIGN



The HHL W Line can be installed in any type of enclosure with a pit depth starting at just 125 mm, and headroom of just 2550 mm.

The elevator has been designed to allow increases in the dimension of the car in 50mm steps making it highly adaptable to any type of enclosure (within the permitted range).

The innovative design of the "C" shaped car/car sling incorporated into one single structure makes optimal use of existing well space.

Wittur's "Minilift" pump unit with its optimised dimensions can be housed along with the controller in an MRL cabinet measuring less than 1 m².

OPTIMIZED PACKAGING



A new and user-friendly logistics concept has been designed for Wittur's complete range of elevator systems. The elevator's sub-components are delivered pre-established space-saving and highly recyclable modules which have been clearly identified and numbered according to the order in which they are needed within the elevator's assembly sequence.

Each module is opened only when its contents are needed thereby increasing the ease of assembly and dramatically reducing the risk of loss or damage to components from boxes that have been opened before it was necessary.

ADVANCED FEATURES

HHL W Line

QUICK & EASY INSTALLATION



The HHL W Line is easy and quick to install.

A new modular logistics concept has been designed so that each box is opened only as and when its contents are needed, thereby avoiding time wastage and confusion.

Furthermore, each component has its own user-friendly manual, making the steps of the assembly process easy to follow and fail-safe.

The assembly of the pre-wired electrical components has also been made simpler thanks to Wittur's "Plug and Play" concept.

All the customer has to do is connect the components as instructed in the manuals.

The assembly of innovative C-shaped car/car sling can be carried out from inside the car itself making installation easier, especially in small spaces.

LOW MAINTENANCE



The simple design and high quality components account for the high reliability of the HHL W Line and the minimal maintenance that it requires and it is compliant with to EN 13015.

Modern technology in electrical safety components combined with mechanical elements in the pit and on the roof of the car offer a very high level of safety for users and installers.

All the components that must be reviewed during a maintenance check-up (ropes, safety gear etc..) are accessible from either inside the car or from the car roof.

A SILENT & COMFORTABLE RIDE WITH REDUCED ENERGY CONSUMPTION



Wittur's "Minilift" pump unit guarantees a high quality and silent ride for its passengers. Thanks to its submerged hydraulic pump unit, the HHL W Line has a very low noise level, making it particularly suitable for use in homes.

The HHL W Line, which can be connected to a domestic current as low as 1800W, offers a very low energy consumption.

Under development is the energy certification to the Directive VDI 4707-1.

The innovative C-shaped car/car sling reduces the weight of the suspended mass, thereby achieving a reduction in energy consumption.

ADVANCED FEATURES

Decoration



C.O.P.

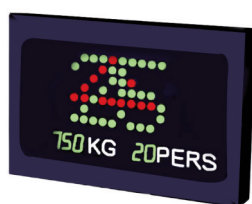

DISPLAY MW3LC

STANDARD



LOP P100



LOP P101

OPTIONAL



LOP P102



LOP P103

HANDRAILS



brushed stainless steel

gold stainless steel

PANEL FINISHES

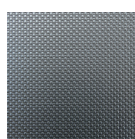

02-008 st st Linen



02-0010 st st brushed

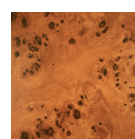

Laminate F1118
Amber Burl



Laminate F1139
Country Cherry

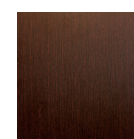

Laminate F1614
Punga



Laminate F5344
Seed Rigato



Laminate K1019
Azur



Laminate F6931
Latte Walnut



Laminate F7966
Burgundy

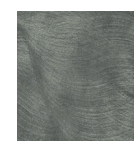

Laminate K5818
Mild Steel



Laminate K7016
Finn Beech



Melamine Cream



Melamine Grey



Melamine
Whitened Oak

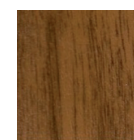

Skinplate
E12 Wood



Skinplate
U59 Grey

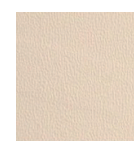

Skinplate
U64 Cream

FLOORS



G01
Black rubber



GR1 Pink porriño
granite



GR4 Crystal
white granite



GR11 Green
chestnut granite



GR12 Zimbabwe
black granite



LI 3075
Cream linoleum



LI 3139
Grey linoleum

The simplicity of the HHL W Line in no way detracts from the versatility of the options and car decorations available. The standard decorations, with their functional designs, offer the added advantage of a short production lead-time, but the HHL W Line can be supplied in a most versatile range of decorations to suit any request.

PRODUCT RANGE

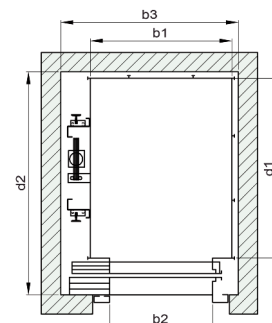
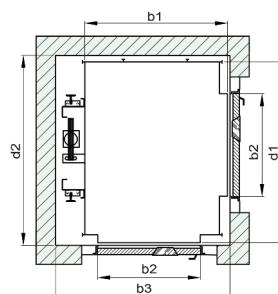
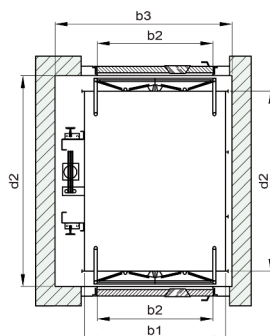

Car door type	Type (entrances)	Rated load	Internal car width (50 mm steps) b1		Internal car depth (50 mm steps) d1		Minimum well width b3	Minimum well depth d2	Max. clear opening b2	
		(max.) Kg	(min.)	(max.)	(min.)	(max.)	mm	mm		mm
Hydra 3 panels	1 - 0° / 180°	250	700	1100	900	1400	b1+280		d1+336	b1-100..200
		315					b1+280 b1+320 **			
		385								
	1 - 90°	250	850	1400	650	1100	b1+ 100		d1+516	b1-250
		315							d1+516 b1+556 **	
		385								
	2 - 180°	250	700	1100	900	1400	b1+280		d1+572	b1-100..200
		315					b1+280 b1+320 **			
		385					b1+320			
	2 - 90° / 270°	250	700	1100	900	1400	b1+516		d1+336	See tech catalogue.
		315					b1+516 b1+556 **			
		385					b1+556			
MDS1	1 - 0° / 180°	250	1000	1100	900	1400	b1 + 280		d1 + 290	b1-300
		315					b1 + 300 for C0800			
		385					b1 + 280 b1 + 300 for C0800 b1+320 *			
	1 - 90 °	250	1200	1400	650	1100	b1+ 100		d1 + 470	b1- 500
		315							d1 + 470 d1 + 510 *	
		385								
	2 - 180 °	250	1000	1100	900	1400	b1 + 280		d1 + 480	b1-300
		315					b1 + 300 for C0800			
		385					b1 + 280 b1 + 300 for C0800 b1+320 **			
	2 - 90° / 270°	250	1000	1100	1200	1400	b1 + 470		d1 + 290	See tech catalogue.
		315					b1 + 490 for C0800			
		385					b1 + 470 b1 + 490 for C0800 b1 + 510 **			
BUS	1 - 0° / 180°	250	700	1100	850	1400	b1 + 280		d1 + 170	b1 - 100
		315					b1 + 280 b1+320 *			
		385								
	1 - 90 °	250	850	1400	650	1100	b1 + 100		d1 + 350	b1 - 100
		315							d1 + 350 b1+320 *	
		385								
	2 - 180 °	250	700	1100	850	1400	b1 + 280		d1 + 240	b1 - 100
		315					b1 + 280 b1+320 **			
		385								
	2 - 90° / 270°	250	750	1200	950	1500	b1 + 250		d1 + 170	b1 - 100
		315					b1 + 250 b1+320 **			
		385					b1 + 250 b1+320 **			
No door	1 - 0° / 180°	250	650	1100	950	1500	b1 + 280		d1 + 70	b1 - 50
		315								
		385								
	1 - 90 °	250	850	1400	750	1200	b1 + 100		d1 + 280	b1 - 50
		315								
		385								
	2 - 180 °	250	650	1100	1050	1600	b1 + 280		d1 + 40	b1 - 50
		315					b1 + 280			
		385								
	2 - 90° / 270°	250	750	1200	950	1500	b1 + 250		d1 + 70	b1 - 150
		315					b1 + 250			
		385								

* Dimension with granite car floor and Classic decoration

** Dimension with granite car floor and/or Classic decoration

Internal height of the car	Minimum headroom	
	Hydra (3 panels) mm	MDS1/BUS/No door (mm)
2000	2650	2550
2100	2750	2650
2200	2850	2750

Minimum pit depth	
mm	
Rubber floor	125
Granite floor	140



YOUR GLOBAL PARTNER FOR COMPONENTS, MODULES AND SYSTEMS IN THE ELEVATOR INDUSTRY

Albania
Algeria
Argentina
Australia
Austria
Azerbaijan
Belarus
Belgium
Brazil
Bulgaria
China
Colombia
Croatia
Cuba
Czech Republic
Denmark
Egypt
Estonia
Finland
France
Georgia
Germany
Hong Kong
Hungary
Iceland
India
Indonesia
Iran
Iraq
Israel
Italy
Japan
Kazakhstan



Latvia
Lebanon
Liechtenstein
Lithuania
Malaysia
Mexico
Moldova
Morocco
Netherlands
Norway
Poland
Portugal
Romania
Russia
Saudi Arabia
Serbia
Singapore
Slovakia
Slovenia
South Africa
South Korea
Spain
Sweden
Switzerland
Taiwan
Tajikistan
Turkey
Turkmenistan
Ukraine
United Kingdom
USA
Uzbekistan
Vietnam

safety **in** *motion*™

www.wittur.com

More information
about Wittur Group
available on-line.

