

WCW05, WCW06, WCW10

COUNTERWEIGHT FRAME SERIES



COUNTERWEIGHT FRAME SERIES

WCW05, WCW06, WCW10

The WCW series counterweight frames are assembled using screws. Due to its narrow dimensions it is perfect for any standard solution up to 60 m travel height.

TYPE	WCW05	WCW06		WCW10	
Max. rated speed (m/s)	1,6	1,75		3,5	
Suspension	2:1	1:1	2:1	1:1	2:1
Max. Frame Height (mm)	3900				
Max. Suspended Load (kg)	1300	1350		2500	
DBG Min/Max (mm)	425/425	470/1020			490/1020
Guide Rail Type (mm)	5/9/15,88/16	5/8/9/10/12/14/15/15,88/16			
Pulley Ø (mm)	330	---	160/240/ 330	---	240/330/ 410/530
Rope Ø (mm)	8	6/6,5/6,7/ 8/8,1/10	6,5/6,7/ 8/8,1	8/8,1/10/13	
Rope type	Steel	Steel / PU Coated			

FEATURES

- Meets the EN 81-20 specification
- WCW-width (DBG*) as well as WCW-height can be chosen freely (in mm steps), within the technical limits
- Suitable for rail head width from 5 to 16 mm, acc. to standard dimension of guide rail width
- Suspension 1:1 up to 2:1
- Usage possible with counterweight safety gear (optional)
- Easy installation
- Small shipping dimensions

CONTENT OF SUPPLY

- Crosshead channel complete with rope anchor or rope pulley
- At suspension 1:1 rope anchor with equalisation springs are possible (optional)
- Roller guides or sliding guide shoes incl. Guide lubricator
- Buffer spacers (optional)
- Compensation chain hanger (optional)
- Filler-weights are "available on demand"

TYPE	WCW05	WCW06	WCW10
Slings compatibility	WCF06		WCF10

(*) DBG = Distance between guide

WCW06, WCW10 SUSPENSION 1:1

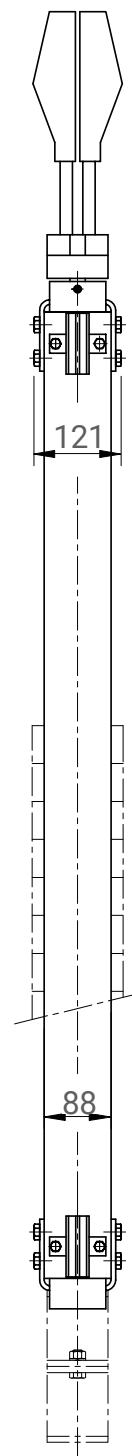
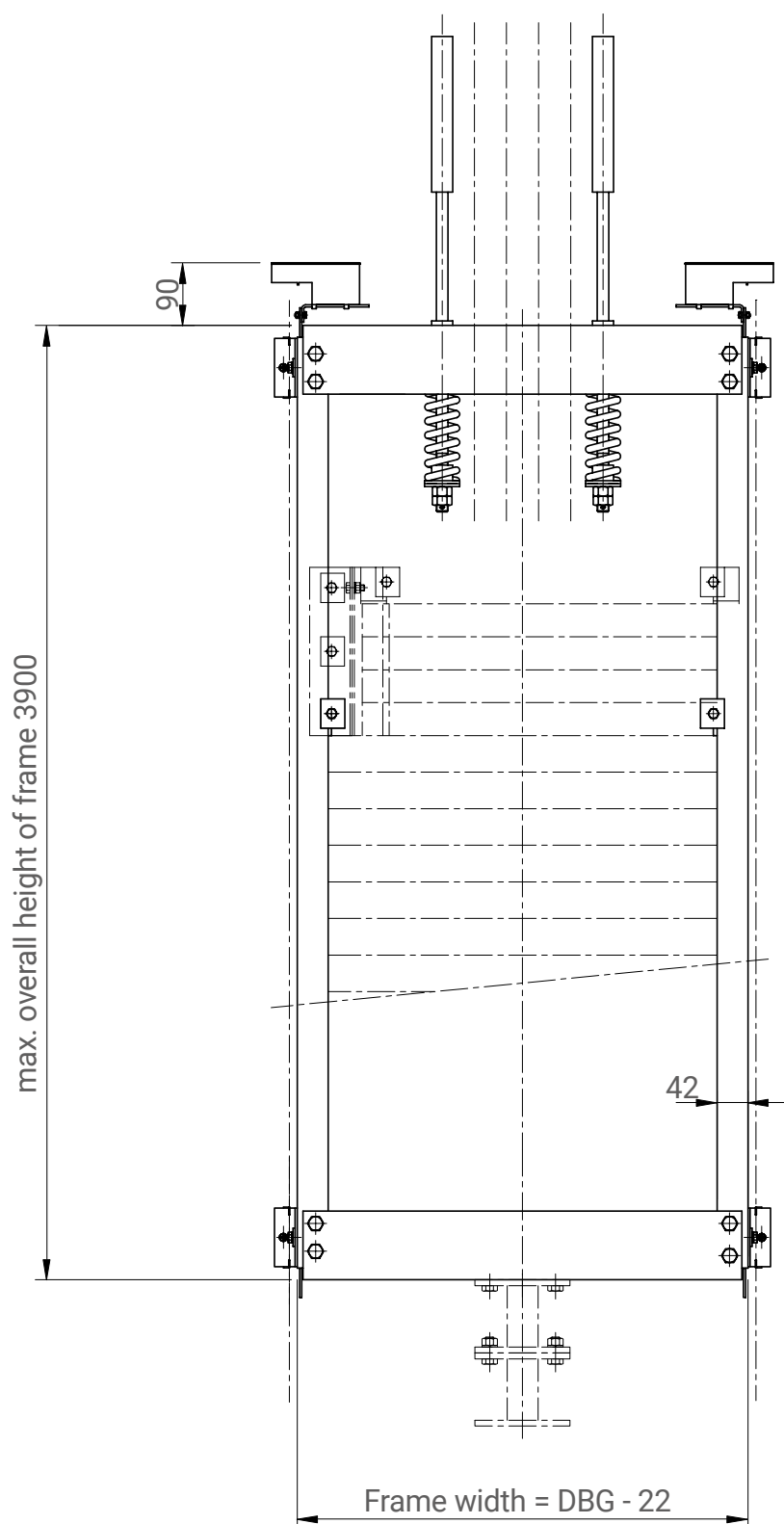

DBG = Distance between guide

WCW06, WCW10 SUSPENSION 2:1

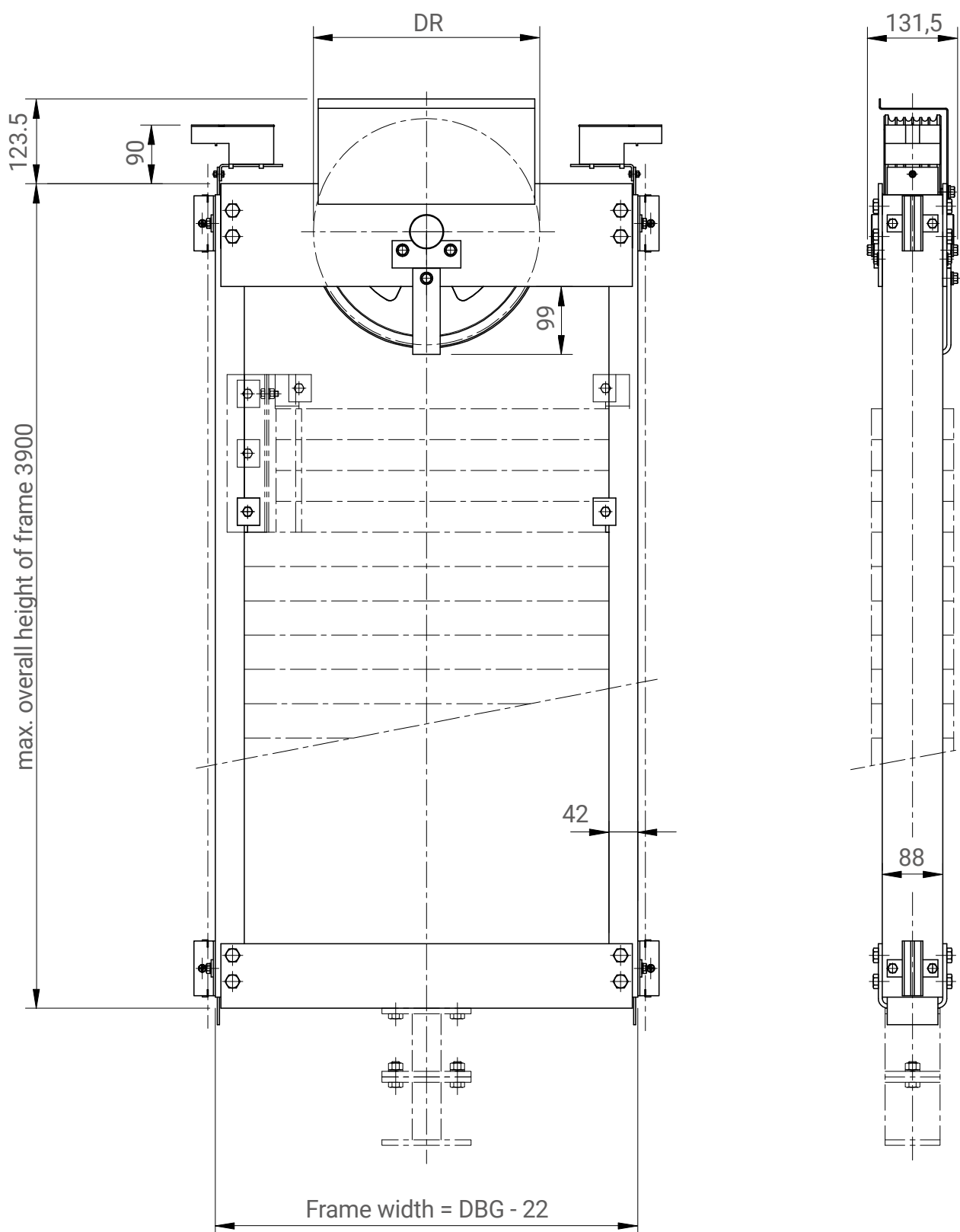

DBG = Distance between guide
DR = Pulley diameter



WITTUR

YOUR GLOBAL PARTNER FOR COMPONENTS,
MODULES AND SYSTEMS IN THE ELEVATOR INDUSTRY



W5314 - 05.15.201655 - English - October 2023

Subject to change without notice!

WITTUR.COM



WCW on
wittur.com



ADVANCING THE ELEVATOR INDUSTRY®