

Please send this order form to
orders.wed@wittur.com

General data

Contact name: e-Mail:

Project: Client company:

Quantity: Delivery date:
(With specifications given below.) (Delivery of **Standard** configurations in 4 weeks exw.)

Order number: Remarks:

Delivery address:



Motor options

☒ UL/CSA certification: ☐ **Standard = without** ☐ UL/CSA approved

☒ Suspension / Traction sheave: ☐ 2:1 ☐ 1:1
☐ 320 mm = **Standard** ☐ 400 mm

☒ Rated speed: ☐ 0.5 ms ☐ 0.63 ms ☐ 1.0 ms ☐ 1.6 ms ☐ 2.0 ms
(No standard needed.)

☒ Painting: ☐ **Standard = RAL 5018** ☐

☒ Electr. connection: ☐ **Standard = Terminal box**
(2 overexcitation rectifiers inside the terminal box)



☐ 2 overexcitation rectifiers will be delivered separately

☒ Rope guards: ☐ **Standard** ☐ Multi roof



(only for DT = 320 mm)

☒ Encoder system ☐ **Standard = Sendix 8.5873 - Biss-C - 10 m-cable with open wire ends**

☐ ECN 413 - **EnDat** ☐ ECN 413 - **SSI** ☐ ERN 487

☐ Electronic Nameplate (ENP) for CT unidrive SP and ECN 413-EnDat

(Order with ECN 413 EnDat is not influencing delivery time!)

☐ ... Please mark the relevant boxes.

page 1 of 4

Traction sheave - Groove profile

Please send this order form to
orders.wed@wittur.com



☒ Standard

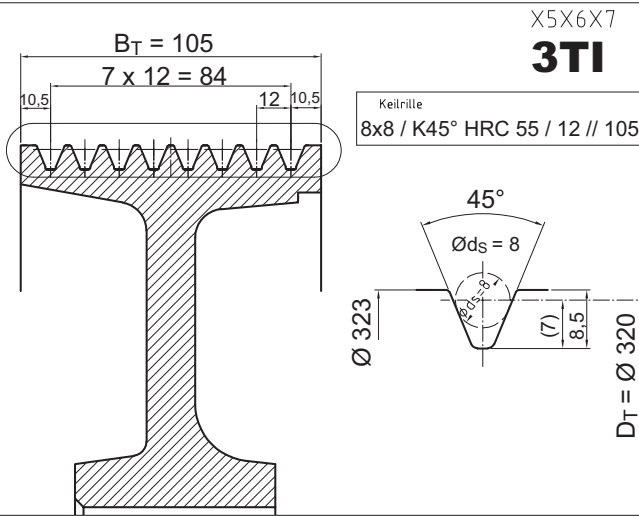

☐

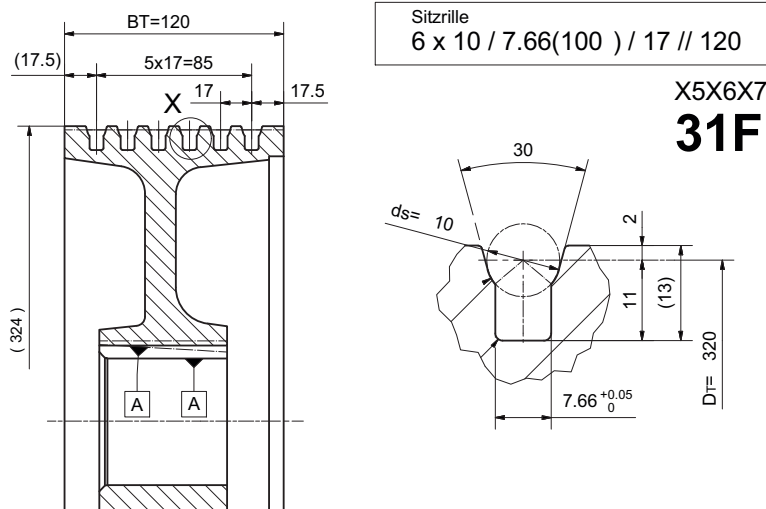

☐ another type

☐ ... Please mark the relevant boxes.

page 2 of 4

Accessories

Please send this order form to
orders.wed@wittur.com

☒ **BRAKE MANUAL RELEASE** ☐ without = **Standard**

☐ **remotely controlled** (for Bowden cable)

Brake with or without manual release as specified with the order.
No possibility for retrofit.

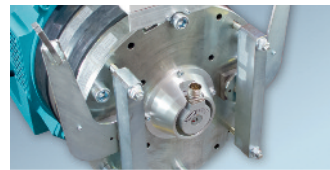

☐ **with lever block and 3 m Bowden cable**

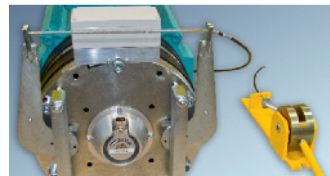

☐ **for machine room**



☒ **RETURN MOTION DEVICE** ☐ without = **Standard**

☐ **with** (only for $D_T = 400$ mm)



☒ **MOTOR CABLE SET** ☐ without = **Standard** ☐ with

Motor cable length: ☐ 5 m
☐ 7 m
☐ 10 m

Brake cable length: ☐ 5 m
☐ 7 m
☐ 10 m
☐ 15 m
☐ 20 m
☐ 30 m

☐ halogen free

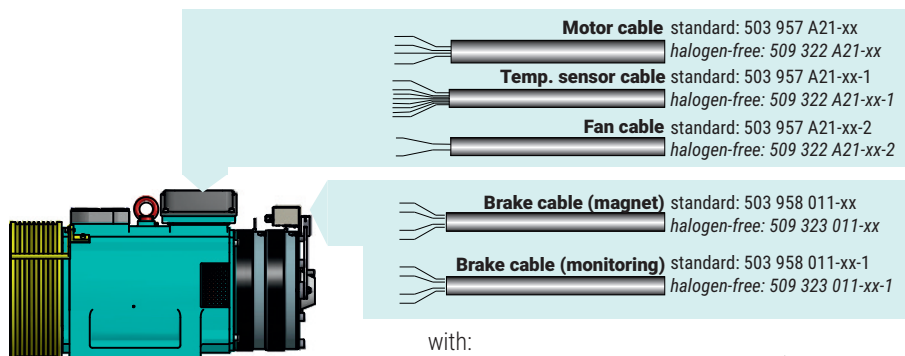

with:

A=2 ... cable cross section 4 x 2,5 mm² (for $I_{S3-40\%} < 36$ A)
A=4 ... cable cross section 4 x 4 mm² (for $I_{S3-40\%} < 47$ A)
A=6 ... cable cross section 4 x 6 mm² (for $I_{S3-40\%} < 60$ A)
xx ... cable length

☐ ... Please mark the relevant boxes.

page 3 of 4

MEASUREMENT SYSTEM CONNECTOR

(for Sendix 8.5873)

☐ without =
Standard open wire ends



☐ for inverter D-Pack



☐ for inverter KEB F 5



Please send this order form to
orders.wed@wittur.com

MEASUREMENT CABLE

(for ECN 413 and ERN 487)

☐ without =
Standard

☐ with- Cable length:

- ☐ 5 m
- ☐ 7 m
- ☐ 10 m
- ☐ 15 m
- ☐ 20 m

Measurement cable type	Inverter type	recommended encoder system	recommended measurement system cable
<input type="checkbox"/>	E-Pack Arkel ARCODE	ECN 413 (EnDat or SSI)	503 325 021 xx
<input type="checkbox"/>	D-Pack Arkel ADrive CT unidrive SP	ECN 413 (EnDat or SSI)	502 452 021 xx
<input type="checkbox"/>	Fuji Frenic	ECN 413 (EnDat)	502 679 022 xx
<input type="checkbox"/>	RST Elektronik FRC	ECN 413 (EnDat)	508 752 022 xx
<input type="checkbox"/>	GEFRAN (SIEI) AVY-L-M	ERN 487	503 499 022 xx
<input type="checkbox"/>	Vacon NXP	ECN 413 (EnDat)	503 289 021 xx
<input type="checkbox"/>	Yaskawa/ Omron L7 Telemecanique/ Schneider Altivar 71	ECN 413 (EnDat)	503 715 022 xx
<input type="checkbox"/>	Ziehl-Abegg 2SY/3BF	ECN 413 (EnDat or SSI)	508 749 022 xx

xx... cable length [m]

☐ ... Please mark the relevant boxes.

page 4 of 4