

# AUTOMATIC LANDING ROUND DOORS with mechanism in the top

3600



Code DS.2.003521.EN  
Version B  
Date 22.07.2016

|                                     |                             |
|-------------------------------------|-----------------------------|
| <input type="radio"/> Offer Request | <input type="radio"/> Order |
| Customer                            |                             |
| Address                             |                             |
| Fax/Email                           |                             |
| Tel.                                |                             |
| Contact Person                      |                             |

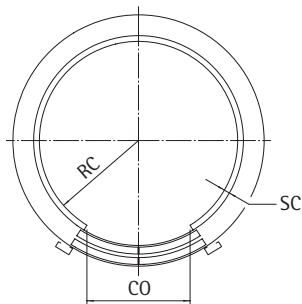

|                     |
|---------------------|
| Data                |
| Customer Reference  |
| Customer Number     |
| Destination Country |
| Request Delivery    |



- ◆ Radius of cabin on CO line (RC) \_\_\_\_\_
- ◆ Clear Opening (CO) \_\_\_\_\_
- ◆ Clear Height (CH) \_\_\_\_\_ (CH Std=2000)
- ◆ Thickness of cabin (SC) \_\_\_\_\_

## IN ACCORDANCE WITH:

- ☐ EN81-1/2      ☐ EN81-20/50 + EN81-1/2

| TYPE   | DOOR TYPE (FROM LANDING SIDE)   | QUANTITY |
|--------|---|----------|
| 01 R/C |        |          |
| 71 R/R | Right  |          |
| 71 R/L | Left   |          |

## EXECUTIONS

- ☐ IP20 Standard      ☐ Other: specify \_\_\_\_\_
- ☐ IP54 Waterproof

## FIRE PROTECTION

- ☐ Without
- ☐ Uninsulated Fire Rated .....
- ☐ Insulated Fire Rated .....  
(Check certificate availability)

## RUNBY

- ☐ Requested      ☐ Not Requested

## MECHANISM

- ☐ Antirust + Finish RAL 9005 (black)
- ☐ Cataphoresis + RAL 9005
- ☐ Full inox
- ☐ Aisi 304      ☐ Aisi 316
- ☐ Other: specify \_\_\_\_\_

- ☐ Without mechanism covering (standard)

- ☐ Mechanism covering only  
on shaft side



- ☐ Mechanism covering on all  
sides and stainless steel  
brushed brackets



## Finishing Covering

- ☐ Stainless Steel
- ☐ Aisi 304      ☐ Aisi 316
- ☐ Other: specify \_\_\_\_\_

All additional request must be checked for technical feasibility and are subject to longer lead times and additional cost



## AUTOMATIC LANDING ROUND DOORS with mechanism in the top

**3600**

Code  
Version  
Date

DS.2.003521.EN  
B  
22.07.2016

### FRAMES

#### Without frames

- ☐ Assembled with template (nr. pieces \_\_\_\_\_)  
☐ Frames produced by Customer

#### With frames

- ☐ Side Frame Dimension \_\_\_\_\_ (Standard 120)  
☐ Frame Depth \_\_\_\_\_ (Standard 70)  
☐ Top Frame Height \_\_\_\_\_ (sheet metal and glass framed panels min.240; glass panels min.400)

For different dimensions ask for feasibility

- ☐ Frames with sill-covering

- ☐ Double skin frames ☐ Filled with rock wool

#### Painting

- ☐ Antirust ☐ Other: specify \_\_\_\_\_

#### Cladding

- ☐ Stainless Steel ☐ Other: specify \_\_\_\_\_

- ☐ Push-button housing:  
m/m \_\_\_\_\_ x \_\_\_\_\_ Height m/m \_\_\_\_\_ (\*)

Indicator push-button position:

- ☐ Right side frame ☐ Left side frame

- ☐ Push-button dimensions: W \_\_\_\_\_ H \_\_\_\_\_ D \_\_\_\_\_

- ◆ With protection housing ☐ YES ☐ NO

- ☐ Indicator housing:  
m/m \_\_\_\_\_ x \_\_\_\_\_ Height m/m \_\_\_\_\_ (\*)

Indicator position:

- ☐ Right side frame ☐ Left side frame

- ☐ Indicator dimensions: W \_\_\_\_\_ H \_\_\_\_\_ D \_\_\_\_\_

- ◆ With protection housing ☐ YES ☐ NO

(\*) Dimensions from floor to bottom-edge of push-button

### PANELS

- ☐ Single-skinned metal sheet panels  
☐ Double-skinned metal sheet panels  
☐ Glass framed  
☐ Full glass with bottom visible trims

#### Painting

- ☐ Antirust ☐ Other: specify \_\_\_\_\_

#### Cladding

- ☐ Stainless Steel ☐ Other: specify \_\_\_\_\_

### SILL

- ☐ Stainless steel standard  
☐ Stainless steel sill electropainted \_\_\_\_\_  
☐ Other: specify \_\_\_\_\_

### TOE-GUARD

- ☐ 300 mm Minimum (standard)

- ☐ Other: specify \_\_\_\_\_

- ☐ Toeguard only in clear opening zone (standard)



- ☐ Toeguard long as sill

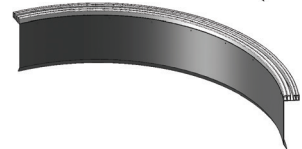

#### Painting

- ☐ Antirust ☐ Other: specify \_\_\_\_\_

#### Cladding

- ☐ Stainless Steel ☐ Other: specify \_\_\_\_\_

### EXTRA SAFETY DEVICES

- ☐ Anti-trapping device (only for glass panels and glass framed panels)  
☐ Pit Egress Device for nr \_\_\_\_\_ doors

### BRACKET EQUIPMENT

- ☐ With side brackets (only for frames)

### PACKING

- ☐ Standard pallet ☐ Seaway wooden crate  
☐ Wooden cage ☐ ISPM15 Norm

### NOTE

### Order Revisions

| Rev. | Date | Filled in By | Description |
|------|------|--------------|-------------|
| A    |      |              |             |
| B    |      |              |             |
| C    |      |              |             |
| D    |      |              |             |
| E    |      |              |             |

Subject to change without notice!