

限速器
OVERSPEED GOVERNOR
型号 OL25
TYPE OL25

页号/sheet TC.7003833.ZH.1
日期/date 24/06/2016
版本/version B-26/04/2017
审批/approved WAT/KKR

1. 描述

Description

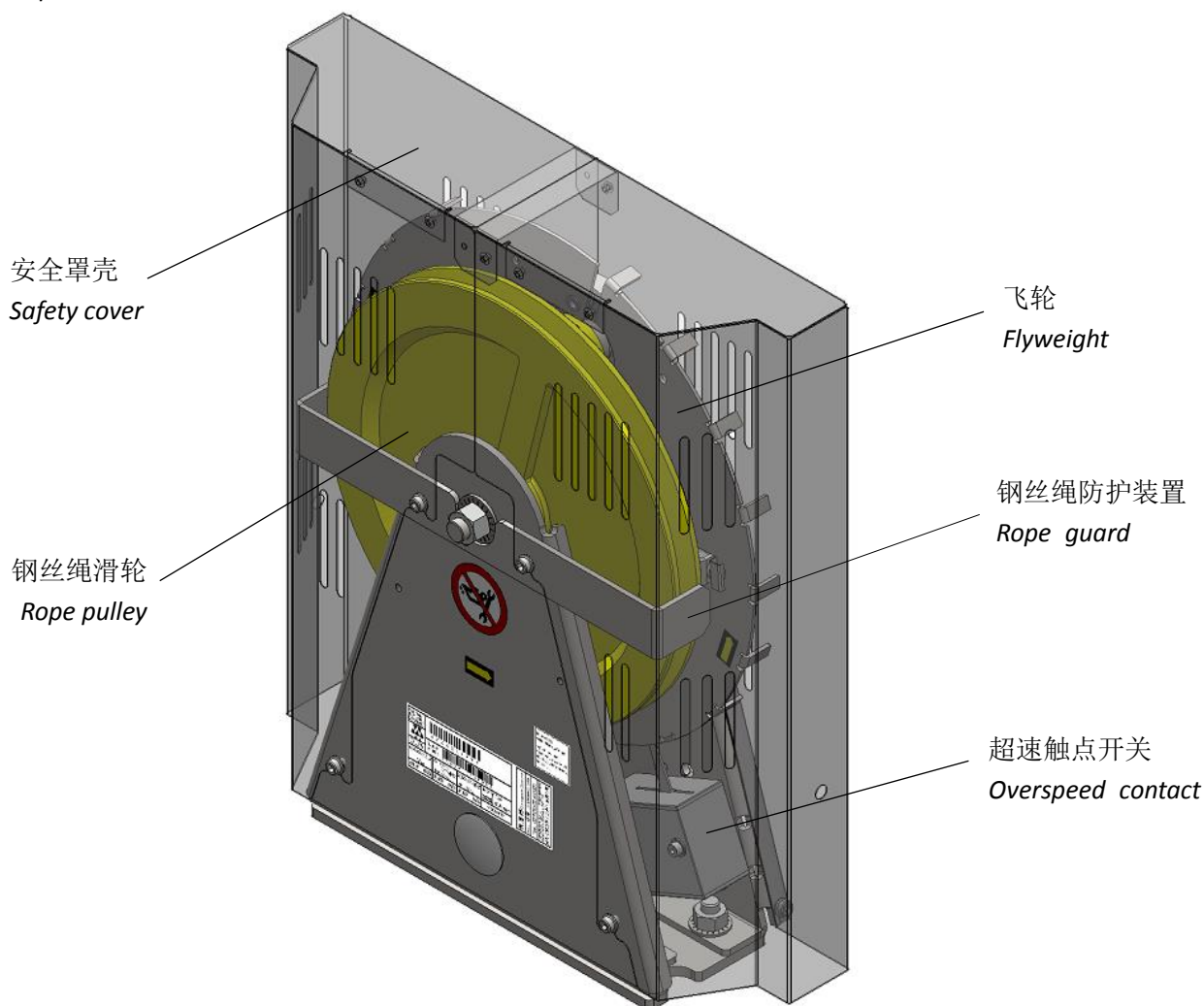

OL25 限速器是在轿厢超过最高限定速度时启用的一种安全部件。

The overspeed governor OL25 is a safety component which is activated when the maximum rated speed of the car is passed.

OL25 具有双向电气保护和单向机械释放。

The OL25 has a bi-directional electrical protection and a single-directional mechanical release.

如果轿厢架超过最高额定速度并达到动作速度，限速器开始动作并通过限速器钢丝绳启动安全钳，轿厢架停止并固定在导轨上。

If the car frame exceeds the max nominal speed and reaches the tripping speed, the overspeed governor intervenes and activates the safety gear through the governor rope. The car frame is stopped and held on to the guide rails.

产品随时更新，恕不另行通知！

Subject to change without notice!



限速器
OVERSPEED GOVERNOR
型号 OL25
TYPE OL25

页号/sheet TC.7003833.ZH.2
日期/date 24/06/2016
版本/version B-26/04/2017
审批/approved WAT/KKR

2. 使用范围

Range of use

2.1 许可

Approval

OL25 限速器通过了以下标准认证:

- 电梯指令 2014/33/EU (欧盟)
- EN 81-1/EN 81-2/EN 81-20/ EN 81-50 (欧盟)
- GB 7588 (中国)

The overspeed governor OL25 has been approved in accordance with the following standards:

- Directive 2014/33/EU (lifts) (EU)
- EN 81-1/EN 81-2/EN 81-20/ EN 81-50 (EU)
- GB 7588 (China)

2.2 运行参数

Operation data

最大行程高度 Max. travel height	145m/115m
限速器与张紧配重之间的最大距离 Max. distance between overspeed governor and tension weight	150m/120m 参见第 5 页 refer page 5
额定速度 Rated speed	1.0m/s, 1.5m/s, 1.75m/s 2.0m/s, 2.5 m/s
张紧配重 Tension weight	250N~550N 参见第 5 页 refer page 5
限速器制动力 Brake force of the governor	min. 300N / min.500N 参见第 5 页 refer page 5
钢丝绳滑轮直径 Rope pulley diameter	234/240mm
钢丝绳直径 Rope pulley diameter	6/8mm
运行温度 Rang of temperature during operation	-20... +50°C *
储存温度 Rang of temperature during storage	-40... +70°C
最大空气湿度 Max. air humidity	<95% rH (not condensing)
保护等级 Protection classification	IP2x

* 对于适用于 EN81 的电梯: +5...+40°C; 如果当地标准没有更严格范围说明, 一般温度范围是: -20...+50°C

For lifts according EN81: +5...+40°C; General temperature range if no tighter range is sated in the local valid code: -20...+50°C

产品随时更新, 恕不另行通知!

Subject to change without notice!



限速器
OVERSPEED GOVERNOR
型号 OL25
TYPE OL25

页号/sheet TC.7003833.ZH.3
日期/date 24/06/2016
版本/version B-26/04/2017
审批/approved WAT/KKR

2.3 型号概述

General view

钢丝绳直径 Rope diam. [mm]	额定速度 Nominal speed NS [m/s]	应用 Application	电气制动速度 Contact speed CS [m/s]		机械制动速度 Tripping speed TS [m/s]	
d=6/8 (DB=234/240)	1.0	CAR/CWT _[1]	1.15	1.35	1.28	1.35
		CWT _[2]	1.27	1.49	1.41	1.49
	1.5	CAR/CWT _[1]	1.73	1.98	1.88	1.98
		CWT _[2]	1.90	2.17	2.06	2.17
	1.75	CAR/CWT _[1]	2.01	2.29	2.17	2.29
		CWT _[2]	2.21	2.52	2.39	2.52
	2.0	CAR/CWT _[1]	2.30	2.60	2.47	2.60
		CWT _[2]	2.53	2.86	2.72	2.86
	2.5	CAR/CWT _[1]	2.88	3.23	3.06	3.23
		CWT _[2]	3.16	3.55	3.37	3.55

如需表格未给出的额定速度，请联系我们。
Please contact us, if non- indicated NS is needed.

CAR: 轿厢 Car CWT: 对重 Counterweight

注:

CAR: 符合标准 GB 7588、EN 81-1、EN 81-20;

CWT_[1]: 符合标准 EN 81-20;

CWT_[2]: 符合标准 GB 7588、EN 81-1。

Notes:

CAR: conform to the norms GB 7588, EN 81-1, EN 81-20;

CWT_[1]: conform to the norm EN 81-20;

CWT_[2]: conform to the norms GB 7588, EN 81-1.

2.4 功能

Function

限速器的基本功能是通过机械和电气方式检测超速:

- 通过机械方式启动安全钳
- 通过电气方式停止电梯驱动 (限速器配备了超速触点开关)
- 需要用张紧配重拉紧限速器钢丝绳。

The basic functions of the overspeed governor are to detect overspeed mechanically and electrically:

- to activate the safety gear mechanically
- to stop the elevator drive electrically (the overspeed governor is equipped with overspeed contact switch)
- a tension weight is needed to tighten the rope of the overspeed governor

产品随时更新，恕不另行通知!

Subject to change without notice!



限速器
OVERSPEED GOVERNOR
型号 OL25
TYPE OL25

页号/sheet TC.7003833.ZH.4
日期/date 24/06/2016
版本/version B-26/04/2017
审批/approved WAT/KKR

动作方向:

右动作, 左动作 (根据布局)

Tripping direction:

Tripping right, Tripping left (according to layout)

响应时间



限速器动作之前的响应时间较短, 因为该限速器可以在 360° 上任一点动作。



The response time of the overspeed governor before tripping is very short because the governor trips at any point over 360°

产品环境

- 施加在限速器上钢丝绳重量 ≤ 515 N

- 张紧配重:

垂直式张紧装置或悬臂式张紧装置 (含安全开关, 手动复位型)

最小张紧重量 250N

最大张紧重量 550N

- 钢丝绳:

限速器要通过专门为此设计的钢丝绳驱动。钢丝绳的最大制动负载需满足安全系数 8。钢丝绳额定直径至少为 6mm, 最大 8mm。

- 钢丝绳参数:

抗拉等级 $\geq 1570 \text{ N/mm}^2$ 且 $\leq 1960 \text{ N/mm}^2$

例如: d=6mm, 6x19s+FC, 1570 N/mm^2 , 最小破断力 18.7kN

或更优质量

限速器钢丝绳应容易与安全钳分离。

Product environment

- Rope weight applied to the governor $\leq 515 \text{ N}$

- Tension weight:

Vertically guided or swing arm (including safety switch, manual reset type)

min. tension weight 250N

max. tension weight 550N

- Rope:

The Overspeed governor shall be driven by a steel wire rope designed for that purpose. The maximum braking load of the rope shall satisfy a safety factor of 8. The nominal rope diameter shall be at least 6mm and maximum 8 mm.

- Rope data:

Tensile grade $\geq 1570 \text{ N/mm}^2$ and $\leq 1960 \text{ N/mm}^2$

E.g. d=6mm, 6x19+Fiber core, 1570 N/mm^2 , min. brake force 18.7kN

or better quality

The overspeed governor rope shall be easily detachable from the safety gear.



限速器
OVERSPEED GOVERNOR
型号 OL25
TYPE OL25

页号/sheet TC.7003833.ZH.5
日期/date 24/06/2016
版本/version B-26/04/2017
审批/approved WAT/KKR

需按照下表选用合适的钢丝绳和张紧重

Choose proper rope and tension weight according below table

制动力 <i>Brake force</i>	钢丝绳高 <i>Rope height</i>	6mm 钢丝绳 <i>Rope</i>				8mm 钢丝绳 <i>Rope</i>			
		结构类型 <i>Type</i>	抗拉强度 <i>Tensile stress</i> (N/mm ²)	最小破断力 <i>Min. braking force</i> (KN)	张紧重 <i>Tension weight</i> (N)	结构类型 <i>Type</i>	抗拉强度 <i>Tensile stress</i> (N/mm ²)	最小破断力 <i>Min. braking force</i> (KN)	张紧重 <i>Tension weight</i> (N)
≥300N	≤40m	6x19+FC	≥1570	18.7	250~350	8x19+FC	≥1570	29.4	250~350
	≤80m				350~450				350~450
	≤120m				450~550				450~550
	≤150m	6x19+IWR	1960	≥25.8	550	x			
≥500N	≤40m	6x19+FC	≥1570	18.7	350~450	8x19+FC	≥1570	29.4	350~450
	≤80m				350~450				450~550
	≤120m				450~550				550
	≤150m	6x19+IWR	1960	≥25.8	550	x			

备注: 钢丝绳抗拉强度≤1960MPa; 钢丝绳高指限速器和张紧配重的绳轮中心距。

Remark: Rope tensile stress ≤1960MPa; Rope height is the pulley center distance between overspeed governor and tension weight.

安全防护

Safety protection



安全罩壳必须强制使用!



Safety cover is mandatory to be used!

限速器
OVERSPEED GOVERNOR
型号 OL25
TYPE OL25

页号/sheet TC.7003833.ZH.6
日期/date 24/06/2016
版本/version B-26/04/2017
审批/approved WAT/KKR

3. 项目工程设计与组装

Project engineering and assembly

3.1 尺寸

Dimensions

d[mm]	DB[mm]	DC[mm]
6	234	250
8	240	250

- d 钢丝绳直径 *rope diameter*
DB 限速器钢丝绳驱动槽的额定直径
Nominal diameter of the pulley groove for the governor rope
DC 绳轮外径 *Pulley outside diameter*

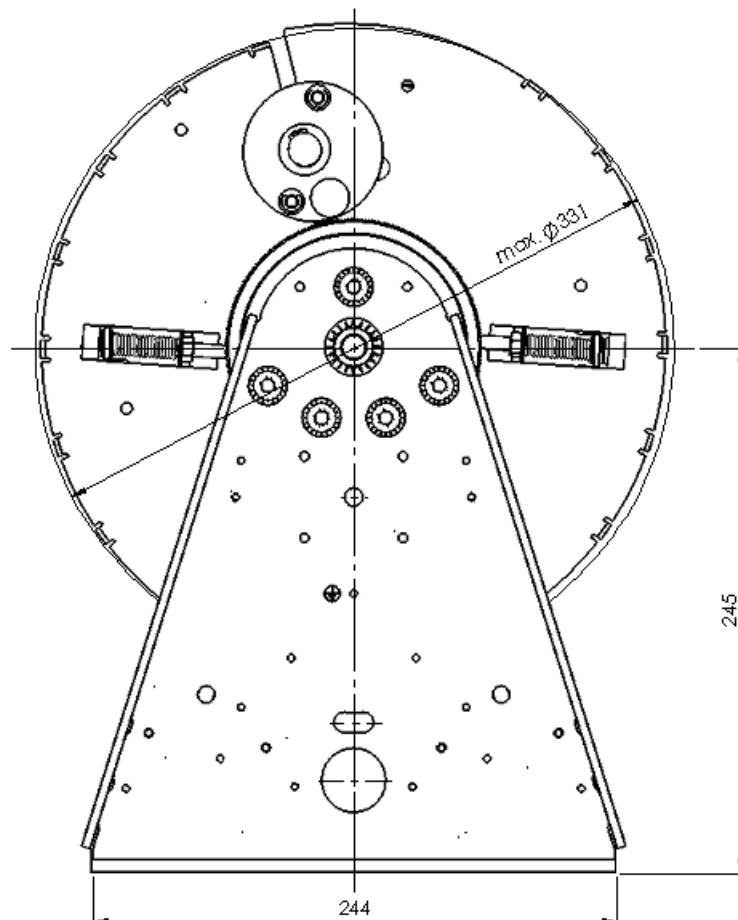
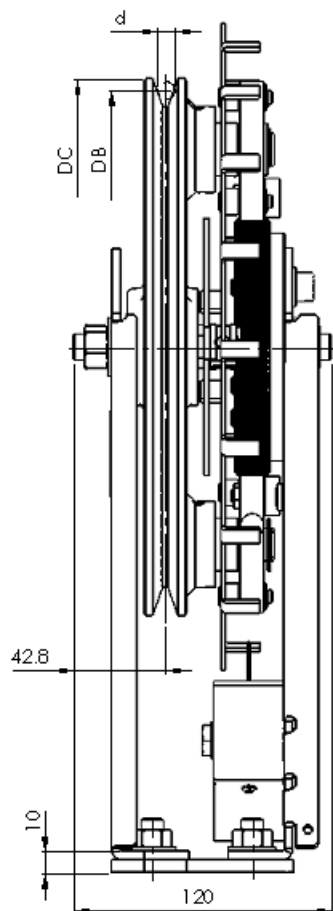
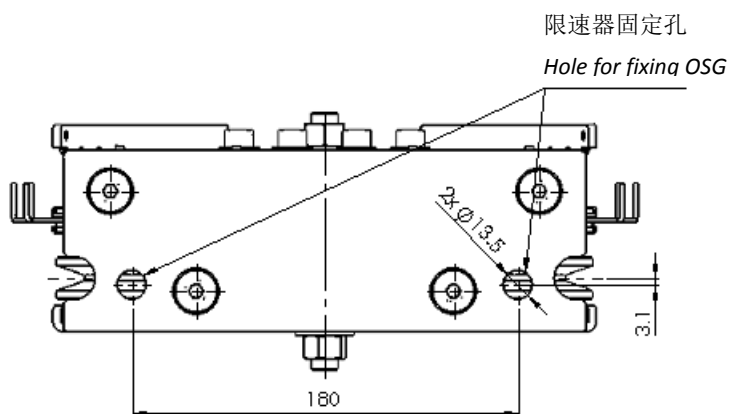

OL25 安全罩壳可以分开为左右两部分，因此安装或拆除罩壳所需要的空间很小。安装好所有安全防护装置后，尺寸如下：

OL25 safety cover can split into left and right parts, so a small space is needed for installation or removal. After all safety guards installed, dimensions are like below:

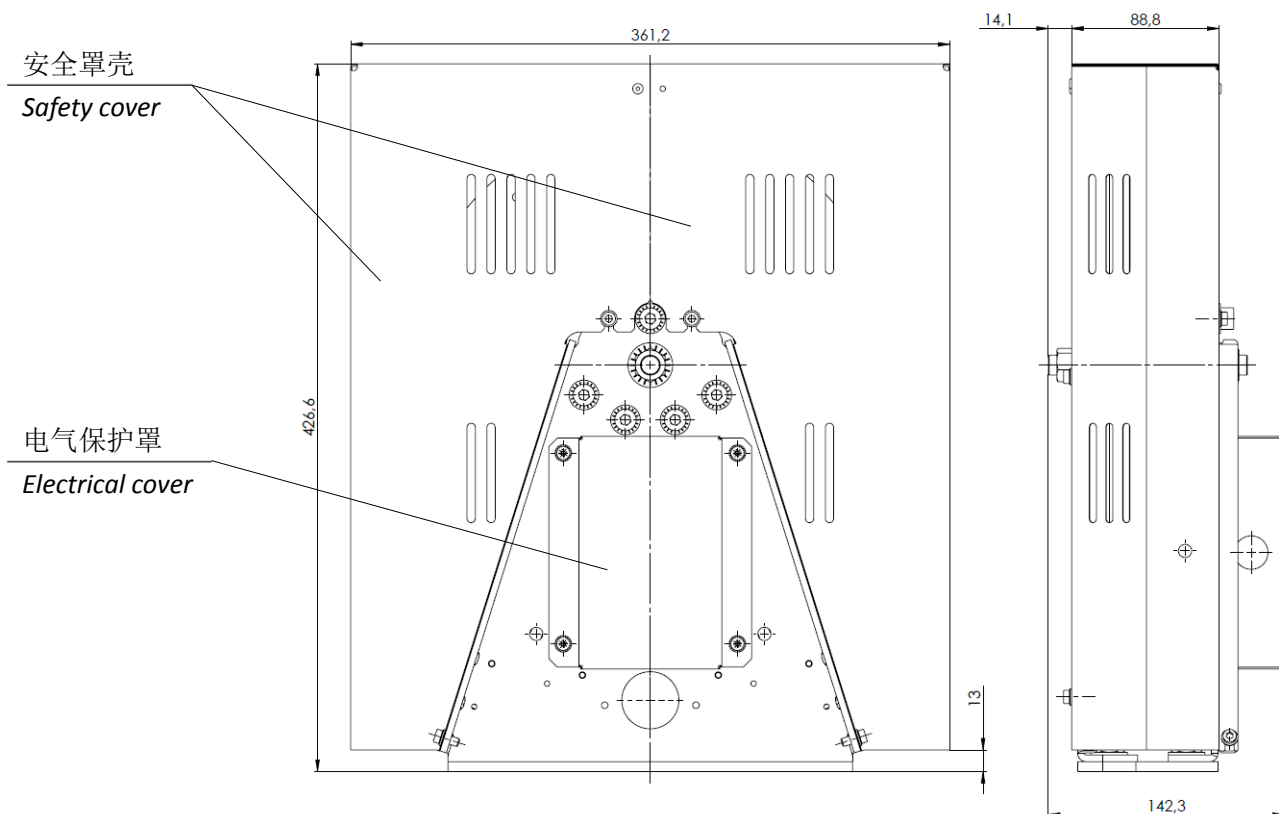

3.2 提拉方向 Tripping direction

飞轮上箭头符号指明了提拉方向：

The arrow-indicator on the flyweight shows the tripping direction:

右侧提拉 Tripping direction right

左侧提拉 Tripping direction left

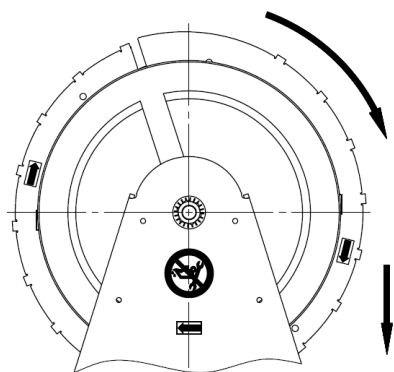

安全钳侧
Down safety gear
side

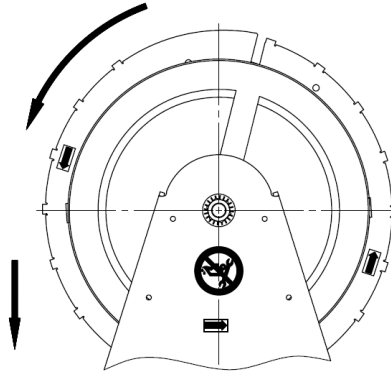

限速器
OVERSPEED GOVERNOR
型号 OL25
TYPE OL25

页号/sheet TC.7003833.ZH.8
日期/date 24/06/2016
版本/version B-26/04/2017
审批/approved WAT/KKR

3.3 安装方法

Fixing method



OL25 可以直立安
OL25 can be fixed standing

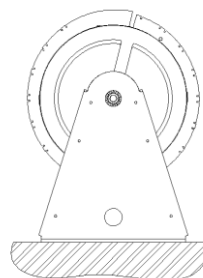

安装公差:

Installation tolerances:

- 限速器必须垂直安装
The overspeed governor must be installed vertically

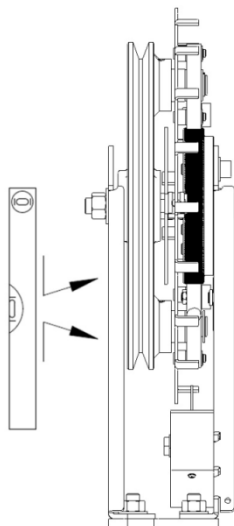

- 安装限速器的方式必须保证限速器钢丝绳平行地进入绳槽中

The overspeed governor must be installed in a way, that the governor rope runs parallel into the pulley groove.

- 钢丝绳的最大建议倾角 α 如下:

The maximum recommended declination (α) of the rope is:

钢丝绳额定直径 d=6mm => 最大 $\pm 2^\circ$

d=8mm => 最大 $\pm 1^\circ$

Nominal rope diameter d=6mm => max $\pm 2^\circ$

d=8mm => max $\pm 1^\circ$

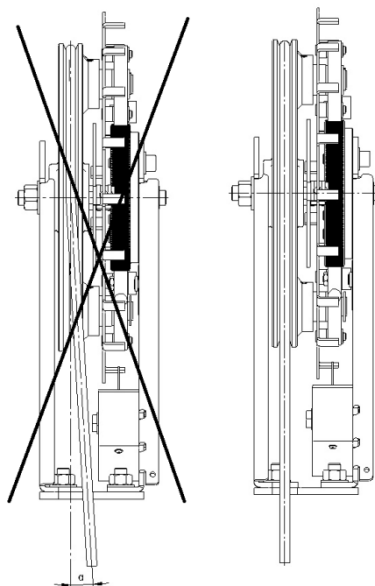

产品随时更新，恕不另行通知！

Subject to change without notice!

限速器
OVERSPEED GOVERNOR
型号 OL25
TYPE OL25

页号/sheet TC.7003833.ZH.9
日期/date 24/06/2016
版本/version B-26/04/2017
审批/approved WAT/KKR

4. OL25 配置

OL25 configuration

4.1 标准配置

Standard version

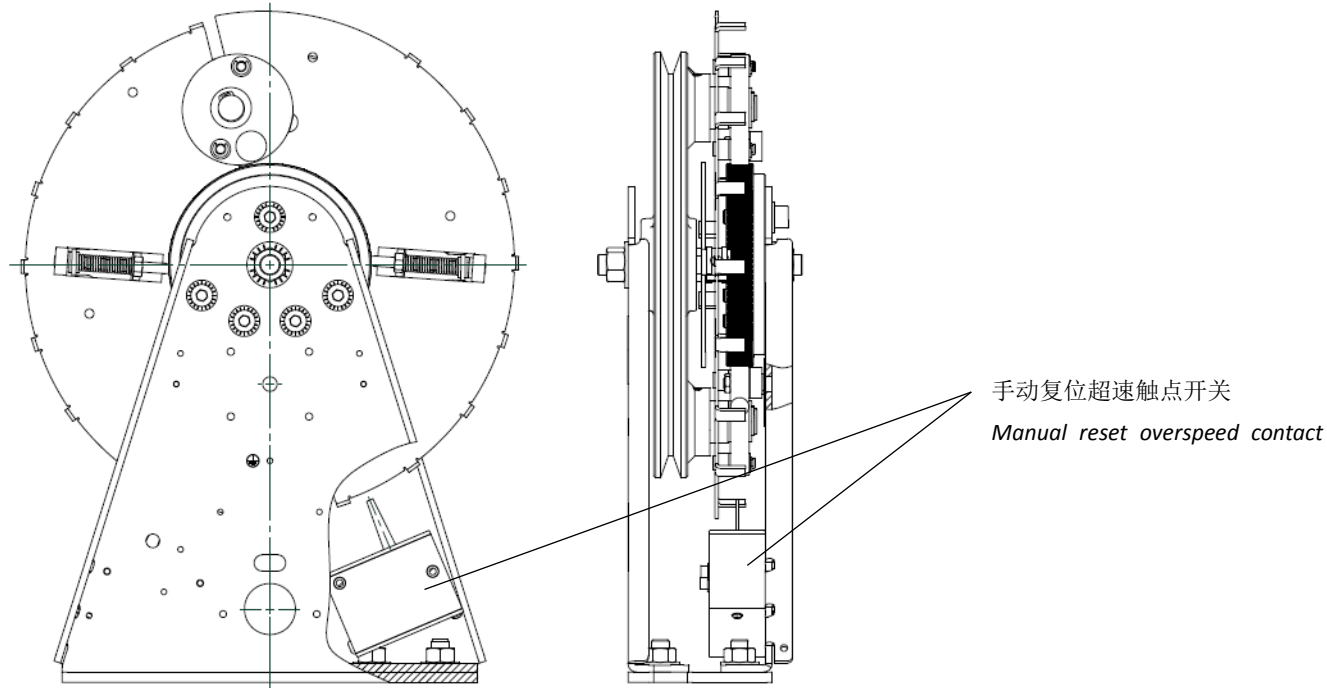

4.1.1 使用范围

Range of use

OL25 标准配置可用于有机房电梯。

OL25 standard version can be used in machine-room elevators.

限速器
OVERSPEED GOVERNOR
型号 OL25
TYPE OL25

页号/sheet TC.7003833.ZH.10
日期/date 24/06/2016
版本/version B-26/04/2017
审批/approved WAT/KKR

4.1.2 手动测试动作装置

Manual test tripping device

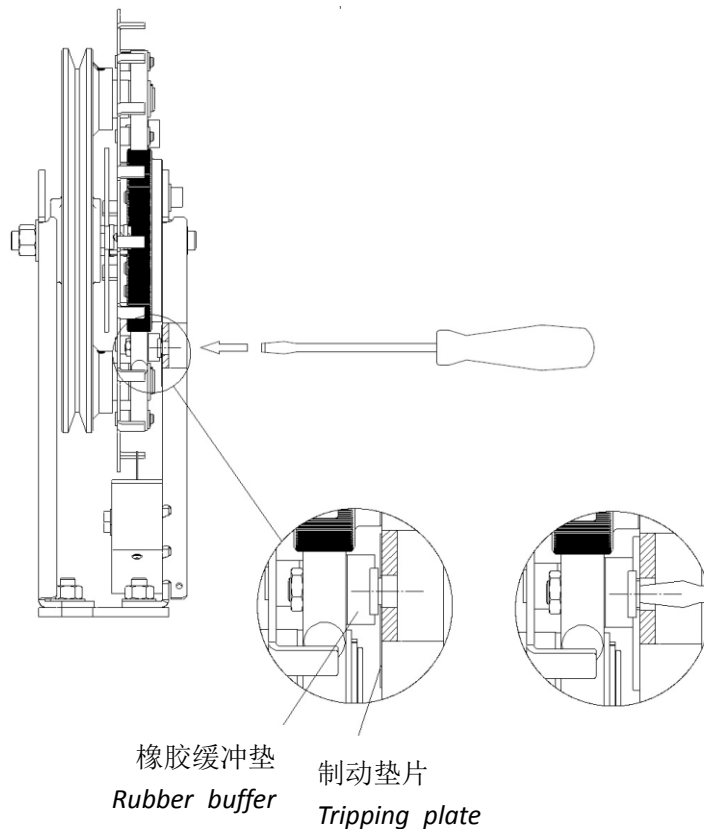

该产品的一般用途:

- 测试限速器
- 检查安全钳
- 通过操控限速器和安全钳，在电梯速度低于动作速度时制停电梯

The general purposes of the product are:

- Testing of overspeed governor
- Check of safety gear
- Stopping of elevator below tripping speed by operating the overspeed governor and the safety gear

应用:

Application:

轿厢和配重:

For cars and counterweights:

- $1.0 \text{ m/s} \leq \text{额定速度 (NS)} \leq 2.5 \text{ m/s}$
- 动作方向: 右转或左转

- $1.0 \text{ m/s} \leq \text{nominal speed (NS)} \leq 2.5 \text{ m/s}$
- function direction: turning right, or turning left

若订购 OL25 标准配置, 则已经包含了该手动测试动作装置。

Manual test tripping device is already included when OL25 standard version is ordered.

4.1.3 手动复位超速触点开关

Manual reset overspeed contact switch

每台 OL25 标准配置限速器安装了 2 个手动复位超速触点开关。每个开关有以下主要电气参数：

- 使用范围 *range of use*: DC-13: U_e/I_e 24V/1A
AC-15: U_e/I_e 220V/4A,
 U_e/I_e 380V/2.5A,
 U_e/I_e 500V/1A
- 热电流 *Thermoelectric current*: $I_{the} = 10A$
- 绝缘电压 *Isolation voltage*: $U_i = 500V$ AC
- 防护等级 *Protection class*: IP54
- 符合标准 *Conformity standard*: EN 60947-5-1
GB 14048.5

An OL25 standard version overspeed governor is equipped with 2 manual reset overspeed contact switches. Each switch has main electrical properties as following:

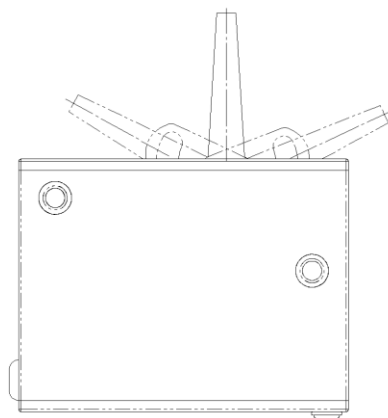

4.1.4 电气接线

Electric wiring

2 个手动复位超速触点开关需先串联，然后接入电气安全回路中。

开关串联工作已由厂家完成，用户仅需按照下图接线：

The 2 manual reset overspeed contact switches should be series-wound first and then connected to electrical safety circuit.

The series connection of switches is already finished at manufacturer. The client just needs to do wiring according below diagram:

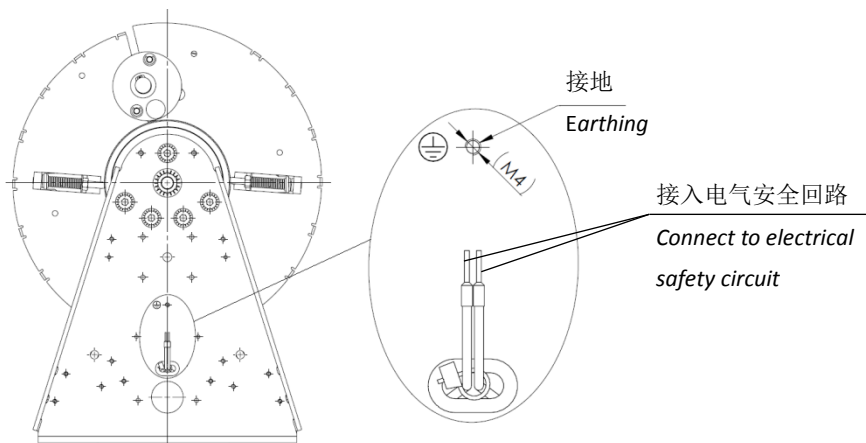

限速器
OVERSPEED GOVERNOR
型号 OL25
TYPE OL25

页号/sheet TC.7003833.ZH.12
日期/date 24/06/2016
版本/version B-26/04/2017
审批/approved WAT/KKR

4.2 远程配置

Remote version

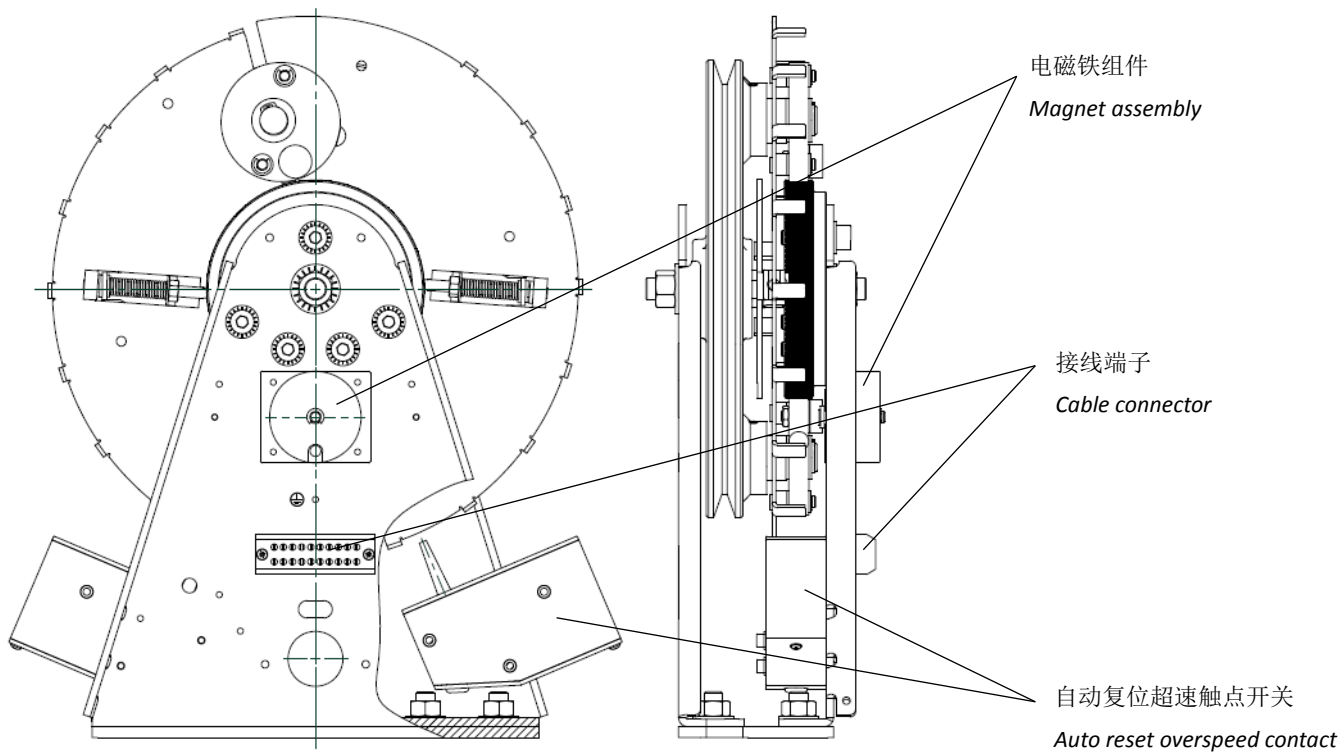

4.2.1 使用范围

Range of use

OL25 远程配置可用于有机房或无机房电梯。

OL25 standard version can be used in machine-room or machine-room-less elevators.

4.2.2 自动测试动作装置

Auto test tripping device

OL25 远程配置限速器包含了自动测试动作装置，主要由电磁铁组件、滑动轴承、远程控制销以及标准配置一样的制动垫片、橡胶缓冲垫组成。

OL25 remote version has an auto test tripping device which is made of magnet assembly, slide bearing, remote control pin and also tripping plate, rubber buffer as well as standard version.

该产品的一般用途:

- 测试限速器
- 检查安全钳
- 通过操控限速器和安全钳，在电梯速度低于动作速度时制停电梯

The general purposes of the product are:

- Testing of overspeed governor
- Check of safety gear
- Stopping of elevator below tripping speed by operating the overspeed governor and the safety gear

产品随时更新，恕不另行通知！

Subject to change without notice!



限速器
OVERSPEED GOVERNOR
型号 OL25
TYPE OL25

页号/sheet TC.7003833.ZH.13
日期/date 24/06/2016
版本/version B-26/04/2017
审批/approved WAT/KKR

应用:

轿厢和配重:

- $1.0 \text{ m/s} \leq \text{额定速度 (NS)} \leq 2.5 \text{ m/s}$
- 动作方向: 右转或左转

该自动测试动作装置由厂家安装并调节。

Application:

For cars and counterweights:

- $1.0 \text{ m/s} \leq \text{nominal speed (NS)} \leq 2.5 \text{ m/s}$
- function direction: turning right, or turning left

The auto test tripping device is fixed and adjusted at manufacturer.

4.2.3 电磁铁组件

Magnet assembly

电气规格 Electrical Specification	
电压 Voltage	U=24V DC
电流 Current	$I \leq 1.5 \text{ A}$ (24V DC, 20°C)
绝缘等级 Insulation class	F (155°C)
通电率 Duty factor	ED=10% / 5min
保护等级 IP-Code	IP54 (不含裸线部分 bare wires not included)

4.2.4 自动复位超速触点开关

Auto reset overspeed contact switch

每台 OL25 远程配置限速器安装了 2 个自动复位超速触点开关。每个开关有以下主要电气参数:

- 使用范围 range of use: DC-13: U_e/I_e 24V/1A
AC-15: U_e/I_e 220V/4A,
 U_e/I_e 380V/2.5A,
 U_e/I_e 500V/1A
- 热电流 Thermoelectric current: $I_{the} = 10 \text{ A}$
- 绝缘电压 Isolation voltage: $U_i = 500 \text{ V AC}$
- 防护等级 Protection class: IP54
- 符合标准 Conformity standard: EN 60947-5-1
GB 14048.5
- 复位电磁铁 Magnet for reset:
电压 Voltage U= 24V DC
电流 Current $I \geq 1.5 \text{ A}$
通电率 Duty factor 10% /15s

An OL25 remote version overspeed governor is equipped with 2 auto reset overspeed contact switches. Each switch has main electrical properties as following:

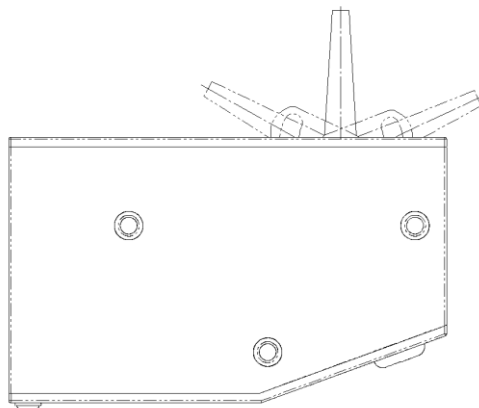

产品随时更新, 恕不另行通知!

Subject to change without notice!

限速器
OVERSPEED GOVERNOR
型号 OL25
TYPE OL25

页号/sheet TC.7003833.ZH.14
日期/date 24/06/2016
版本/version B-26/04/2017
审批/approved WAT/KKR

4.2.5 电气接线

Electric wiring

2 个自动复位超速触点开关需先串联, 然后接入电气安全回路中。

开关串联工作已由厂家完成, 用户仅需按照下图接线:

The 2 auto reset overspeed contact switches should be series-wound first and then connected to electrical safety circuit.

The series connection of switches is already finished at manufacturer. The client just needs to do wiring according below diagram:

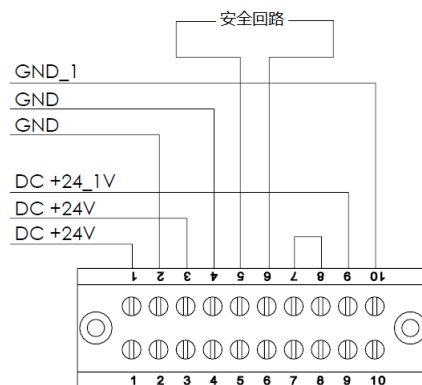
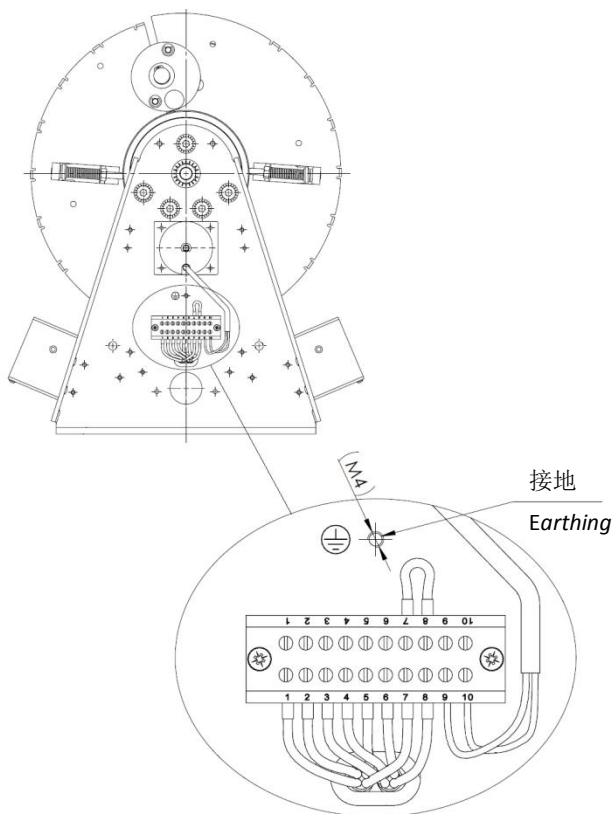

限速器
OVERSPEED GOVERNOR
型号 OL25
TYPE OL25

页号/sheet TC.7003833.ZH.15
日期/date 24/06/2016
版本/version B-26/04/2017
审批/approved WAT/KKR

5. 选项 Option

5.1 底座 Base

5.1.1 底座 1019103A01 Base 1019103A01

含安装材料

Fixing material included

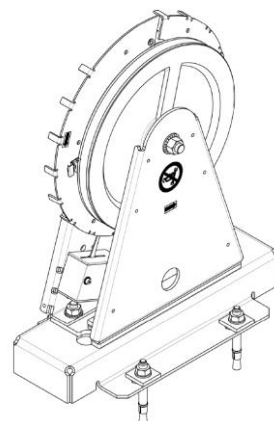
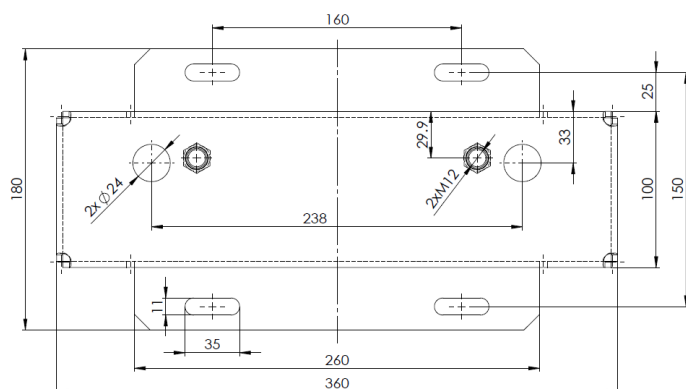
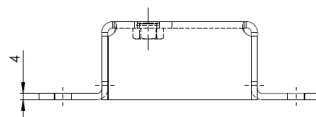
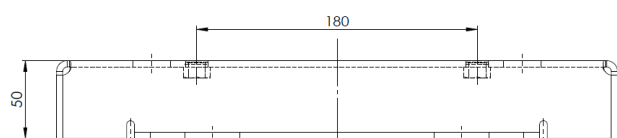

5.1.2 底座 1019103A02 Base 1019103A02

含安装材料

Fixing material included

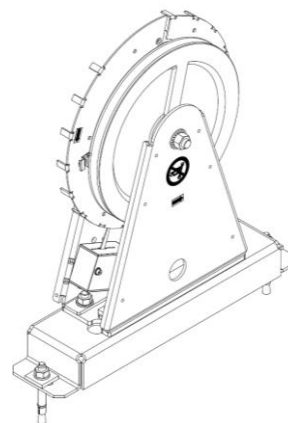
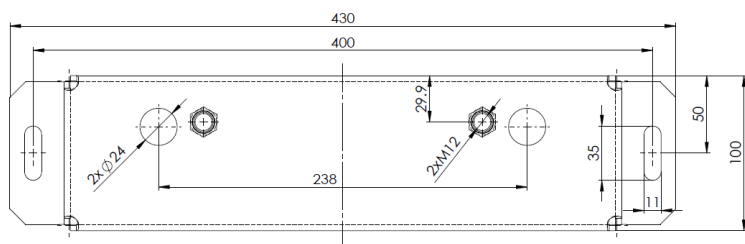
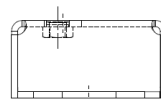
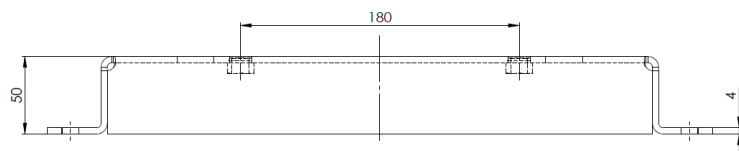

产品随时更新，恕不另行通知！

Subject to change without notice!



限速器
OVERSPEED GOVERNOR
型号 OL25
TYPE OL25

页号/sheet TC.7003833.ZH.16
日期/date 24/06/2016
版本/version B-26/04/2017
审批/approved WAT/KKR

5.2 张紧配重

Tension weight

5.2.1 悬臂式张紧配重

Swingarm tension weight

使用范围

- 该张紧配重符合 EN81 的要求（含松绳开关）。这些张紧配重配合 OL25 型限速器使用。
- 电梯最大速度 2.5m/s
- 最大提升高度 80m
- 钢丝绳直径 $d=6\text{mm}$ 或 8mm
- 钢丝绳节圆直径
D=239mm(8mm 钢丝绳)
D=237mm(6mm 钢丝绳)
- 适用导轨 T75, T82, T89/T90, T114, T125/T127 等相关类型
- 提供张紧拉力 350N
- 松绳开关 IP67
- 安装方向，有 2 种可选：
 - 左侧
 - 右侧
- 轿厢架或对重上的钢丝绳固定件符合尺寸 AK（钢丝绳中心-导轨中心）：160mm、220mm、250mm、350mm、415mm 可选。AK 具体调节范围见下表：

Range of use

- This tension weight meets the requirements of EN81 (slack rope switch included). These tension weights are performed for the use with overspeed governor OL25.
- Max elevator speed 2.5m/s
- Max travel height 80m
- rope diameter $d = 6/8\text{mm}$
- Rope pitch diameter
D=239mm (8mm rope)
D=237mm (6mm rope)
- applicable guide rails: T75 T82 T89/T90 T114 T125/T127 appropriate
- Provided tension force 350N
- Slack rope switch IP67
- Installation method, 2 options:
 - Left
 - Right
- Rope fixings on car frame or counterweight in accordance to dimension AK (distance rope center - guide rail): 160mm, 220mm, 250mm, 350mm, 415mm optional. The adjustable range of AK in below table:

导轨型号 Guide rail	AK 可调范围 Adjustable range of AK AK [mm]				
	AK=160	AK=220	AK=250	AK=350	AK=415
T75	148-172	208-232	235-265	335-365	400-430
T82	145-175	205-235	230-270	330-370	395-435
T89/T90	145-175	205-235	225-275	325-375	390-440
T114	x	x	235-265	335-365	400-430
T125/127	x	x	240-260	340-360	405-425

限速器
OVERSPEED GOVERNOR
型号 OL25
TYPE OL25

页号/sheet TC.7003833.ZH.17
日期/date 24/06/2016
版本/version B-26/04/2017
审批/approved WAT/KKR

5.2.1.1 悬臂式张紧重 AK=160/220

Swing arm tension weight AK=160/220

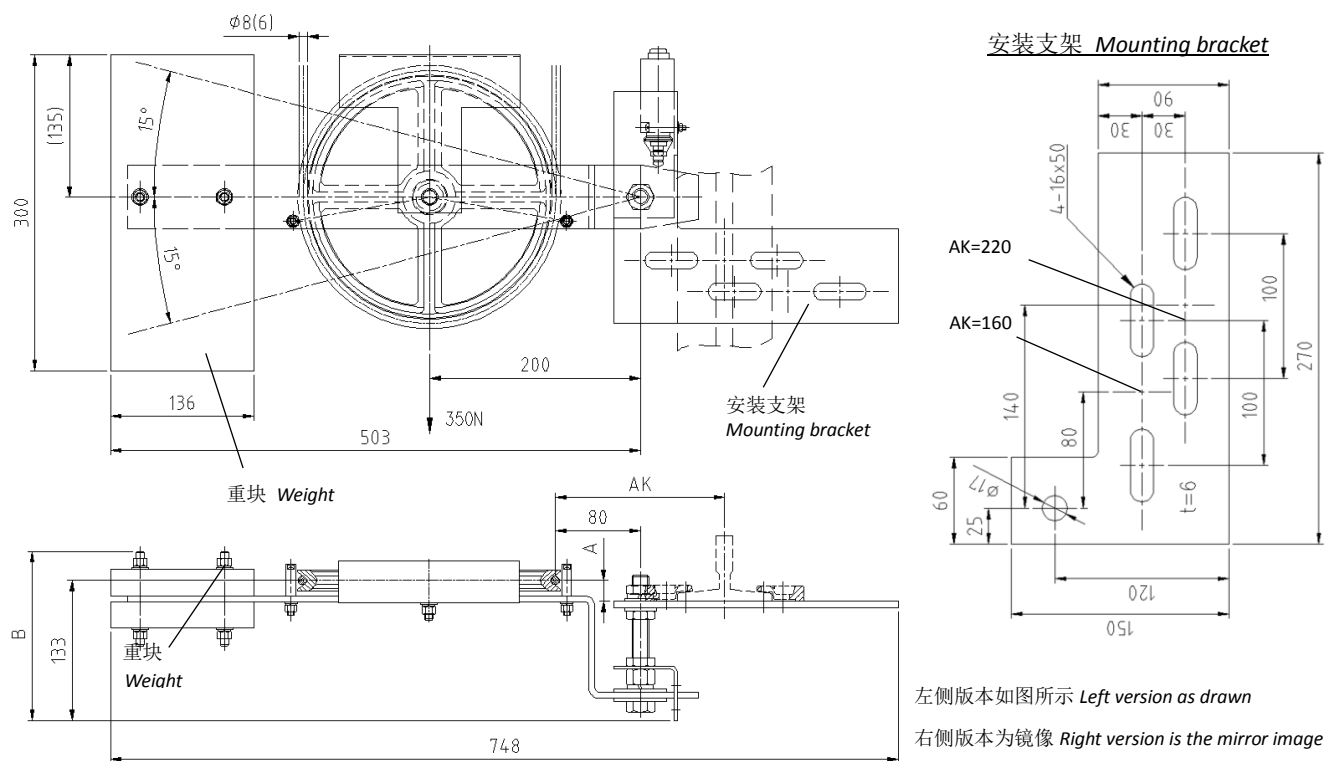

左侧版本如图所示 Left version as drawn

右侧版本为镜像 Right version is the mirror image

重块类型 Weight type	尺寸 Dimension B [mm]	安全规范 Safety code
铁 Iron	161	GB7588
复合材料 Composite	191	EN81

注：图示为符合 GB7588 的张紧重，符合 EN81 的张紧重与之相比仅安全罩壳不同。
Remark: The tension weight as shown is for GB7588, the EN81 one just has a different safety cover.

调节范围 Adjustable range A [mm]	张紧重 Tension force FT	提升高度 Travel height HT	额定速度 Rated speed NS	松绳开关 Slack rope switch	钢丝绳直径 Rope diameter d[mm]	绳轮直径 Pulley diameter DC [mm]	允许摆动角度 Allow rotation angle
20-55	350N	≤80m	≤2.5m/s	IP67	Φ6/Φ8	250	-/+15°

供货范围

- 工厂组装和调试好
- 不含与导轨固定的材料

Content of delivery

- Assembled and adjusted at the factory
- Excluding materials for fixing to guide rail

产品随时更新，恕不另行通知！

Subject to change without notice!

限速器
OVERSPEED GOVERNOR
型号 OL25
TYPE OL25

页号/sheet TC.7003833.ZH.18
日期/date 24/06/2016
版本/version B-26/04/2017
审批/approved WAT/KKR

5.2.1.2 悬臂式张紧重 AK=250/350/415

Swing arm tension weight AK=250/350/415

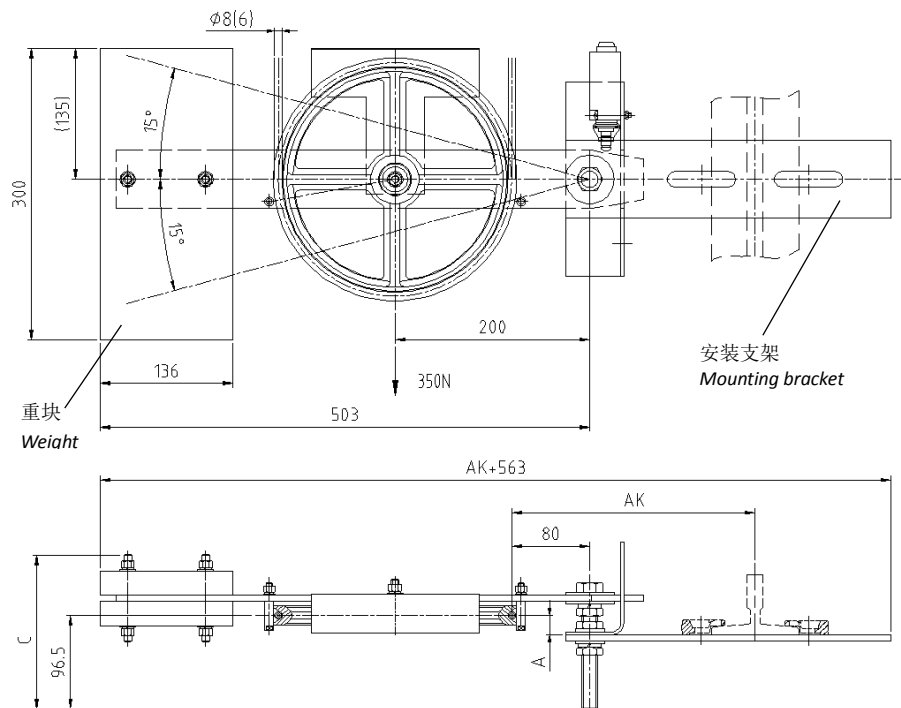

安装支架 Mounting bracket

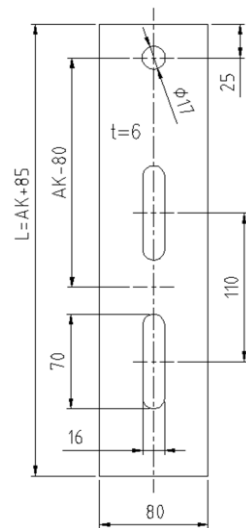

左侧版本如图所示 Left version as drawn

右侧版本为镜像 Right version is the mirror image

重块类型 Weight type	尺寸 Dimension C [mm]	安全规范 Safety code
铁 Iron	158	GB7588
复合材料 Composite	188	EN81

注：图示为符合 GB7588 的张紧重，符合 EN81 的张紧重与之相比仅安全罩壳不同。
Remark: The tension weight as shown is for GB7588, the EN81 one just has a different safety cover.

调节范围 Adjustable range A [mm]	张紧重 Tension force FT	提升高度 Travel height HT	额定速度 Rated speed NS	松绳开关 Slack rope switch	钢丝绳直径 Rope diameter d[mm]	绳轮直径 Pulley diameter DC [mm]	允许摆动角度 Allow rotation angle
20-55	350N	≤80m	≤2.5m/s	IP67	Φ6/Φ8	250	-/+15°

供货范围

- 工厂组装和调试好
- 不含与导轨固定的紧固材料

Content of delivery

- Assembled and adjusted at the factory
- Excluding materials for fixing to guide rail

产品随时更新，恕不另行通知！

Subject to change without notice!



限速器
OVERSPEED GOVERNOR
型号 OL25
TYPE OL25

页号/sheet TC.7003833.ZH.19
日期/date 24/06/2016
版本/version B-26/04/2017
审批/approved WAT/KKR

5.2.2 垂直式张紧配重

Vertical tension weight

使用范围

- 该张紧配重符合 EN81 的要求（含松绳开关）。这些张紧配重配合 OL25 型限速器使用。
- 电梯最大速度 2.5m/s
- 最大提升高度 150m
- 钢丝绳直径 $d=6\text{mm}$ 或 8mm
- 钢丝绳节圆直径 $D=239\text{mm}$ (8mm 钢丝绳)
 $D=237\text{mm}$ (6mm 钢丝绳)
- 适用导轨 T75, T82, T89/T90, T114, T125/T127 等相关类型
- 提供张紧拉力 550N
- 松绳开关 IP67
- 安装方法，有 2 种可选：
 - 固定于导轨
 - 固定于地坑
- 轿厢架或对重上的钢丝绳固定件符合尺寸 AK（钢丝绳中心-导轨中心）：160mm、220mm、250mm、350mm、415mm 可选。AK 具体调节范围见下表：

Range of use

- This tension weight meets the requirements of EN81 (slack rope switch included). These tension weights are performed for the use with overspeed governor OL25.
- Max elevator speed 2.5m/s
- Max travel height 150m
- rope diameter $d = 6/8\text{mm}$
- Rope pitch diameter $D=239\text{mm}$ (8mm rope)
 $D=237\text{mm}$ (6mm rope)
- applicable guide rails: T75 T82 T89/T90 T114 T125/T127 appropriate
- Provided tension force 550N
- Slack rope switch IP67
- Installation method, 2 options:
 - Fixing to guide rail
 - Fixing to pit floor
- Rope fixings on car frame or counterweight in accordance to dimension AK (distance rope center - guide rail): 160mm, 220mm, 250mm, 350mm, 415mm optional. The adjustable range of AK in below table:

导轨型号 Guide rail	AK 可调范围 Adjustable range of AK AK [mm]				
	AK=160	AK=220	AK=250	AK=350	AK=415
T75	146-175	205-235	235-265	335-365	400-430
T82	140-180	200-240	230-270	330-370	395-435
T89/T90	135-185	195-245	225-275	325-375	390-440
T114	x	x	235-265	335-365	400-430
T125/127	x	x	240-260	340-360	405-425

限速器
OVERSPEED GOVERNOR
型号 OL25
TYPE OL25

页号/sheet TC.7003833.ZH.20
日期/date 24/06/2016
版本/version B-26/04/2017
审批/approved WAT/KKR

5.2.2.1 安装方式 — 固定于导轨

Fixing method — fixing to guide rail

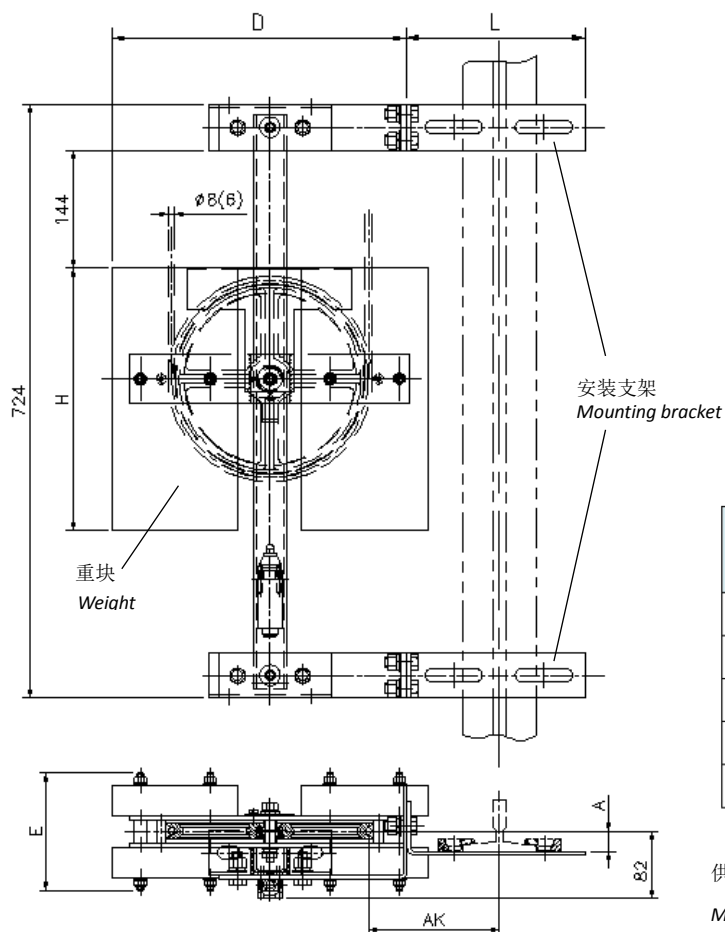

安装支架 Mounting bracket

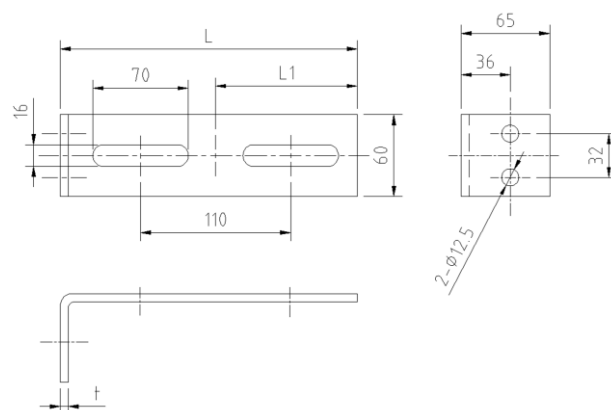

型号 Type	支架尺寸 Bracket dimensions		
	L [mm]	L1 [mm]	t [mm]
AK=160	218	104	6
AK=220	278		
AK=250	318	114	8
AK=350	418		
AK=415	483		

供货不含安装支架与导轨固定所需材料

Materials for fixing bracket to guide rail is not included in delivery content

重块类型 Weight type	AK 可选项 Options of AK	尺寸 Dimensions			安全规范 Safety code
		D [mm]	E [mm]	H [mm]	
铁 Iron	160/220/250/350/415	359	144	320	GB7588
复合材料 Composite	250/350/415	379	216	310	EN81

注：图示为符合 GB7588 的张紧重，符合 EN81 的张紧重与之相比仅安全罩壳不同。
Remark: The tension weight as shown is for GB7588, the EN81 one just has a different safety cover.

调节范围 Adjustable range A [mm]	张紧重 Tension force FT	提升高度 Travel height HT	额定速度 Rated speed NS	松绳开关 Slack rope switch	钢丝绳直径 Rope diameter d[mm]	绳轮直径 Pulley diameter DC [mm]
0-55	550N	≤150m	≤2.5m/s	IP67	Φ6/Φ8	250

产品随时更新，恕不另行通知！

Subject to change without notice!

限速器
OVERSPEED GOVERNOR
型号 OL25
TYPE OL25

页号/sheet TC.7003833.ZH.21
日期/date 24/06/2016
版本/version B-26/04/2017
审批/approved WAT/KKR

5.2.2.2 安装方式 — 固定于底坑

Fixing method — fixing to pit floor

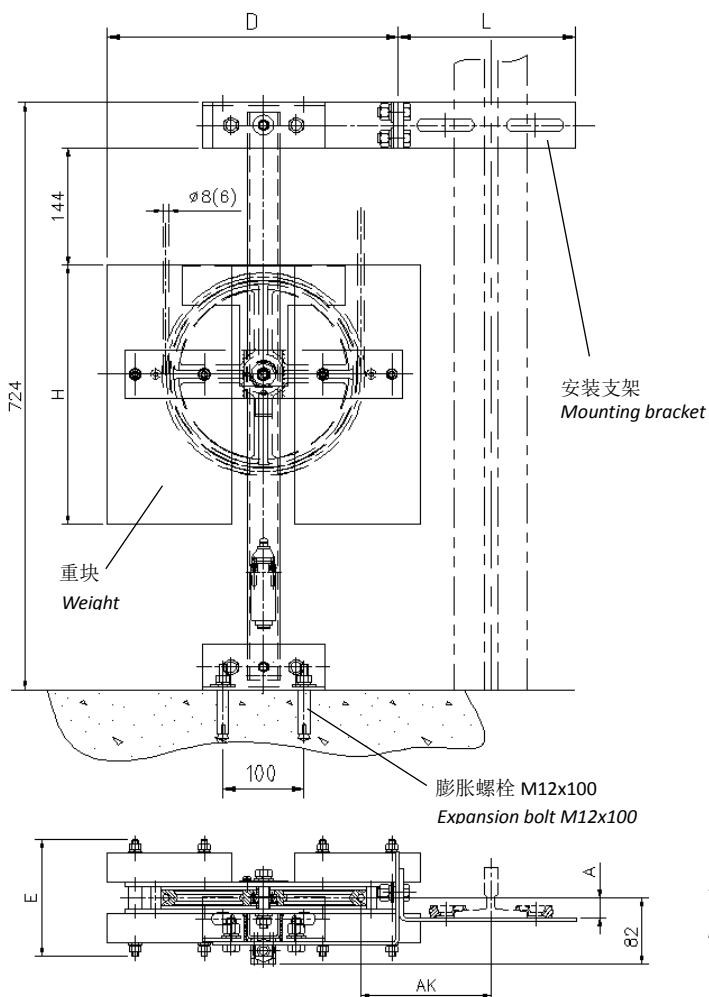

安装支架 Mounting bracket

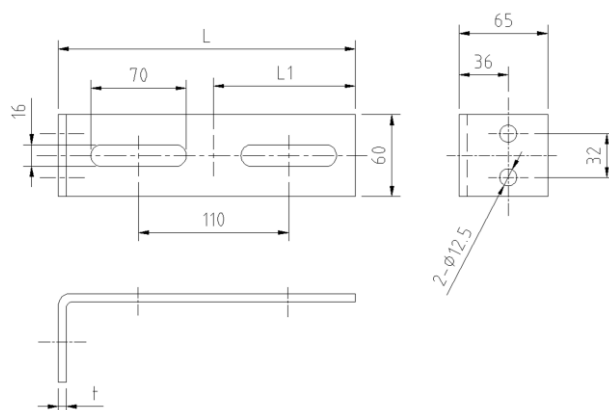

型号 Type	支架尺寸 Bracket dimensions		
	L [mm]	L1 [mm]	t [mm]
AK=160	218	104	6
AK=220	278		
AK=250	318	114	8
AK=350	418		
AK=415	483		

供货不含安装支架与导轨固定所需材料

Materials for fixing bracket to guide rail is not included in delivery content

重块类型 Weight type	AK 可选项 Options of AK	尺寸 Dimensions			安全规范 Safety code
		D [mm]	E [mm]	H [mm]	
铁 Iron	160/220/250/350/415	359	144	320	GB7588
复合材料 Composite	250/350/415	379	216	310	EN81

注：图示为符合 GB7588 的张紧重，符合 EN81 的张紧重与之相比仅安全罩壳不同。
Remark: The tension weight as shown is for GB7588, the EN81 one just has a different safety cover.

调节范围 Adjustable range	张紧重 Tension force	提升高度 Travel height	额定速度 Rated speed	松绳开关 Slack rope switch	钢丝绳直径 Rope diameter	绳轮直径 Pulley diameter
A [mm]	FT	HT	NS	switch	d[mm]	DC [mm]
0-55	550N	≤150m	≤2.5m/s	IP67	Φ6/Φ8	250

产品随时更新，恕不另行通知！

Subject to change without notice!



限速器
OVERSPEED GOVERNOR
型号 OL25
TYPE OL25

页号/sheet TC.7003833.ZH.22
日期/date 24/06/2016
版本/version B-26/04/2017
审批/approved WAT/KKR

6. 供应内容

Content of supply

带安全罩壳的 OL25 限速器，出厂前针对规定的速度预先调整（动作方向：右动作或左动作）。有两种配置可选：1）标准配置；2）远程配置。

*Overspeed governor OL25 with safety cover, pre adjusted in the factory for the defined nominal speed (Tripping direction: Tripping right or tripping left). There are 2 options:
1) Standard version; 2) Remote version.*

6.1 其他选配件

Additional equipment

- 底座
将限速器安装在机房内时，需要使用底座。
- 张紧配重
 - 悬臂式张紧配重
 - 垂直式张紧配重

- Base
A base is used to mount the OSG in machine room.
- Tension weight
 - Swingarm tension weight
 - Vertical tension weight

6.2 其他信息（按照 EN81 要求）

Additional information (acc. EN81)

1. 限速器的位置应便于检修和维护。
2. 如果将限速器安装在电梯井道中，必须从井道外易于接近检修。

1. The overspeed governor shall be accessible and reachable for inspection and maintenance.
2. If located in the well the overspeed governor shall be accessible and reachable from outside the well.

如满足以下条件，要求（2.）则不适用：

The requirement (2.) does not apply if following conditions are fulfilled:

- 限速器的动作受电梯井道外的远程控制器（无绳除外）影响，因此不影响非自主动作且未经授权者无法接近启动装置，且
- 检修或维护时便于从轿厢顶或底坑接近限速器检修且
- 当轿厢/对重上行移动时，限速器在自动动作后复位。

- *The tripping of the overspeed governor is effected by means of a remote control, except cableless, from outside the well whereby an involuntary tripping is not effected and the actuation device is not accessible to unauthorized persons, and*
- *The overspeed governor is accessible for inspection and maintenance from the car roof or pit, and*
- *The overspeed governor returns automatically into the position after tripping, as the car/counterweight is moved in the upward direction.*

但是，电气部件可以通过井道外的远程控制器返回正常位置，它不会影响限速器的正常功能。

However the electrical parts may return into the normal position by remote control from the outside of the well which shall not influence the normal function of the overspeed governor.



限速器
OVERSPEED GOVERNOR
型号 OL25
TYPE OL25

页号/sheet TC.7003833.ZH.23
日期/date 24/06/2016
版本/version B-26/04/2017
审批/approved WAT/KKR

7. 版本变更表

Revision table

版本 Revision	日期 Date	变更描述 Description of change	变更编号 CR No.
B	26/04/2017	增加订单页张紧装置选型注意事项 <i>add tension weight selection notes in order form</i>	ECR-0002745
A	16/01/2017	根据 EN 81-20 更新相关内容 <i>update relevant information according to EN 81-20</i>	ECR-0002641
	16/01/2017	修正错误并更新表格 <i>correct errors and update tables</i>	



限速器
OVERSPEED GOVERNOR
型号 OL25
TYPE OL25

页号/sheet TC.7003833.ZH.24
日期/date 24/06/2016
版本/version B-26/04/2017
审批/approved WAT/KKR

☐ 订购/ORDER ☐ 询价/INQUIRY 日期/DATE _____
公司/COMPANY _____
地址/ADDRESS _____
经手人/HANDLED BY _____
☎ _____ 传真/FAX _____
电子邮箱/E-MAIL _____
开票地址/INVOICING ADDRESS _____
交货地址/DELIVERY ADDRESS _____

威特电梯部件（苏州）有限公司
Wittur Elevator Components (Suzhou) Co., Ltd.
江苏省吴江汾湖经济开发区厍星路 18 号,215214
18 Shexing Road, FoHo Economic Development Zone, Wujiang,
Jiangsu, China, 215214
传真/FAX: +86-512-63220044
交货条件/TERMS OF DELIVERY _____
交货日期/ DELIVERY DATE _____
订单号/ ORDER NUMBER _____
电梯号/ELEVATOR NUMBER _____

产品代码/ Produce code	OL25	数量/ Quantity	_____
版本/Version	<input type="checkbox"/> 标准/Standard	<input type="checkbox"/> 远程/Remote	
应用/Apply	<input type="checkbox"/> 轿厢侧/Car	<input type="checkbox"/> 对重/ Counterweight	
额定速度/Nominal speed	<input type="checkbox"/> 1.0 m/s	<input type="checkbox"/> 1.5 m/s	<input type="checkbox"/> 1.75 m/s <input type="checkbox"/> 2.0 m/s <input type="checkbox"/> 2.5m/s
动作方向/Tripping direction	<input type="checkbox"/> 左/Left	<input type="checkbox"/> 右/Right	
钢丝绳直径/Rope diameter	<input type="checkbox"/> 6mm	<input type="checkbox"/> 8mm	
技术标准/Technical survey	<input type="checkbox"/> GB 7588	<input type="checkbox"/> EN 81-1	<input type="checkbox"/> EN 81-20

单价/Unit Price

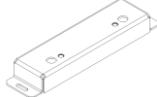
底座/ Base (选配 Optional)	<input type="checkbox"/> 是/Yes	<input type="checkbox"/> 否/No
<input type="checkbox"/> 1019103A01 	<input type="checkbox"/> 1019103A02 	

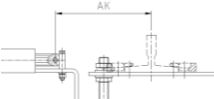
悬臂式张紧配重/ Swing arm tension weight (选配 Optional)	<input type="checkbox"/> 是/Yes	<input type="checkbox"/> 否/No
请参阅技术目录 TC.7003833.ZH 第 5 页表格及 5.2.1 节内容后进行选择/Please refer the table on page 5 and section 5.2.1 of technical catalogue TC.7003833.ZH to make this selection		
版本/Version	<input type="checkbox"/> 左/Left	<input type="checkbox"/> 右/Right
		
重块类型/Type of weight	<input type="checkbox"/> 铁/Iron	<input type="checkbox"/> 复合材料/Composite
导轨型号	<input type="checkbox"/> T75 <input type="checkbox"/> T82	<input type="checkbox"/> T89 <input type="checkbox"/> T90 <input type="checkbox"/> T114
Type of guide rail	<input type="checkbox"/> T125 <input type="checkbox"/> T127	
钢丝绳位置 AK [mm]		<input type="checkbox"/> AK=160 <input type="checkbox"/> AK=220 <input type="checkbox"/> AK=250
Rope position AK [mm]		<input type="checkbox"/> AK=350 <input type="checkbox"/> AK=415
安全标准/Safety code	<input type="checkbox"/> GB 7588	<input type="checkbox"/> EN 81

产品随时更新，恕不另行通知！

Subject to change without notice!



限速器
OVERSPEED GOVERNOR
型号 OL25
TYPE OL25

页号/sheet TC.7003833.ZH.25
日期/date 24/06/2016
版本/version B-26/04/2017
审批/approved WAT/KKR

☐ 订购/ORDER ☐ 询价/INQUIRY 日期/DATE _____
公司/COMPANY _____
地址/ADDRESS _____
经手人/HANDLED BY _____
☎ _____ 传真/FAX _____
电子邮箱/E-MAIL _____
开票地址/INVOICING ADDRESS _____
交货地址/DELIVERY ADDRESS _____

威特电梯部件（苏州）有限公司
Wittur Elevator Components (Suzhou) Co., Ltd.
江苏省吴江汾湖经济开发区库星路 18 号,215214
18 Shexing Road, FoHo Economic Development Zone, Wujiang,
Jiangsu, China, 215214
传真/FAX: +86-512-63220044

交货条件/TERMS OF DELIVERY _____
交货日期/ DELIVERY DATE _____
订单号/ ORDER NUMBER _____
电梯号/ELEVATOR NUMBER _____

垂直式张紧配重/ Vertical tension weight (选配 Optional)

☐ 是/Yes ☐ 否/No

请参阅技术目录 TC.7003833.ZH 第 5 页表格及 5.2.2 节内容后进行选择/Please refer the table on page 5 and section 5.2.2 of technical catalogue TC.7003833.ZH to make this selection

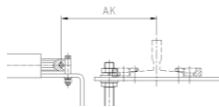
固定方法/Fixing method	<input type="checkbox"/> 导轨/Guide rail	<input type="checkbox"/> 底坑/Pit floor
重块类型/Type of weight	<input type="checkbox"/> 铁/Iron	<input type="checkbox"/> 复合材料/Composite
导轨型号	<input type="checkbox"/> T75 <input type="checkbox"/> T82 <input type="checkbox"/> T89 <input type="checkbox"/> T90 <input type="checkbox"/> T114	
Type of guide rail	<input type="checkbox"/> T125 <input type="checkbox"/> T127	
钢丝绳位置 AK [mm]		<input type="checkbox"/> AK=160 <input type="checkbox"/> AK=220 <input type="checkbox"/> AK=250
Rope position AK [mm]		<input type="checkbox"/> AK=350 <input type="checkbox"/> AK=415
安全标准/Safety code	<input type="checkbox"/> GB 7588	<input type="checkbox"/> EN 81

包装/ Packing ☐ 标准（纸板箱）/Standard (Cardboard)
☐ 出口包装（纸箱+夹板箱）/Export package (Cardboard + Plywood)

其他非标要求/ Other requirements _____

单价/Unit Price

总价/Total