

INSTALLATION MANUAL



ECO BUS 2.0

Code	AM.2.003535.EN
Version	G
Date	15.05.2021

AUTOMATIC FOLDING DOOR



No part of this publication may be reproduced or translated, even in part, without prior written permission from WITTUR.

Subject to change without notice!

info@wittur.com
www.wittur.com

© Copyright WITTUR 2021

safety in **motion**TM



G	Updated Page 22	15/05/21
F	Updated pages 6, 7, 18	19/03/19
MOD.	DESIGNATION	DATE

INDEX

1. General

1.1 Symbols used.....	6
1.2 Safety Requirements	6
1.3 Warnings.....	7
1.4 Suggestions	7
1.5 Tools	8

2. Installation

2.1 Installation sill	9
2.2 Installation operator	10
2.3 Mounting panels	11
2.4 Installation ramp	14
2.5 Adjustment ramp rope.....	16
2.6 Adjustment car door lock & emergency opening device.....	18
2.7 Installation curtain of light	19
2.8 DIP Switch for ECO BUS 2.0 Doors	20
2.9 Troubleshooting.....	21
2.9.1 Door is not completely flat	21
2.9.2 Gap between door panels	22

1. General

FOREWORD

*Congratulations on choosing a **WITTUR** product!*

Before starting the installation of this product, read the information contained in this document.

*You will find important warnings on how to assemble and maintain your **WITTUR** product in good operating conditions and to get the maximum of your investment.*

You will also find important information concerning the product care and maintenance which are an important factor to ensure safety at all times.

***WITTUR** has long been involved in research aimed at reducing noise level and in design that takes into due consideration the product quality and the conservation of environment.*



This document is an integral part of the supply and must be available in the lift power room at all times. All products are provided with identification type label and in case with certification marks in accordance with the current rules.

In case of need concerning the product, the identification data on the label must be always communicated to us.

*We hope you will get full satisfaction from this **WITTUR** product. Yours faithfully.*

WITTUR

1.1 Symbols used

The points that are important under the safety viewpoint and danger warnings are indicated with these symbols:



Danger general



Important warnings



Risk of personal injury (e.g. sharp edges, protruding parts)



Risk of damage to mechanical parts (e.g. incorrect installation)



Live parts

1.2 Safety Requirements

All persons involved must know and follows all company and local safety regulations, with special attention to the following:

- *Make sure that there is enough light to work safely.*
- *Immediately replace damaged or lost safety equipment.*
- *Keep all tools in good condition.*
- *Follow instructions when using tools.*

In addition to protective clothing, the following safety equipment must be used:



Safety Shoes



Hardhat



Safety Goggles



Full Body Safety Harness



Protective Gloves

1.3 Warnings

- **WITTUR** will not be held liable for any damage caused by tampering of the packing material by thirds.
- Before starting assembly, check that the product received corresponds to the order and to the packing list and that no damage has occurred in transit.
- Within its policy of continual research, **WITTUR** reserves to make changes to its products without notice. The figures, descriptions and data contained in this manual are intended as purely indicative and not binding.



- To ensure the safety of the product, avoid any alteration or tampering.
- **WITTUR** liability will be limited to the original components only.
- **WITTUR** product is intended for use in the lift sector only, therefore **WITTUR** liability shall be limited to such use.
- This product is intended for professional use. Any improper use, including for hobby or DIY, is prohibited.



- In order to prevent any injury to persons and damage to property, the handling, installation, adjustment and maintenance must be carried out by suitably trained personnel, using appropriate clothing and equipment.
- Any masonry work connected with the correct installation of the product must be executed in a workmanlike manner according to the applicable laws.
- The connection of the electric/electronic units to the local power supply must be executed in a workmanlike manner according to the applicable laws.
- All metal parts supporting the electric/electronic units must be connected to an earth system in a workmanlike manner according to the applicable laws.



- Before connecting the product to the power supply check that the product's requirement corresponds with the power supply available.
- Before starting any work on the electric/electronic components disconnect power from the system.
- **WITTUR** shall have no responsibility on the execution of masonry works or the connection of electric/electronic components to the power supply.



- **WITTUR** shall not be liable for damages/injury to property/persons caused by improper use of the emergency opening devices.

1.4 Suggestions

- Keep the material in the original packing, protected from bad weather and direct exposure to sun during the storage period in order to avoid the accumulation of water/condensation inside the packing material.
- Never dispose of packing material in the environment.
- Once dismantled, the product should be conveniently disposed as provided for by the local laws; never dispose of in the environment.
- Whenever possible, re-cycling is preferable to disposal in dump sites.
- Before re-cycling check the nature of the various materials and re-cycle in the appropriate way.

1.5 Tools

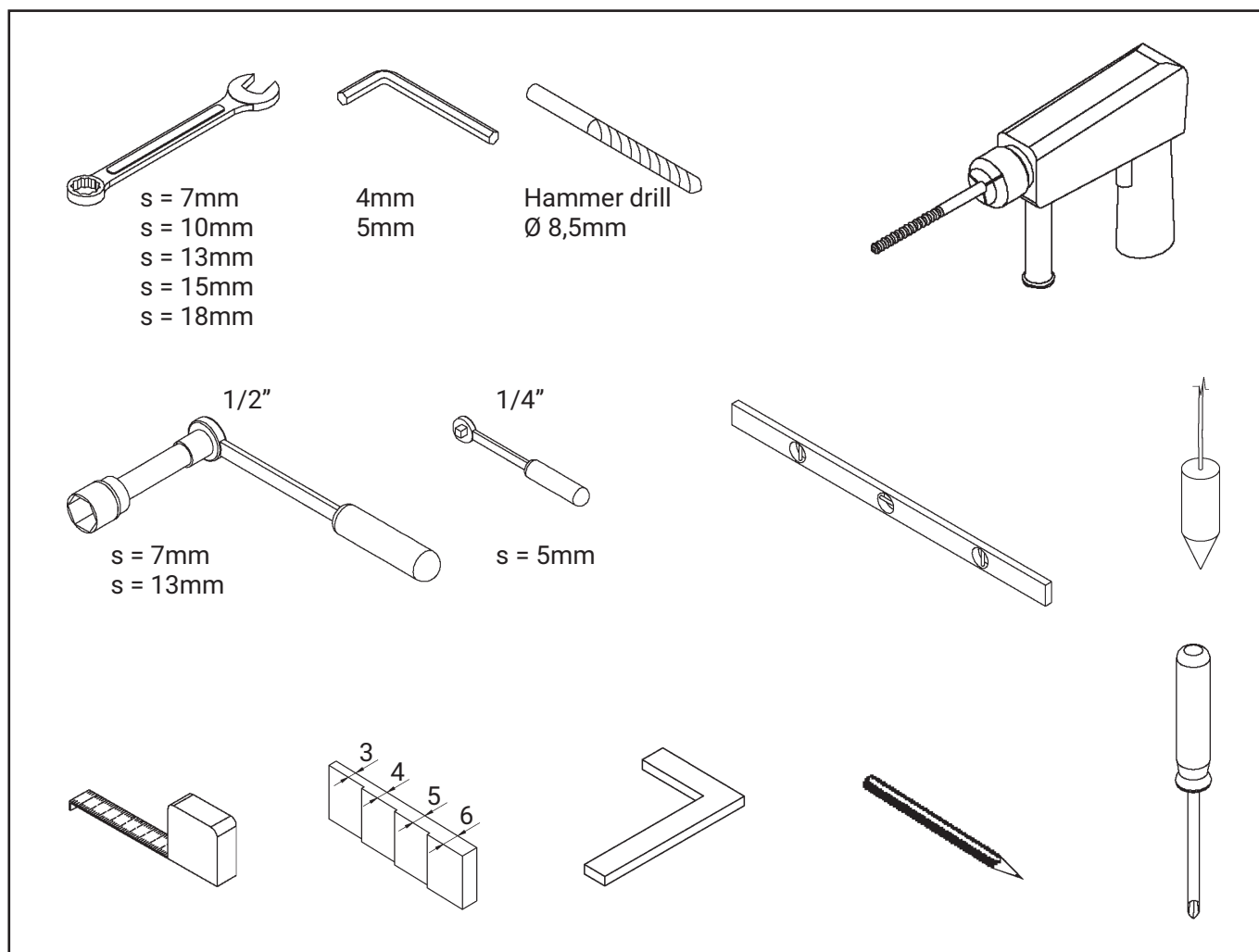

	Min (Nm)	Max (Nm)
M3	0,9	1,1
M4	2,1	2,6
M5	4,1	5,1
M6	7,0	9,0
M8	17,0	21,0
M10	34,0	42,0
M12	57,1	71,4

2. Installation

2.1 Installation sill

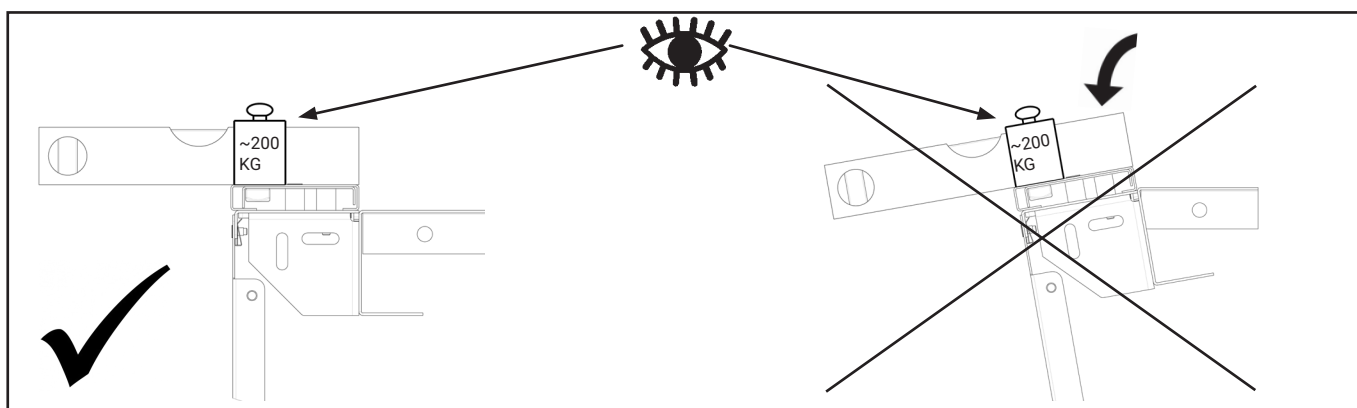
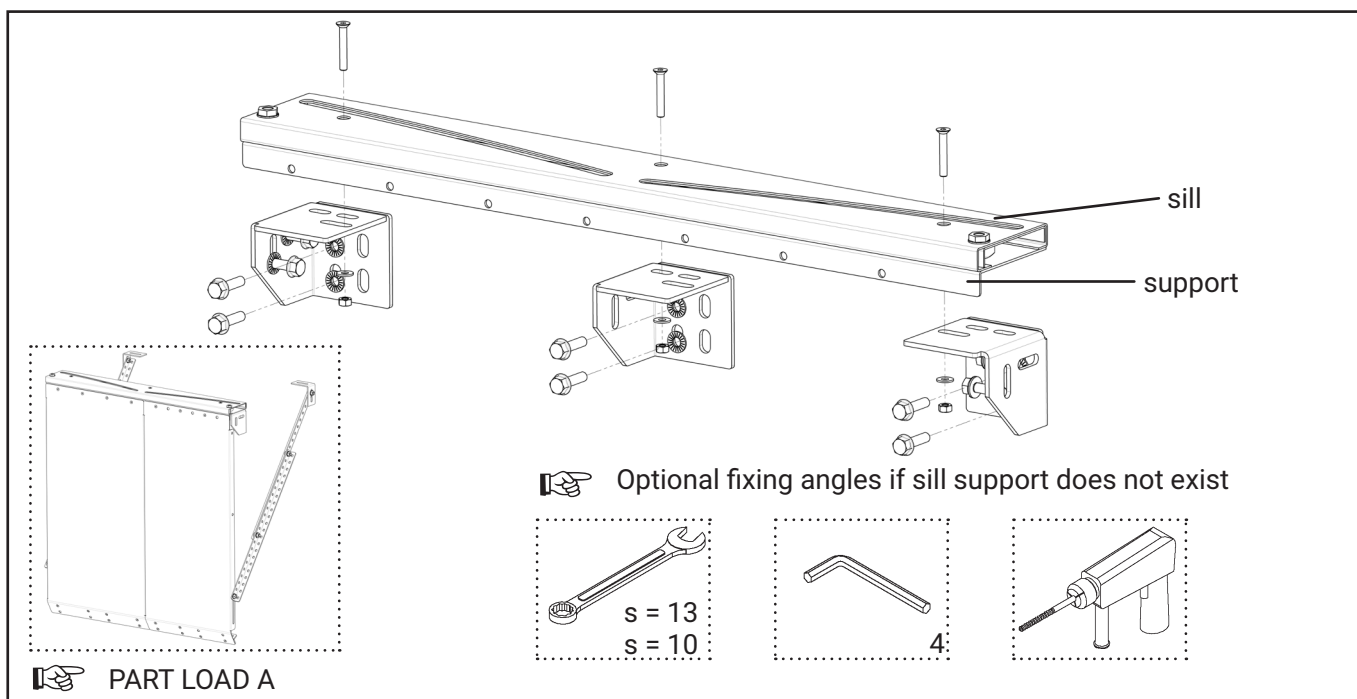
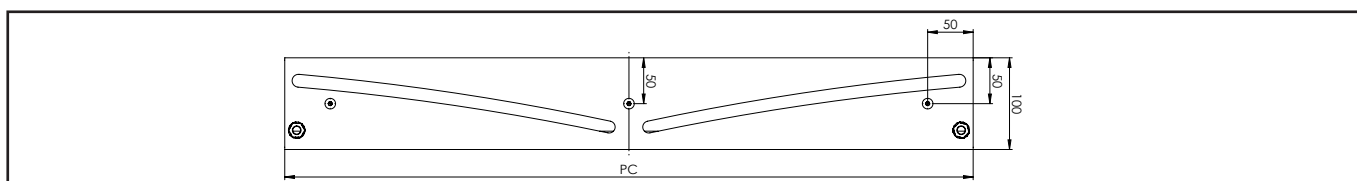

2.2 Installation operator

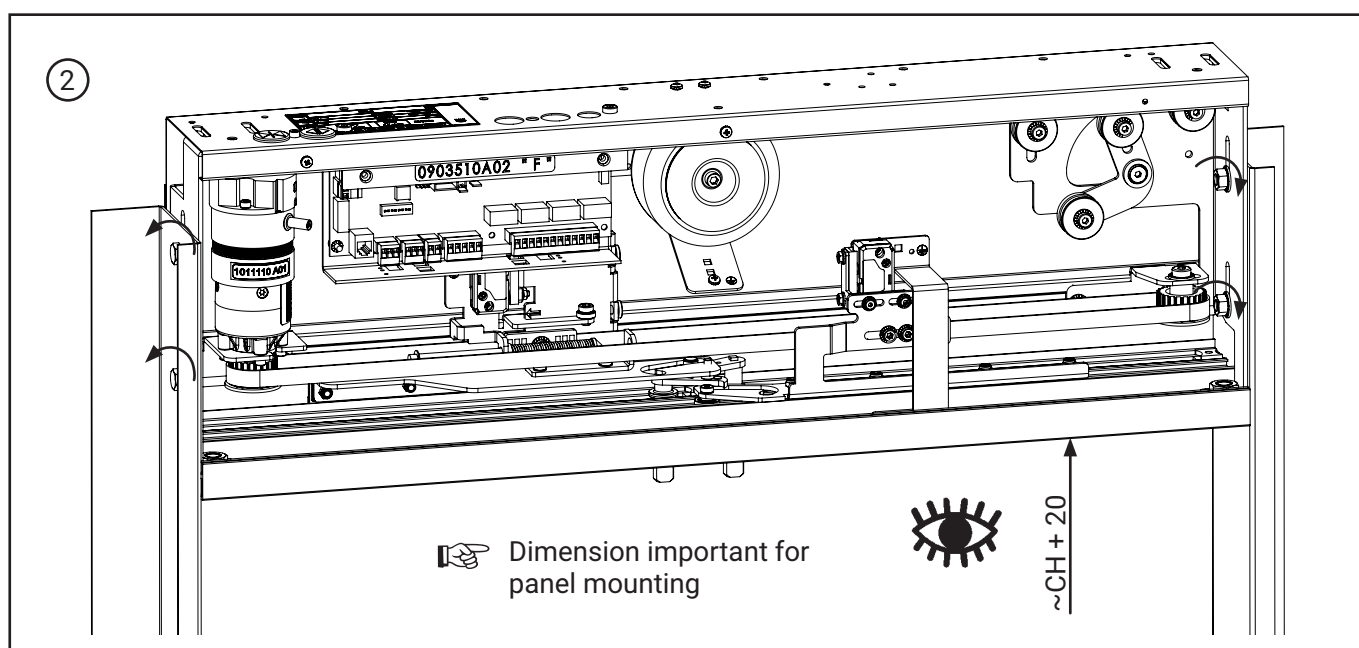
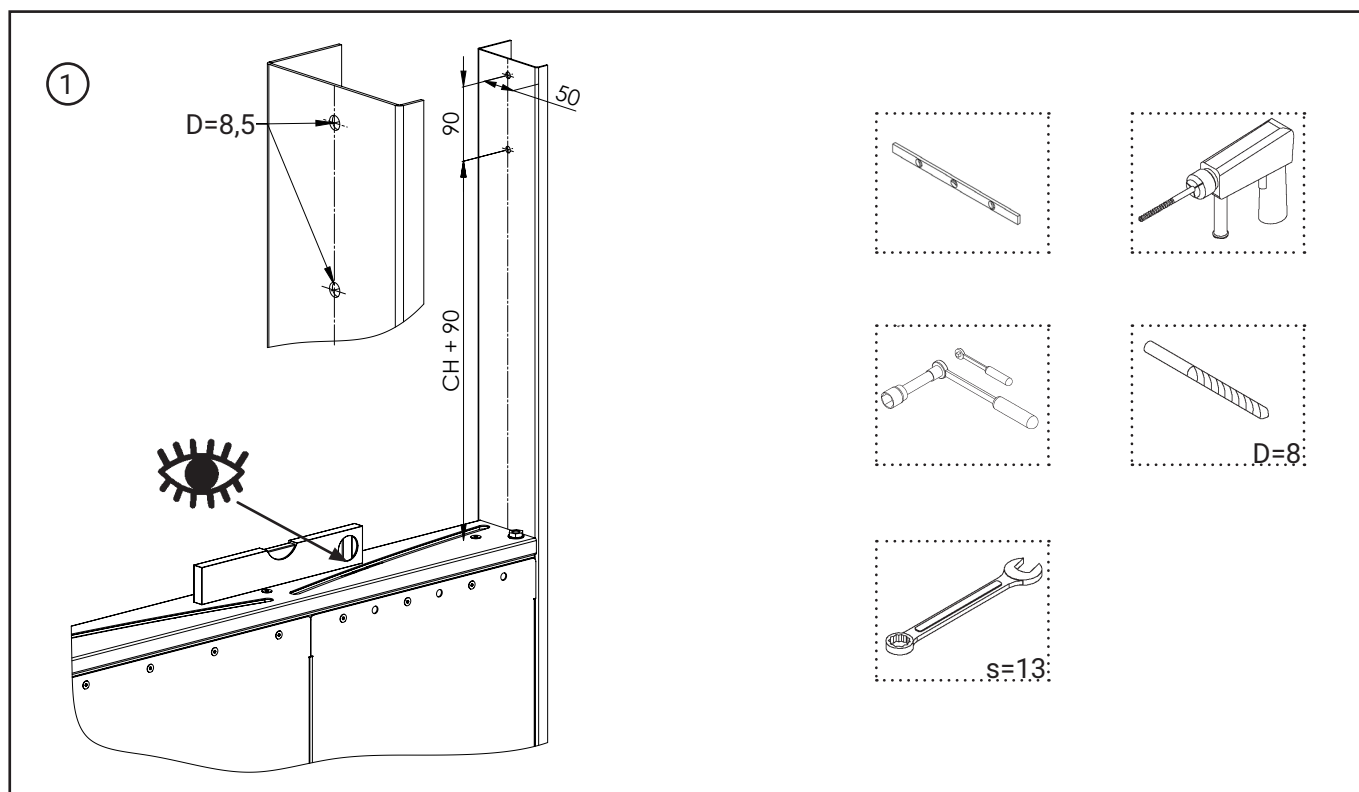

2.3 Mounting panels

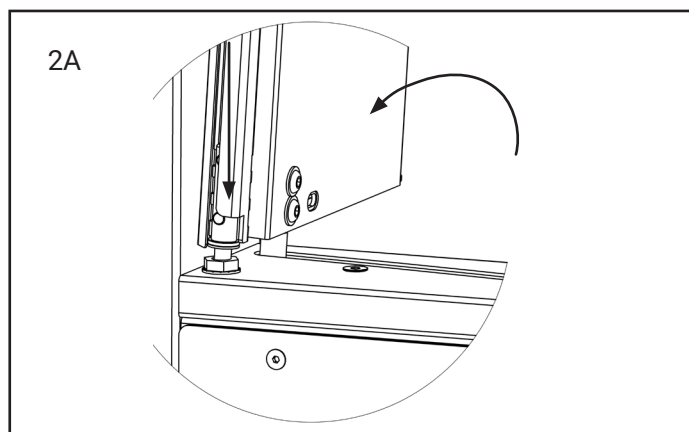
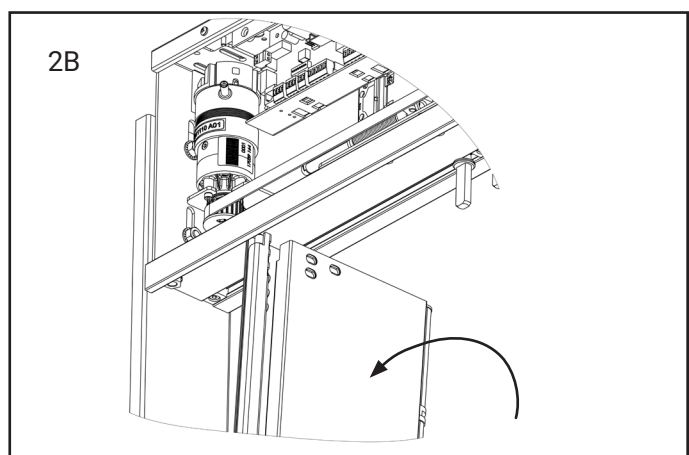
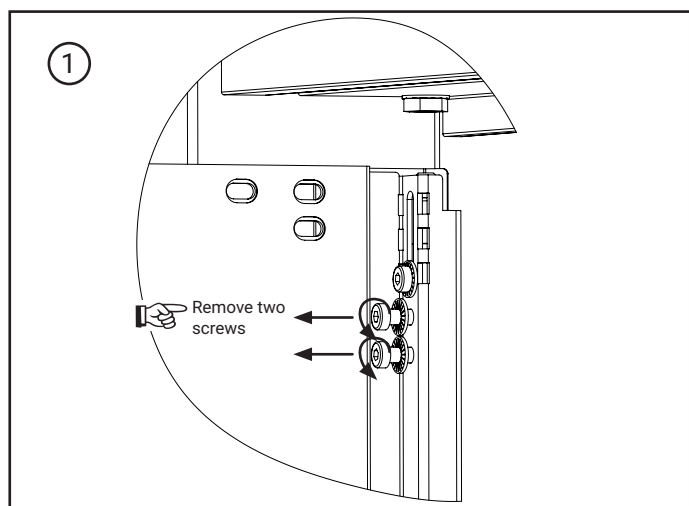

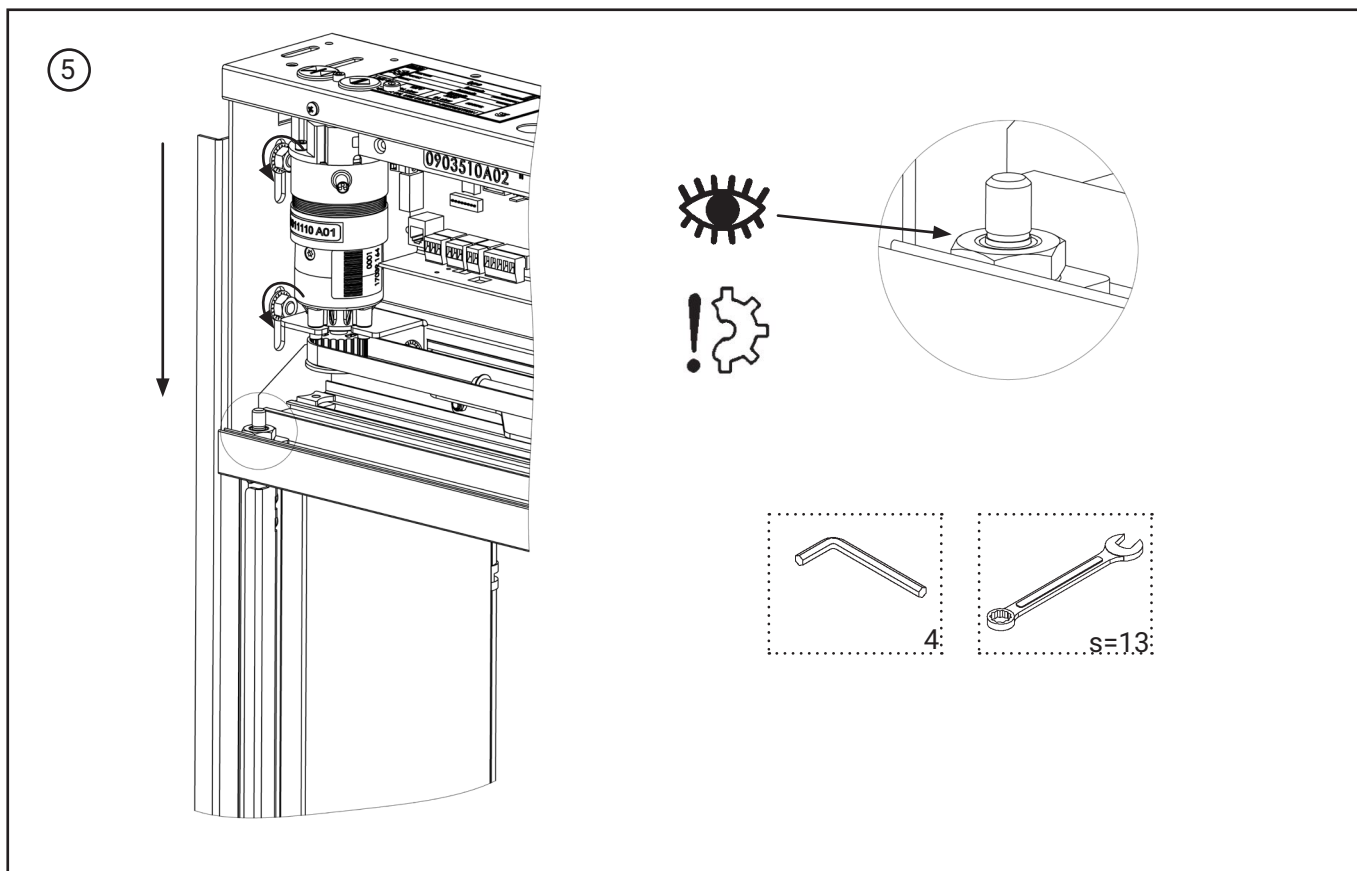
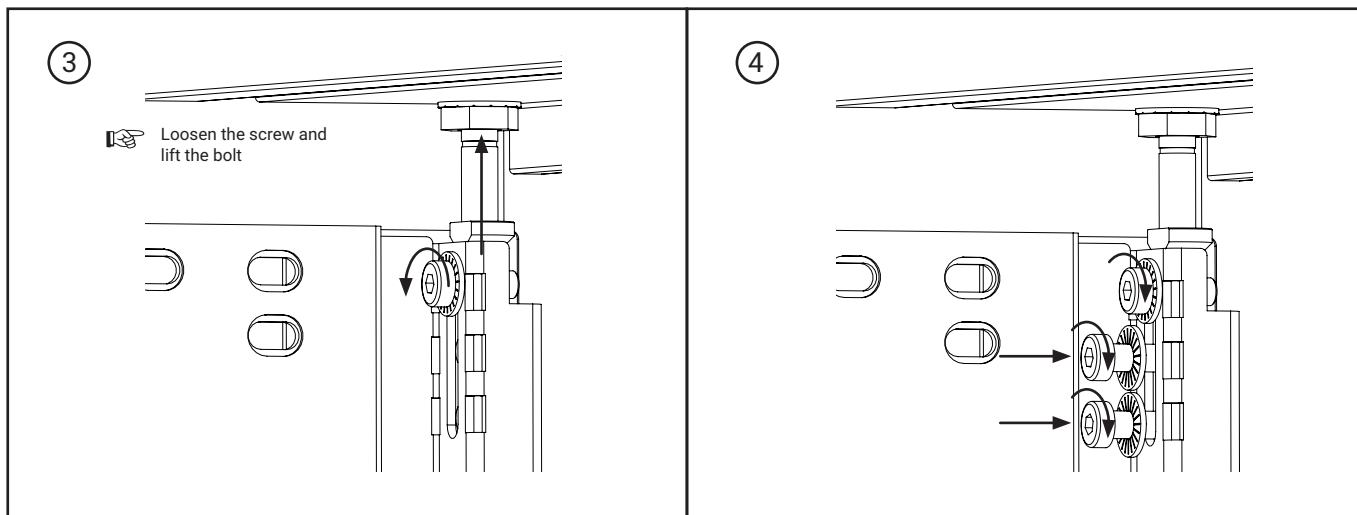

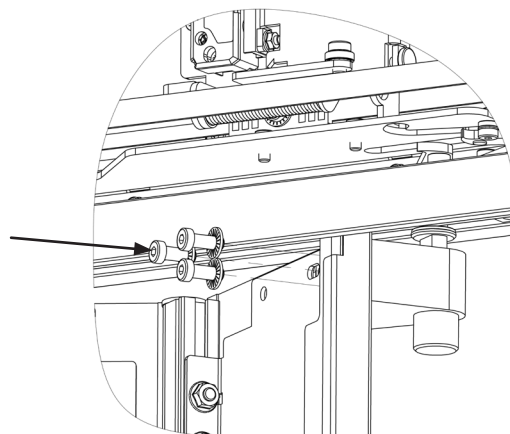
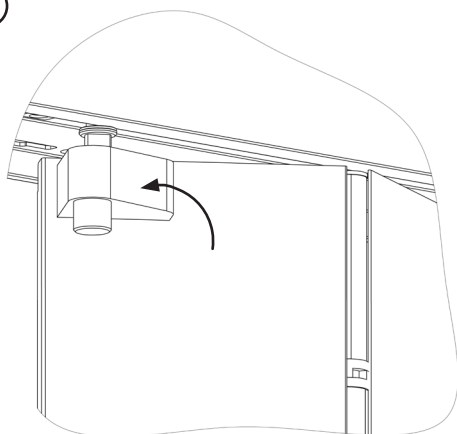

⑥

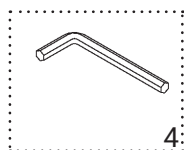

 PART LOAD B



2.4 Installation ramp

 First assemble the ramp

① J

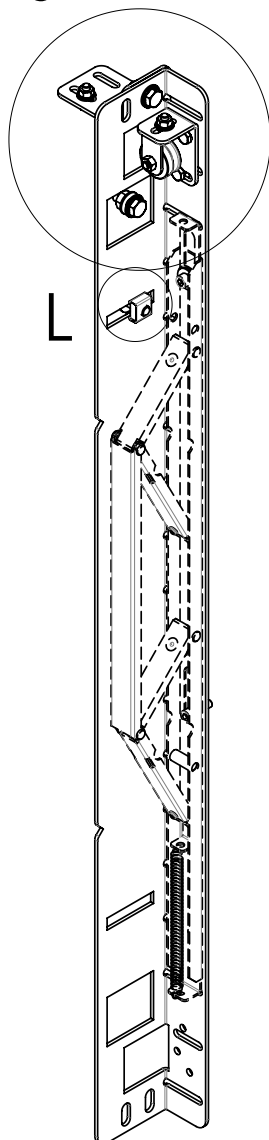

K

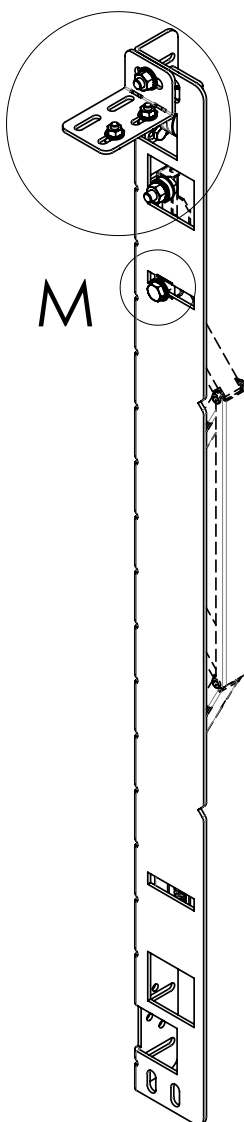

M

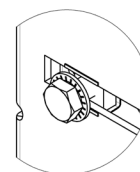
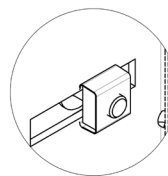
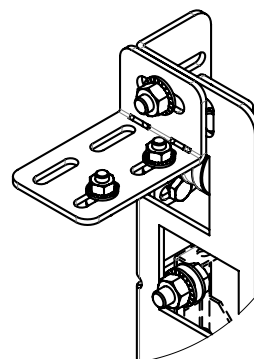
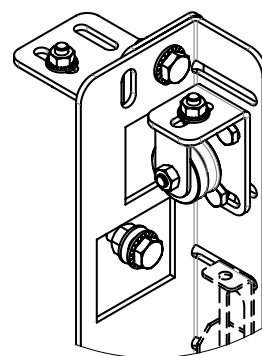

 PART LOAD C

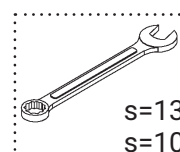

PARALLEL

(Ramp mounted on left side / plastic roller not illustrated)

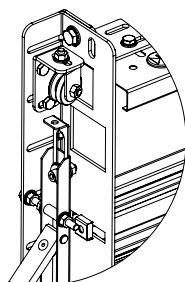
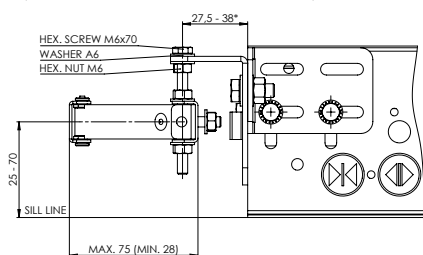

PERPENDICULAR

(Ramp mounted on left side / plastic roller not illustrated)

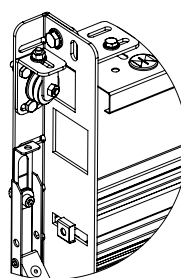
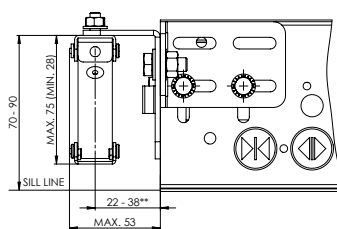

* standard	27.5 - 38
small shaft	27.5
** standard	22 - 38
small shaft	22 - 28

②

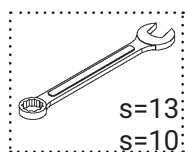
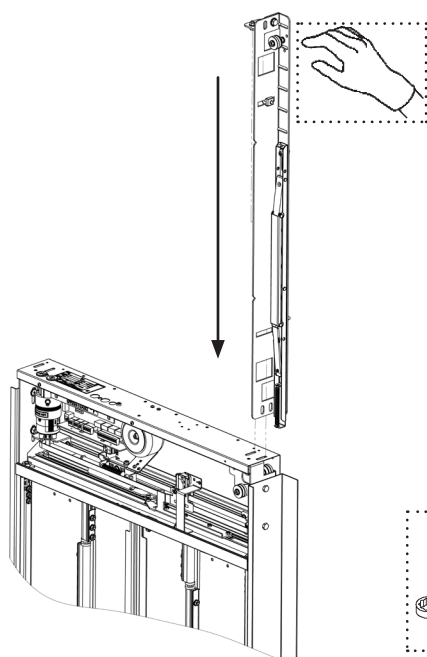

③

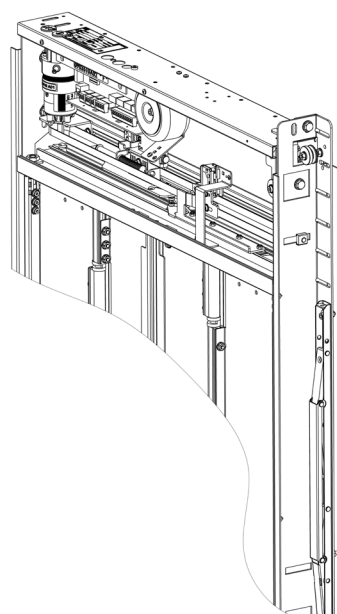

2.5 Adjustment ramp rope

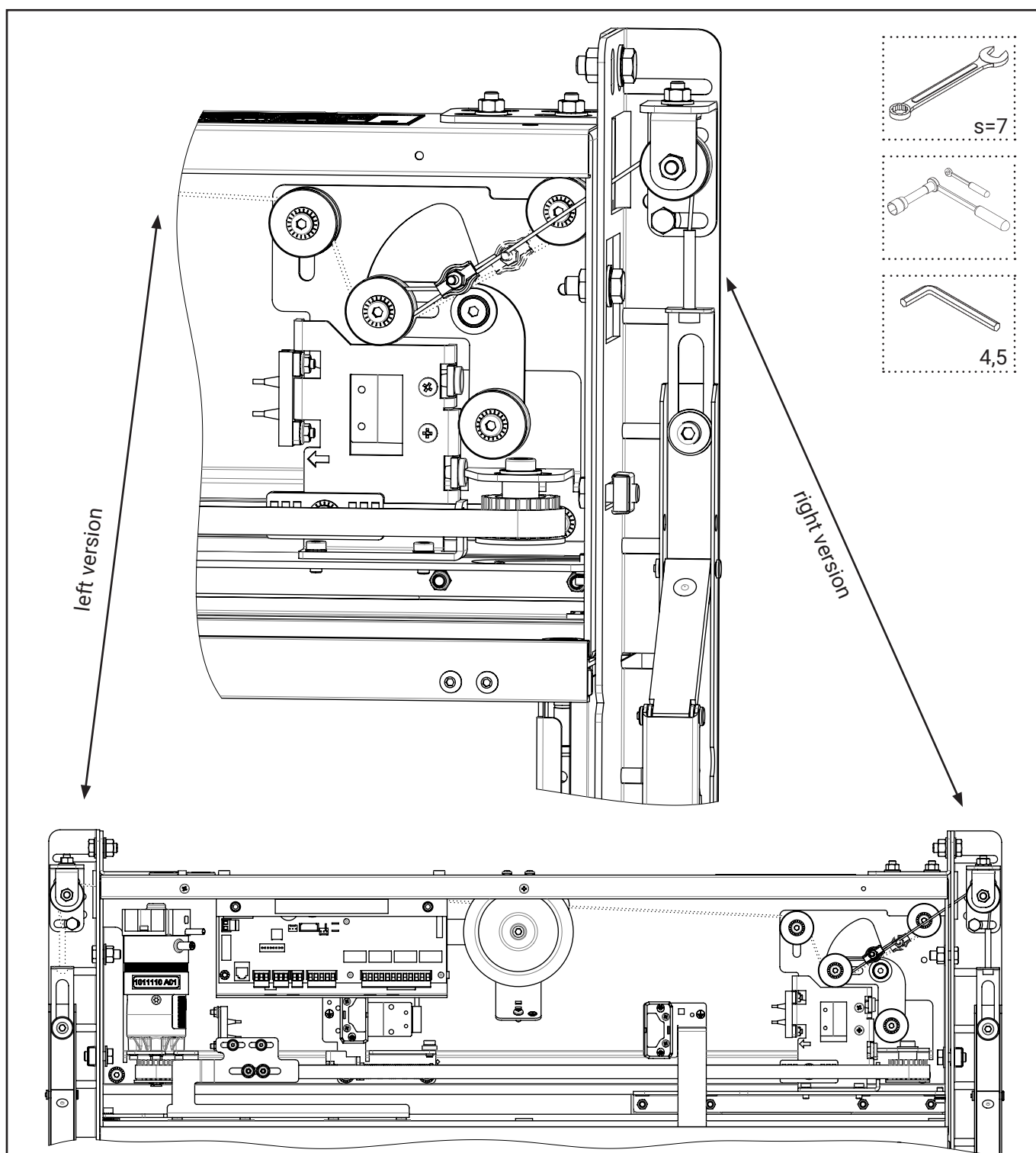

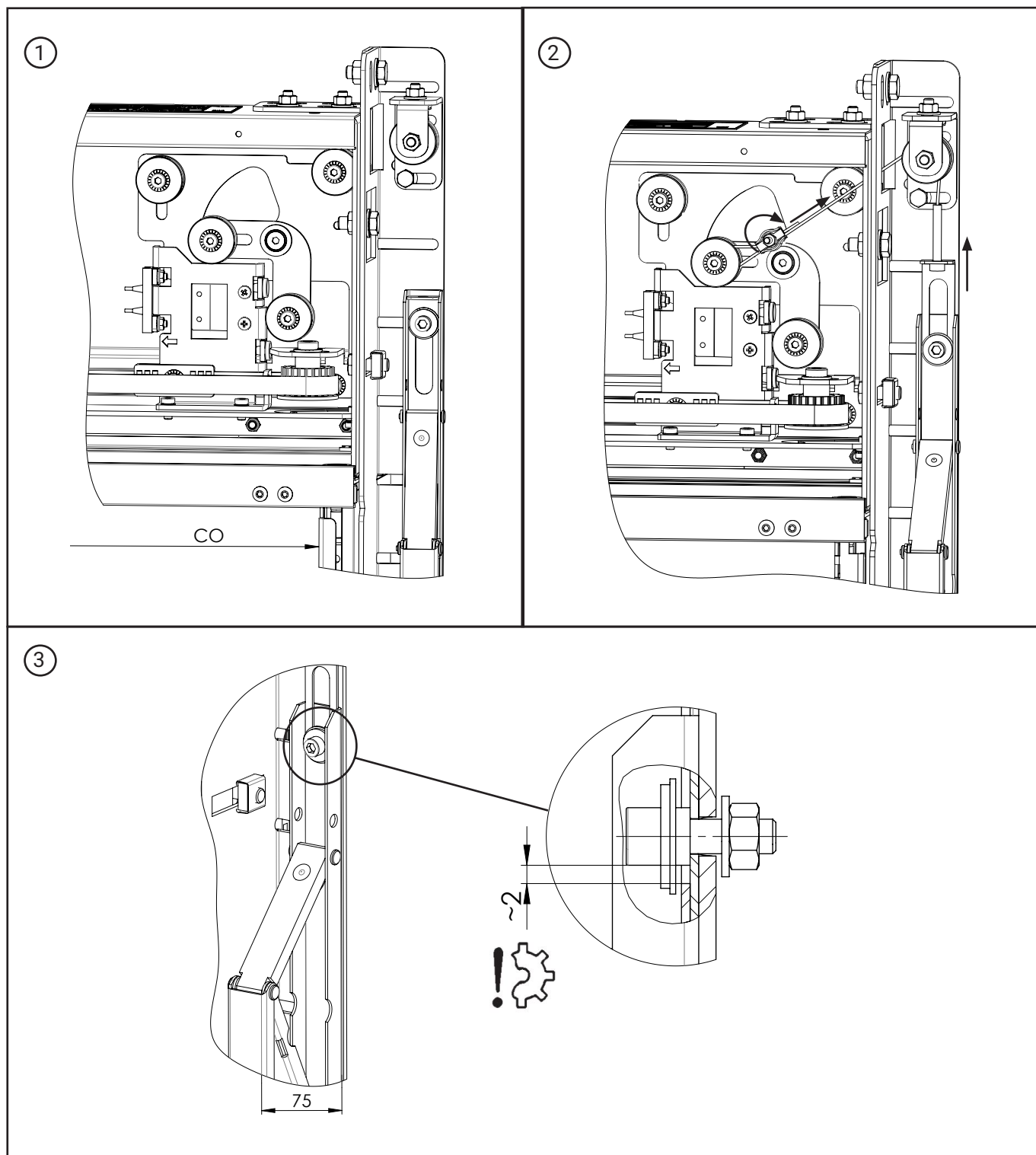

2.6 Adjustment car door lock & emergency opening device

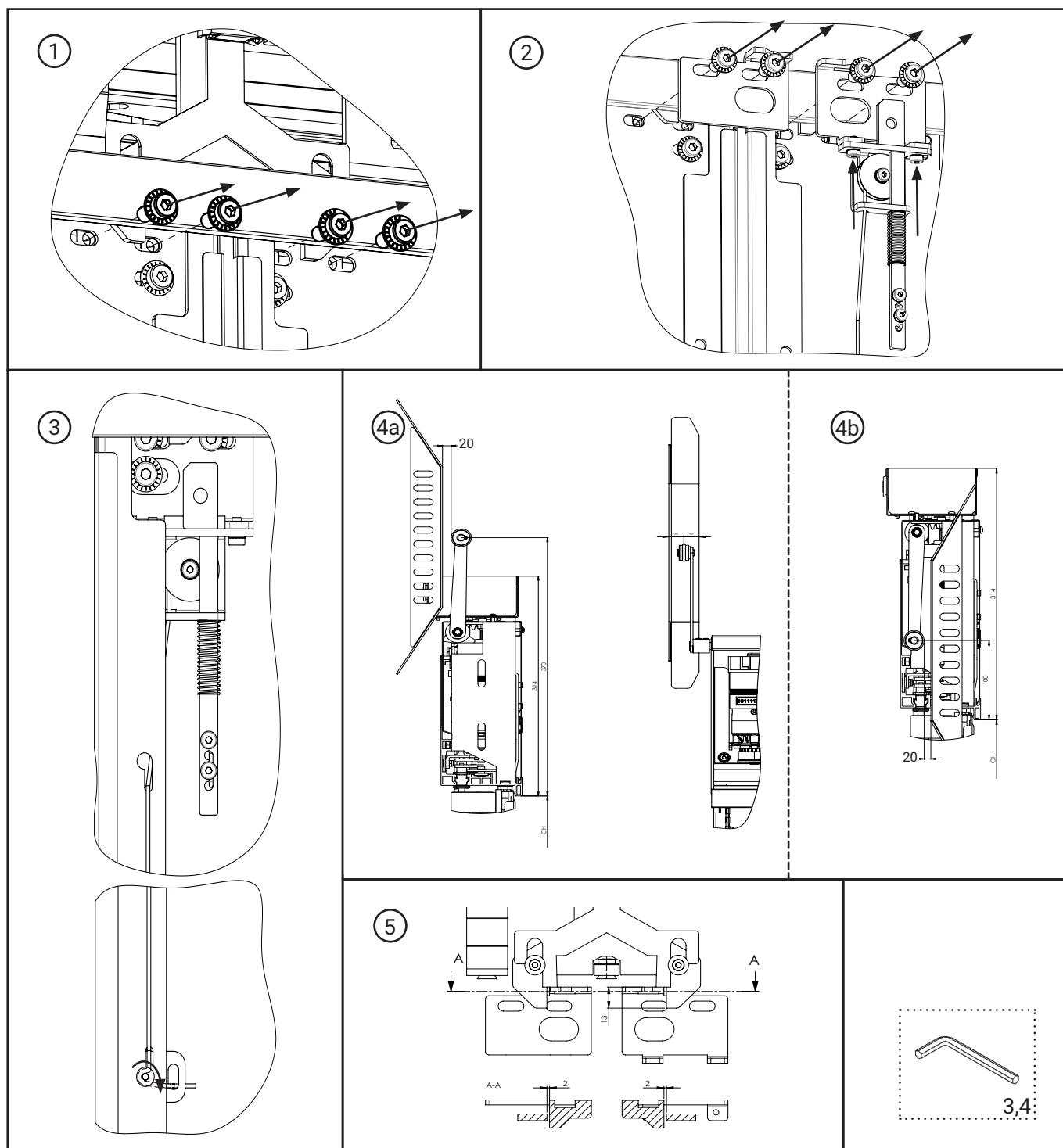

2.7 Installation curtain of light

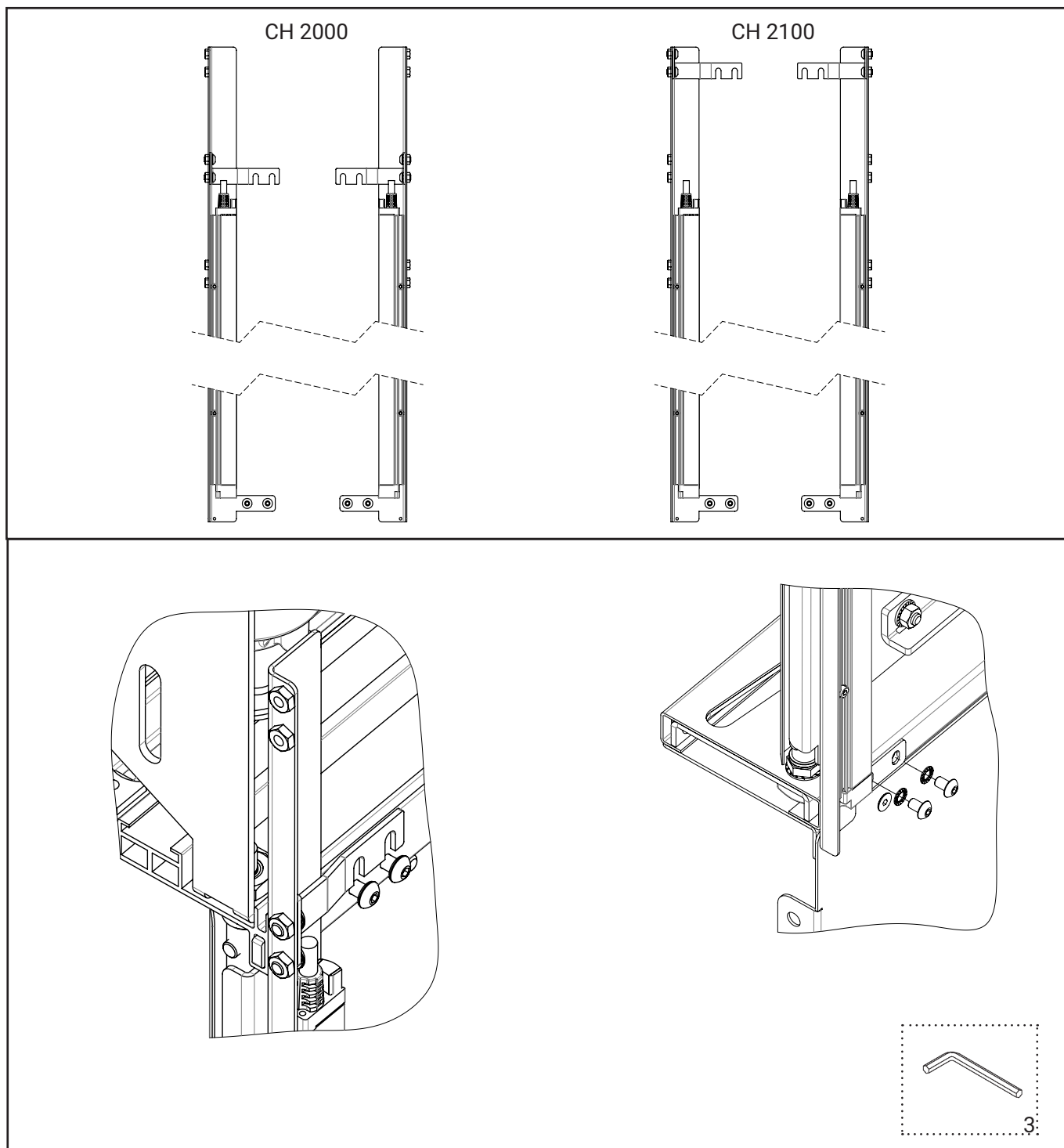

2.8 DIP Switch for ECO BUS 2.0 Doors

	ON	OFF
S1/1	Test Button operation (buttons active)	Normal operation (command inputs on X1 active)
S1/2	Automatic reopen/reclose on obstruction or IPD (Reopen O3 is switched)	No automatic reopen/reclose (only Reopen O3 is switched)
S1/3	<i>Electric shoe operation</i> (swing door mode)	Normal operation (command inputs on X1 active)
S1/4	POS. Function on Output O4	
S1/5	Close pulse (Medium) (Only on when Dip-Switch S1/7 is on)	Close pulse (Strong) (Only on when Dip-Switch S1/7 is on)
S1/6	Doorspeed slow (0,27m/s)	Doorspeed fast (0,4m/s)
S1/7	Close pulse off (For W-Folding Doors)	Close pulse on (siehe S1/5)
S1/8	Hold open/close only on active open close command	Automatic end keeping

(*) Modus 1:

I1 = ON -> Türe öffnet

I1 = OFF -> Türe schließt

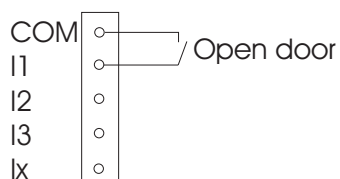

(*) Modus 2:

I1 = ON -> Türe schließt

I1 = OFF -> Türe öffnet

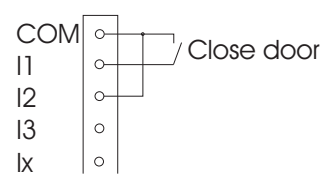

2.9 Troubleshooting

2.9.1 Door is not completely flat

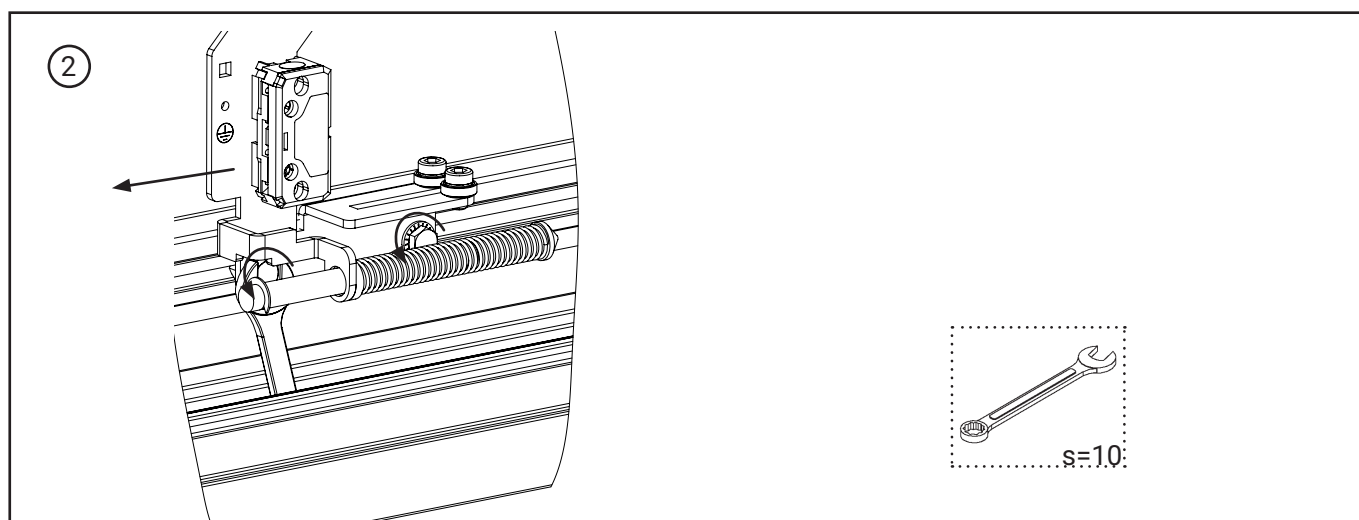
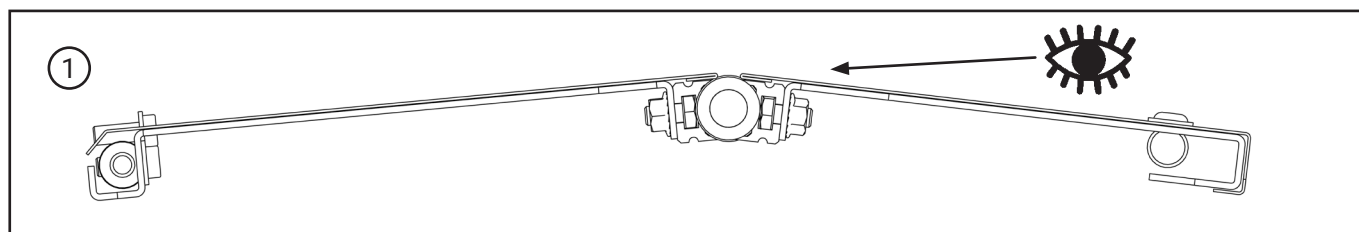

2.9.2 Gap between door panels

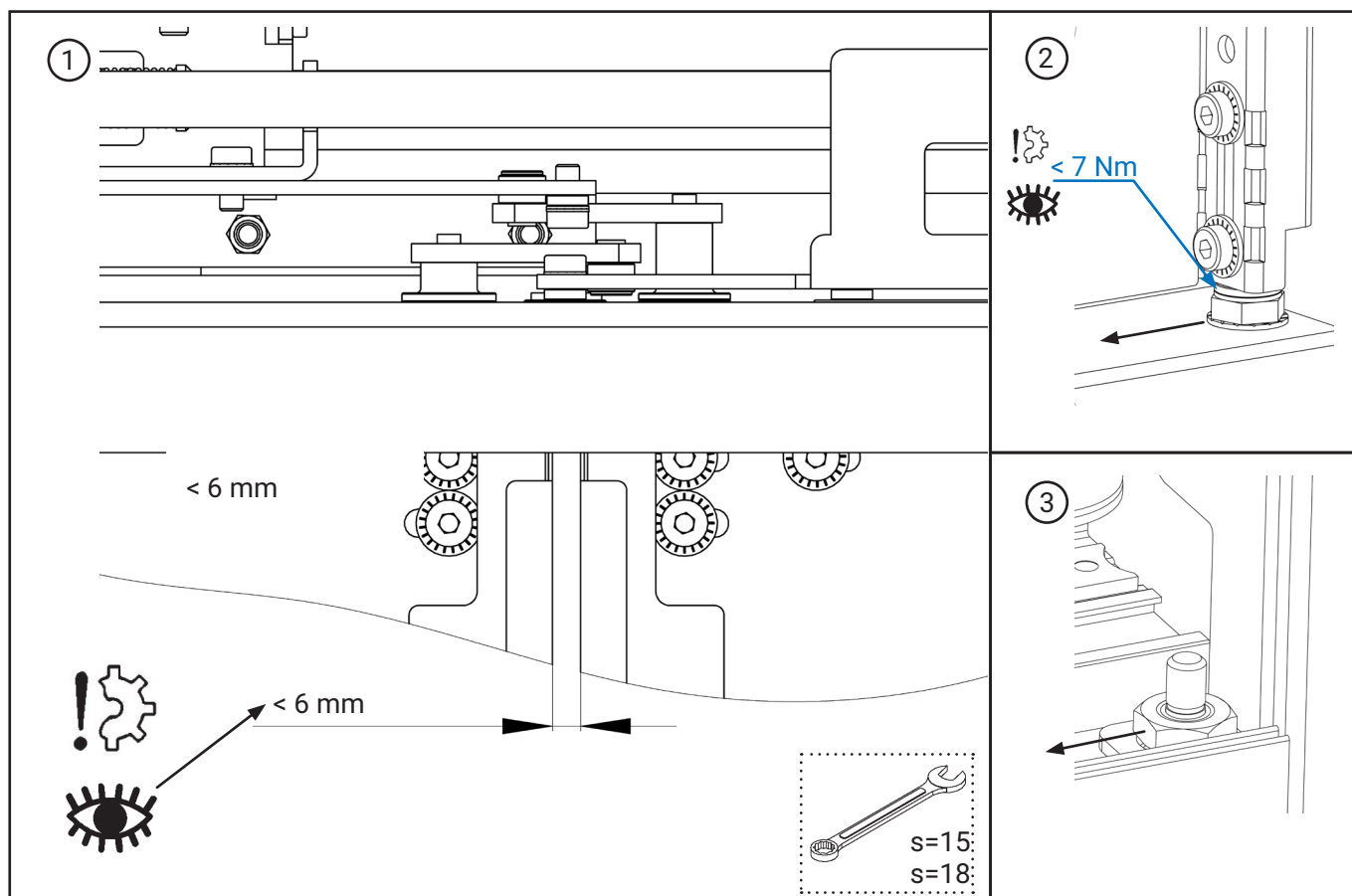

WARNINGS ON HOW TO KEEP THE DOORS IN GOOD OPERATING CONDITIONS



In order to prevent failures or incorrect operation and to maintain the system in good conditions, the technical efficiency of the system should periodically be checked, to ensure compliance with the applicable laws.

The technical efficiency depends on various factors such as:

- *Work load*
- *Years of operation*
- *Door weight*
- *Climatic and environmental conditions*
- *Cleanness of environment*
- *Correct maintenance*
- *Etc.*

And it can affect:

- *Clearance/interference between the doors, and between the doors and posts according to the applicable laws*
- *Clearance of coupling device*
- *Status/conditions of fixing and coupling elements*
- *Conditions of parts affected by wear*
- *Efficiency of the lock and relevant contacts*
- *Any other parts that may be affected by the type of application.*

For these reasons it is not possible to establish a general part replacement programme beforehand.



**YOUR GLOBAL PARTNER FOR COMPONENTS,
MODULES AND SYSTEMS IN THE ELEVATOR INDUSTRY**

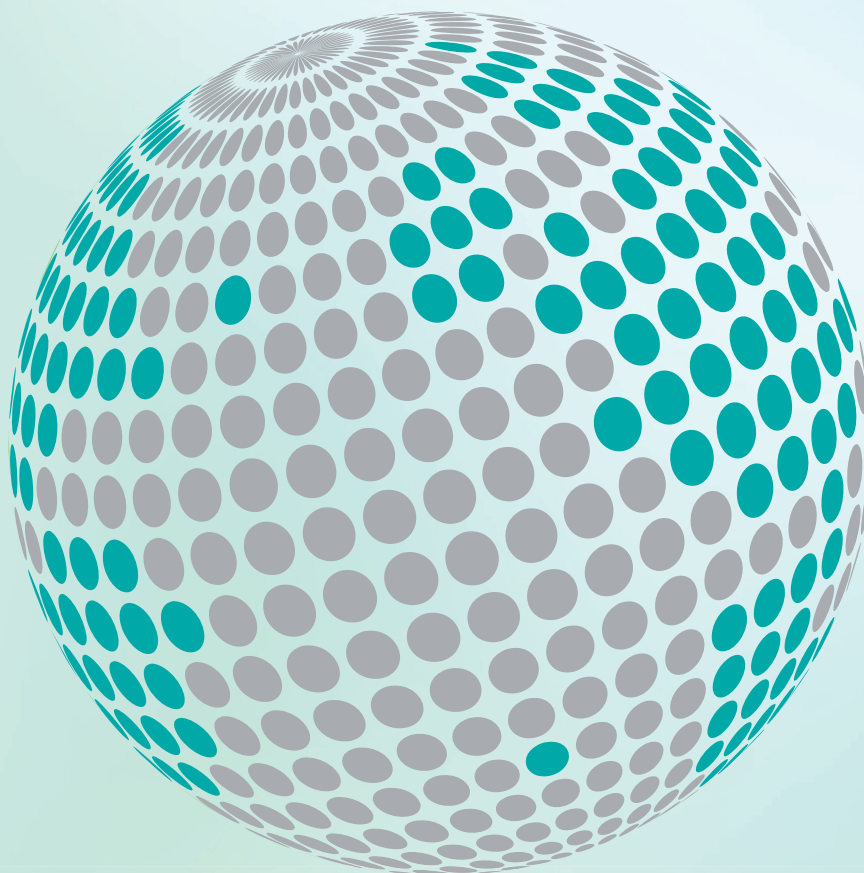

www.wittur.com

More information
about Wittur Group
available on-line.



SELCOM®
a WITTUR brand

Liftmaterial
a WITTUR brand

sematic®
a WITTUR brand