

SPARE PARTS



LLOYD'S BUILDING LONDON TOWER T1-T3-T5

FULL GLASS

Code	14-218216-GLASS.EN
Version	0
Date	13.07.2017

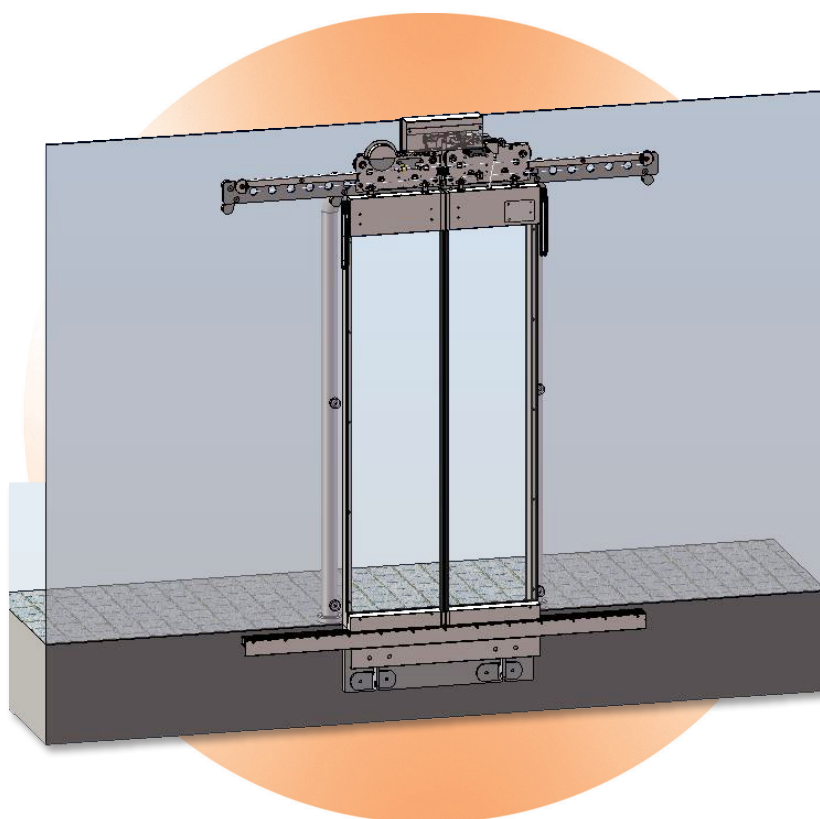

No part of this publication may be reproduced or translated, even in part, without prior written permission from WITTUR.

Subject to change without notice!

Questa pubblicazione non può essere riprodotta né tradotta, né interamente né in parte senza autorizzazione scritta della WITTUR.

Soggetto a modifica senza preavviso!

info@wittur.com
www.wittur.com

© Copyright WITTUR 2017



LLOYD'S BUILDING-LONDON - FULL GLASS - SPARE PARTS

Code 14-218216-GLASS.EN
Version 0
Date 13.07.2017

MOD.	DESIGNATION	DATE

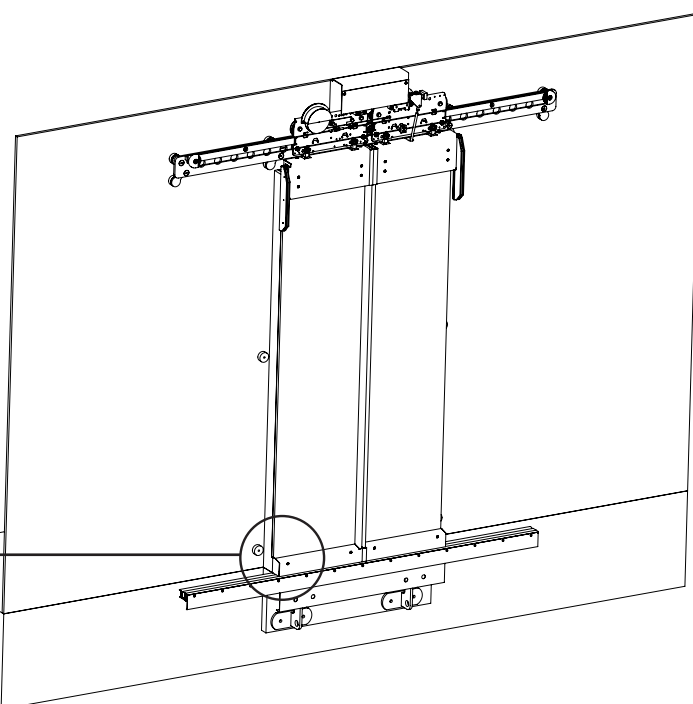
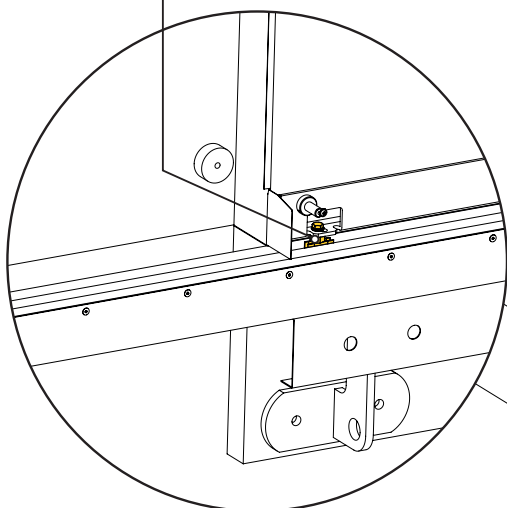
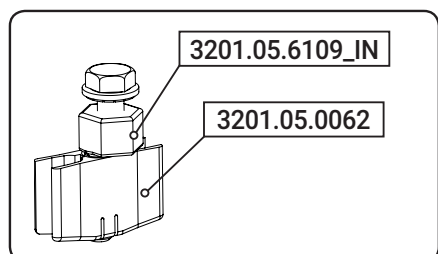
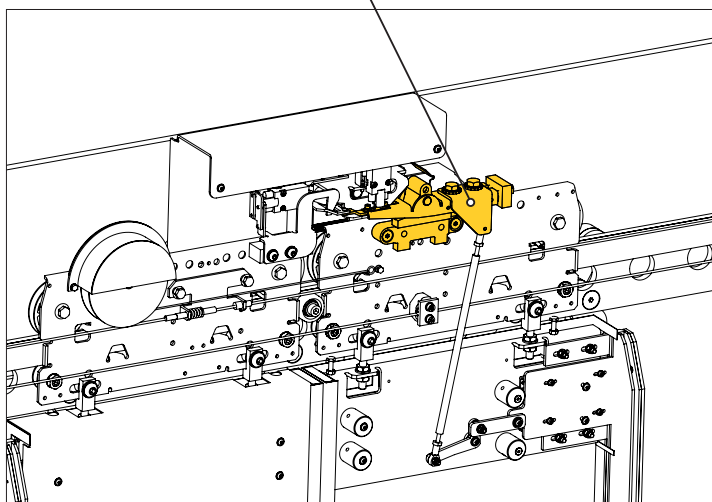
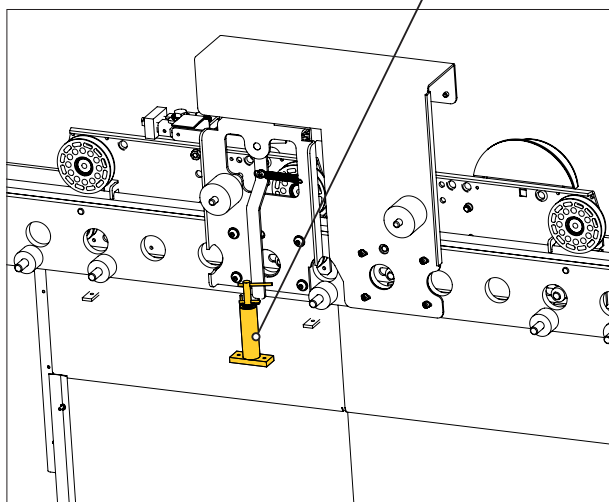
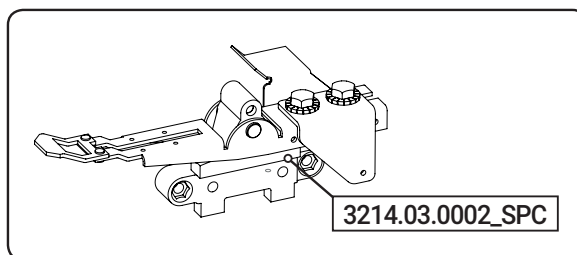
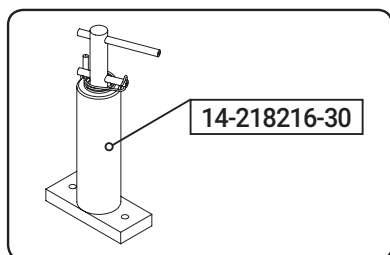



LLOYD'S BUILDING-LONDON - FULL GLASS - SPARE PARTS

Code 14-218216-GLASS.EN
Version 0
Date 13.07.2017
Page 2.5

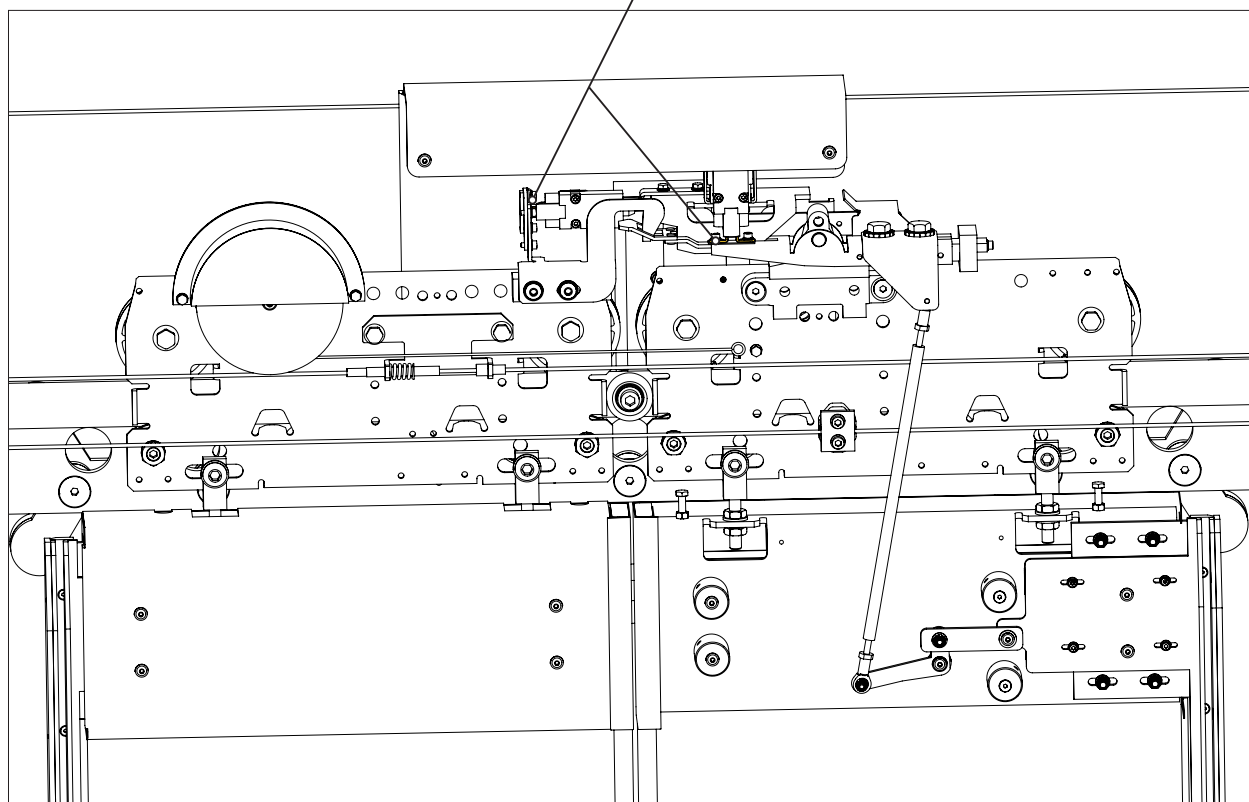
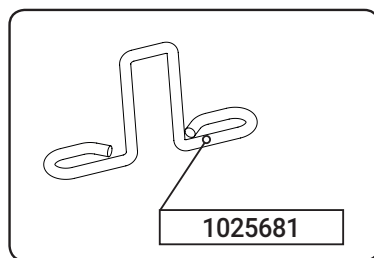

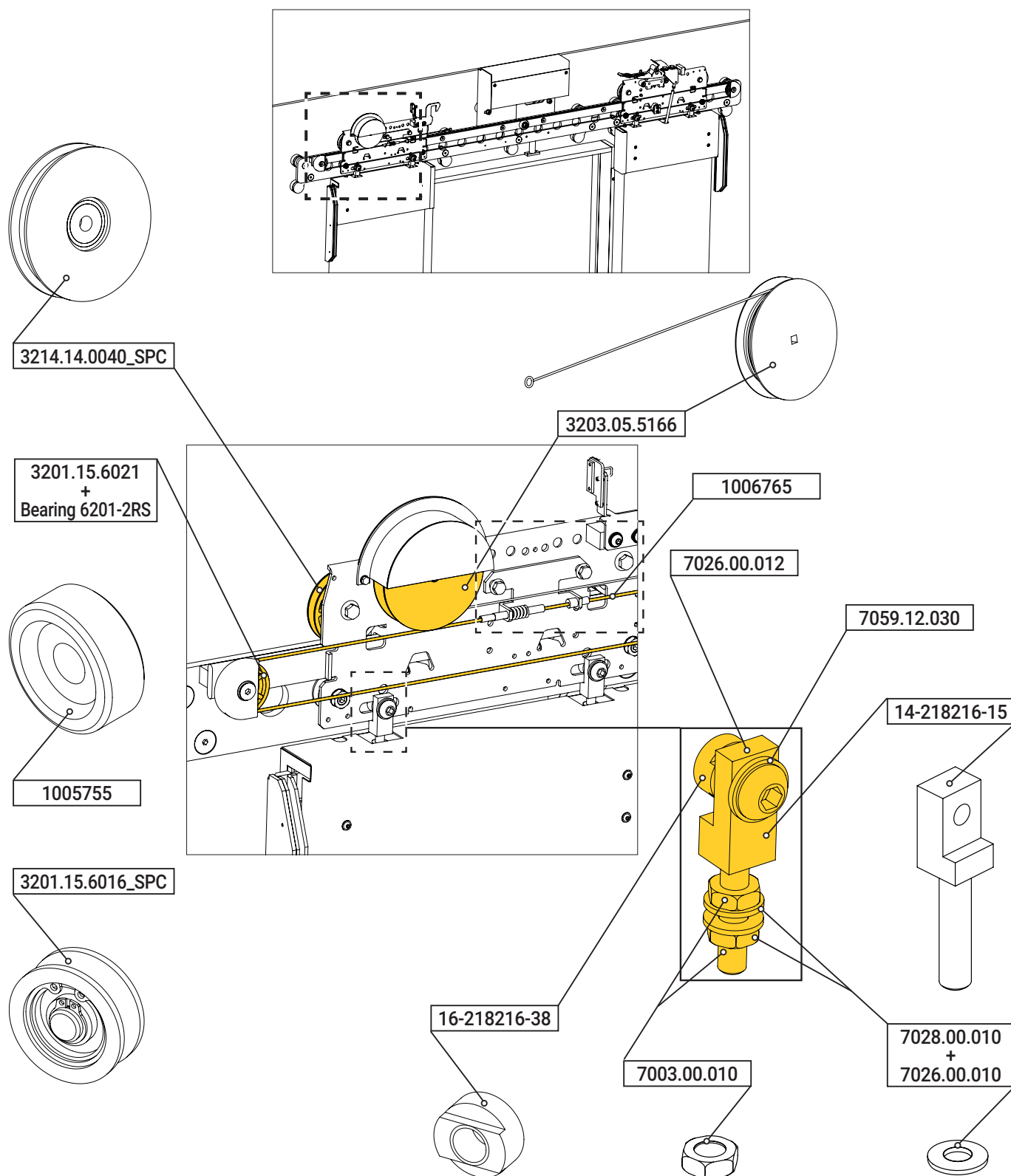

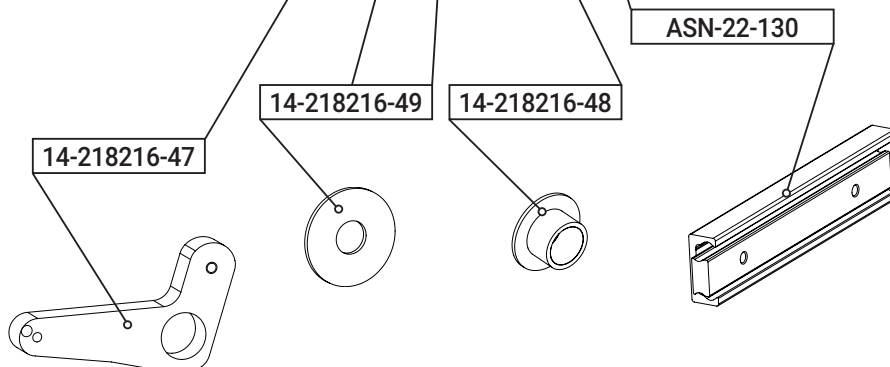
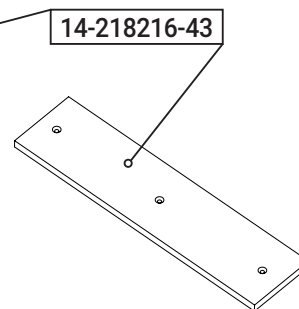
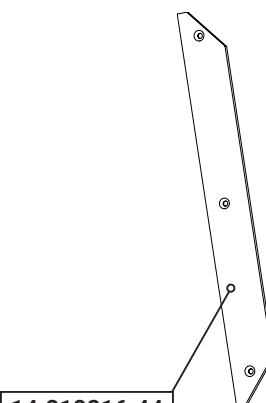
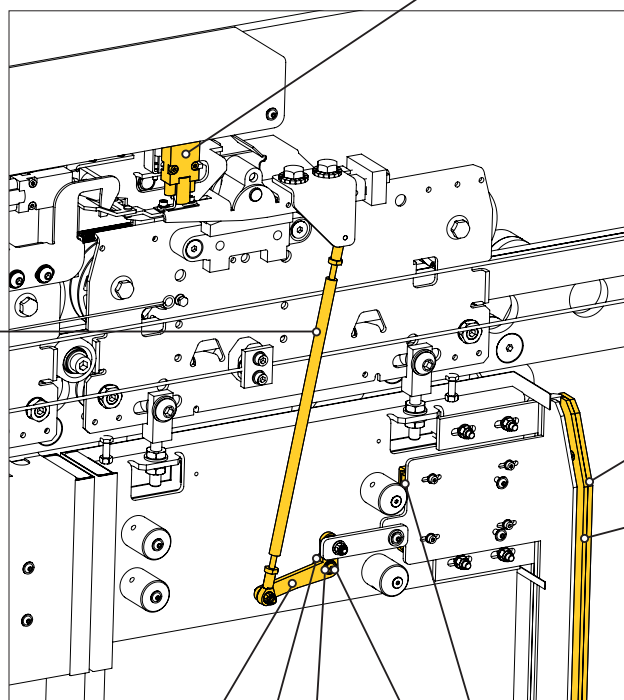
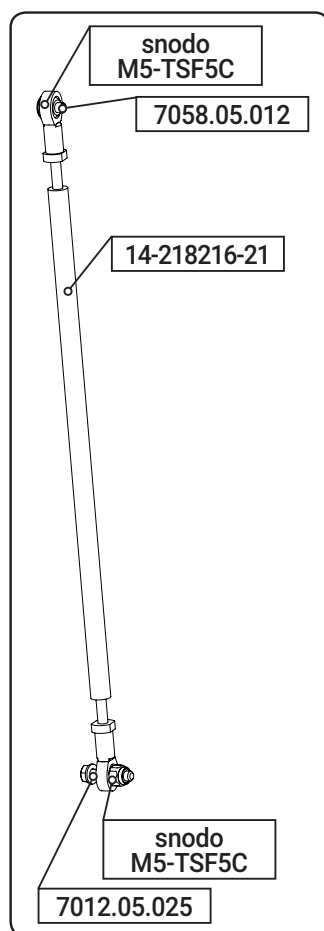
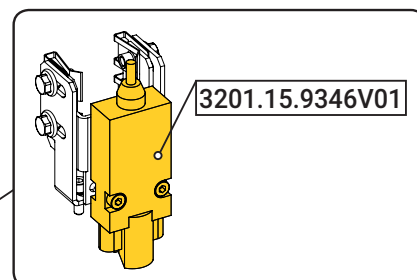
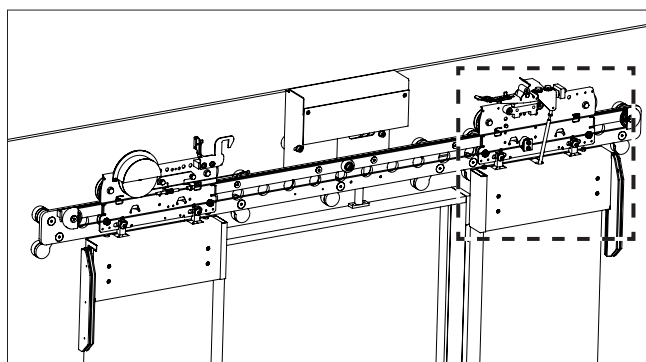



LLOYD'S BUILDING-LONDON - FULL GLASS - SPARE PARTS

Code 14-218216-GLASS.EN
Version 0
Date 13.07.2017
Page 5.5

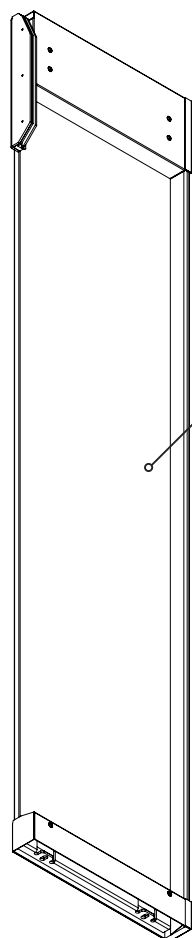
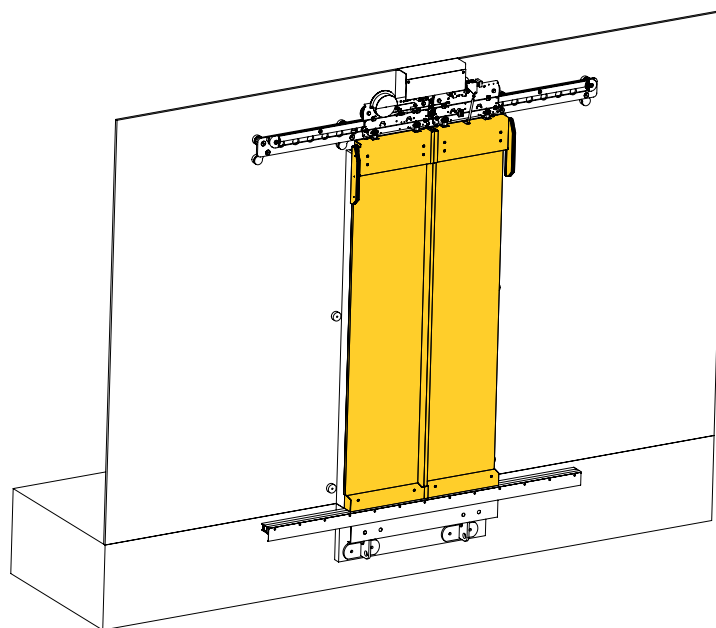

3201130493V02-Left

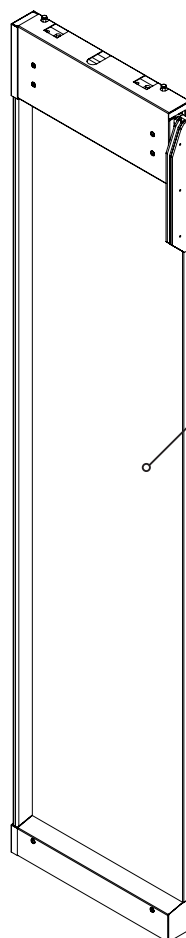

3201130493V01-Right



**YOUR GLOBAL PARTNER FOR COMPONENTS,
MODULES AND SYSTEMS IN THE ELEVATOR INDUSTRY**

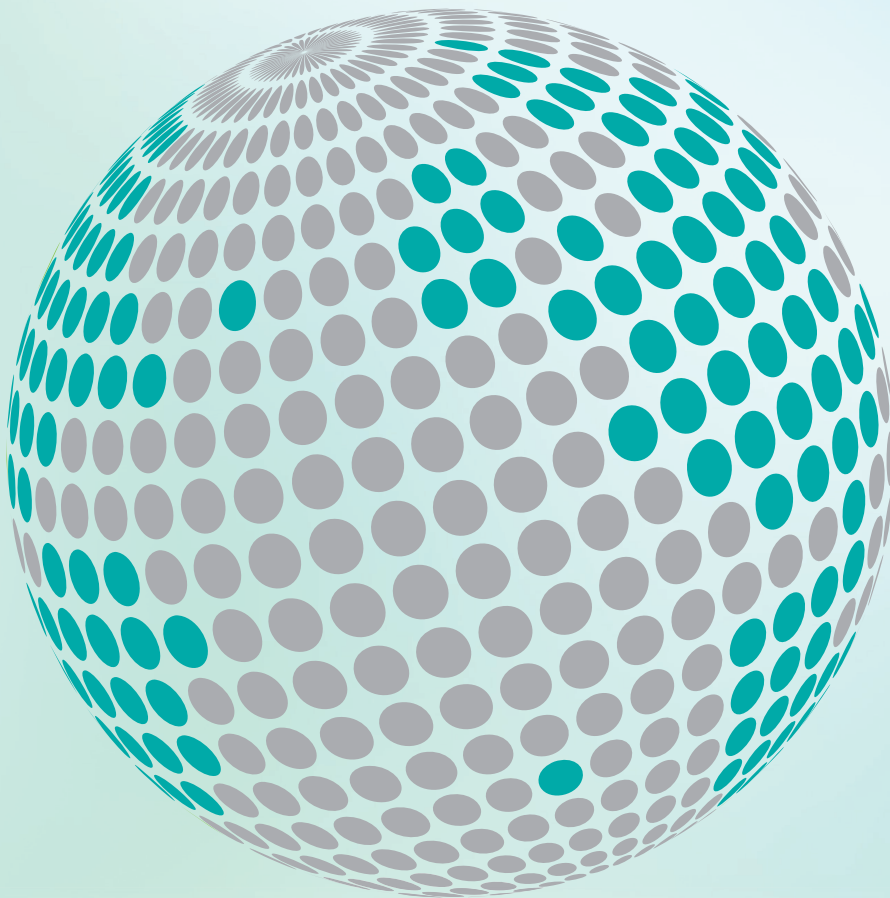

safety **in** *motion*™

www.wittur.com

More information
about Wittur Group
available on-line.



SELCOM®
a WITTUR brand

Liftmaterial
a WITTUR brand

semaTIC®
a WITTUR brand