

# WSG-09

## 配置和附件选项 / Options and Accessories



WITTUR Elevator  
Components (Suzhou) Co., Ltd.



文件编号 Document No.: J40091 版本 Rev.: D

### 基本信息 / General data

客户/Customer ..... 数量/Quantity .....  
订单号码/Order No. .... 联系人/COM .....  
日期/Date ..... 制单/Hand by .....  
交货地址/DELIVERY ADDRESS .....

### 马达选项 / Motor options

#### 主机电源电压 / Supply Voltage 380 V AC

曳引比 Suspension	○ 2:1		
曳引轮直径 Traction sheave Dt[mm]	○ Ø400	○ Ø450	
电机类型/额定载重 Motor Type/Rated load	○ (up to 630kg)	○ (up to 1050kg)	○ (up to 800kg)
	○ (up to 800kg)	○ (up to 1150kg)	○ (up to 1000kg)
	○ (up to 1000kg)	○ (up to 1050kg)	

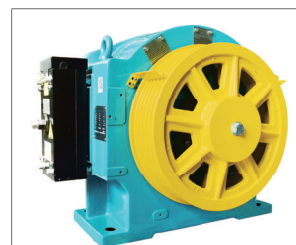

安装方向/Installation direction ○ 向上垂直安装/Vertical installation

额定速度/Rated speed ○ 1.0m/s ○ 1.5 m/s ○ 1.6 m/s ○ 1.75 m/s  
○ 2.0 m/s ○ 2.5 m/s (不适用于/not apply for 630kg)

制动器电压/Brake voltage ○ 工作电压/ Pull in voltage 110V DC; 保持电压/ Holding voltage 110V DC

编码系统/Encoder system ○ ECN 1313 - EnDat (海德汉/HEIDENHAIN) ○ ERN 1387 (海德汉/HEIDENHAIN)  
\* ○ TS5213N2503 (多摩川/TAMAGAWA)  
\* ○ EI53C9.25-2048-SA5N2T (汇通/INOVANCE)  
○ 其他/Others

\*备注/Remark: 多摩川/汇通编码器可替代海德汉的ERN1387编码器  
TAMAGAWA/INOVANCE encoder can replace of HEIDENHAIN ERN1387

颜色/Painting ○ 标准/Standard(Ral 5018) ○ 其他/Others

第1页共3页



## 曳引轮 / Traction sheave

### Dt=Ø400mm 有机房选配的曳引轮规格 (For MR)

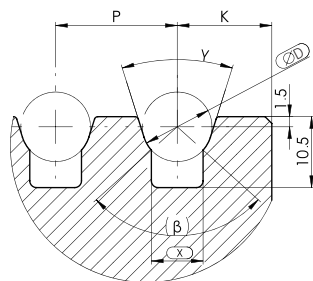

Code	绳槽规格	ΦD	P	K	β	γ	X
<input type="checkbox"/> P01	5xΦ10-18	10.3	18	14	96°	35°	7.65
<input type="checkbox"/> P02	5xΦ10-18	10.3	18	14	95°	30°	7.59
<input type="checkbox"/> P03	5xΦ10-18	10.3	18	14	90°	25°	7.28
<input type="checkbox"/> P04	6xΦ10-15	10.3	15	12.5	96°	35°	7.65
<input type="checkbox"/> P05	6xΦ10-15	10.3	15	12.5	95°	30°	7.59
<input type="checkbox"/> P06	6xΦ10-15	10.3	15	12.5	90°	25°	7.28
<input type="checkbox"/> P07	5xΦ10-15	10.3	15	20	96°	35°	7.65
<input type="checkbox"/> P08	5xΦ10-15	10.3	15	20	95°	30°	7.59
<input type="checkbox"/> P09	5xΦ10-15	10.3	15	20	90°	25°	7.28
<input type="checkbox"/> P10	5xΦ10-16	10.3	16	18	96°	35°	7.65
<input type="checkbox"/> P11	5xΦ10-16	10.3	16	18	95°	30°	7.59
<input type="checkbox"/> P12	5xΦ10-16	10.3	16	18	90°	25°	7.28
<input type="checkbox"/> P25	4xΦ8-12	8.2	12	32	96°	35°	6.1
<input type="checkbox"/> P27	6xΦ10-16	10.3	16	11	95°	30°	7.59
<input type="checkbox"/> P29	6xΦ8-13	8.1	13	17.5	95°	30°	5.97
<input type="checkbox"/> P31	4xΦ10-16	10.3	16	26	95°	30°	7.59

### Dt=Ø400mm 无机房选配的曳引轮规格 (For MRL)

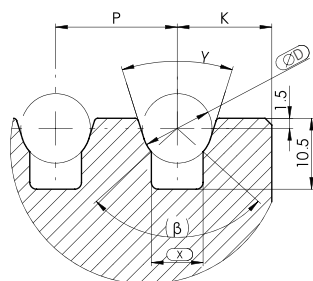

Code	绳槽规格	ΦD	P	K	β	γ	X
<input type="checkbox"/> P13	5xΦ10-18	10.3	18	14	96°	35°	7.65
<input type="checkbox"/> P14	5xΦ10-18	10.3	18	14	95°	30°	7.59
<input type="checkbox"/> P15	5xΦ10-18	10.3	18	14	90°	25°	7.28
<input type="checkbox"/> P16	6xΦ10-15	10.3	15	12.5	96°	35°	7.65
<input type="checkbox"/> P17	6xΦ10-15	10.3	15	12.5	95°	30°	7.59
<input type="checkbox"/> P18	6xΦ10-15	10.3	15	12.5	90°	25°	7.28
<input type="checkbox"/> P19	5xΦ10-15	10.3	15	20	96°	35°	7.65
<input type="checkbox"/> P20	5xΦ10-15	10.3	15	20	95°	30°	7.59
<input type="checkbox"/> P21	5xΦ10-15	10.3	15	20	90°	25°	7.28
<input type="checkbox"/> P22	5xΦ10-16	10.3	16	18	96°	35°	7.65
<input type="checkbox"/> P23	5xΦ10-16	10.3	16	18	95°	30°	7.59
<input type="checkbox"/> P24	5xΦ10-16	10.3	16	18	90°	25°	7.28
<input type="checkbox"/> P26	4xΦ8-12	8.2	12	32	96°	35°	6.1
<input type="checkbox"/> P28	6xΦ10-16	10.3	16	11	95°	30°	7.59
<input type="checkbox"/> P30	6xΦ8-13	8.1	13	17.5	95°	30°	5.97
<input type="checkbox"/> P32	4xΦ10-16	10.3	16	26	95°	30°	7.59

### Dt=Ø450mm 有机房选配的曳引轮规格 (For MR)

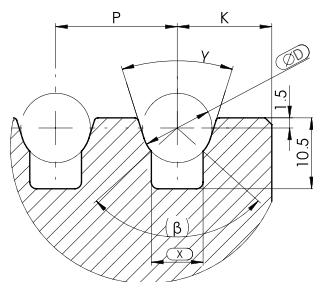

Code	绳槽规格	ΦD	P	K	β	γ	X
<input type="checkbox"/> P01	5xΦ10-18	10.3	18	14	96°	35°	7.65
<input type="checkbox"/> P02	5xΦ10-18	10.3	18	14	95°	30°	7.59
<input type="checkbox"/> P03	5xΦ10-18	10.3	18	14	90°	25°	7.28
<input type="checkbox"/> P04	6xΦ10-15	10.3	15	12.5	96°	35°	7.65
<input type="checkbox"/> P05	6xΦ10-15	10.3	15	12.5	95°	30°	7.59
<input type="checkbox"/> P06	6xΦ10-15	10.3	15	12.5	90°	25°	7.28
<input type="checkbox"/> P07	5xΦ10-15	10.3	15	20	96°	35°	7.65
<input type="checkbox"/> P08	5xΦ10-15	10.3	15	20	95°	30°	7.59
<input type="checkbox"/> P09	5xΦ10-15	10.3	15	20	90°	25°	7.28
<input type="checkbox"/> P10	5xΦ10-16	10.3	16	18	96°	35°	7.65
<input type="checkbox"/> P11	5xΦ10-16	10.3	16	18	95°	30°	7.59
<input type="checkbox"/> P12	5xΦ10-16	10.3	16	18	90°	25°	7.28

### Dt=Ø450mm 无机房选配的曳引轮规格 (For MRL)

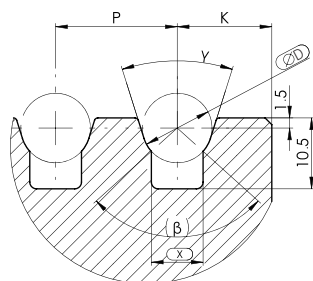

Code	绳槽规格	ΦD	P	K	β	γ	X
<input type="checkbox"/> P13	5xΦ10-18	10.3	18	14	96°	35°	7.65
<input type="checkbox"/> P14	5xΦ10-18	10.3	18	14	95°	30°	7.59
<input type="checkbox"/> P15	5xΦ10-18	10.3	18	14	90°	25°	7.28
<input type="checkbox"/> P16	6xΦ10-15	10.3	15	12.5	96°	35°	7.65
<input type="checkbox"/> P17	6xΦ10-15	10.3	15	12.5	95°	30°	7.59
<input type="checkbox"/> P18	6xΦ10-15	10.3	15	12.5	90°	25°	7.28
<input type="checkbox"/> P19	5xΦ10-15	10.3	15	20	96°	35°	7.65
<input type="checkbox"/> P20	5xΦ10-15	10.3	15	20	95°	30°	7.59
<input type="checkbox"/> P21	5xΦ10-15	10.3	15	20	90°	25°	7.28
<input type="checkbox"/> P22	5xΦ10-16	10.3	16	18	96°	35°	7.65
<input type="checkbox"/> P23	5xΦ10-16	10.3	16	18	95°	30°	7.59
<input type="checkbox"/> P24	5xΦ10-16	10.3	16	18	90°	25°	7.28

其它/Others

## 附件 / Accessories

- ☐ 远程松闸装置/Remote brake release (MRL)  
(带5米松闸线/with 5m bowden cable)
 ☐ 远程松闸装置/Remote brake release (MRL)  
(带7米松闸线/with 7m bowden cable)
- ☐ 手动松闸装置/Brake hand release (MR)

### 盘车装置/Turning gear device

- ☐ 带/with
 ☐ 不带/without

\* 若选择手动松闸装置则默认为适用有机房，此时曳引轮上已包含盘车大齿轮。

In case brake hand release is ordered, then we consider it is MR solution and the traction sheave contains big gear plate fitting for mechanical evacuation device.

### 主机线/Power cable

- ☐ 不带/without
 ☐ 定制/custom made

### 防护罩/Protection cover

- ☐ 不带/without (不适用于/not apply for Dt=Ø450)
 ☐ 标配/standard
 ☐ 定制/custom made

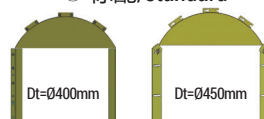

### 编码器线/Encoder cable

- ☐ 带/with
 ☐ 7m
 ☐ 10m
- ☐ 不带/without

变频器/Converter	变频器端链接方式/Connection (散头/DB_15插头式)	编码器/Encoder
<input type="radio"/> 艾默生 Emerson Unidrive		ECN1313
<input type="radio"/> 安川-L1000 Yaskawa-L1000		ECN1313
<input type="radio"/> 施耐德 Schneider Altivar		ERN1387/ TS5213N2503/ EI53C9.25-2048-SA5N2T
<input type="radio"/> 默纳克 Monarch		
<input type="radio"/> 明电舍 Meiden VT		
<input type="radio"/> 西子孚信 Xizitrust		
<input type="radio"/> 米高 Micovert		
<input type="radio"/> 富士 G11UD4C4、Lift		ECN1313
<input type="radio"/> 新时达 iAstar		ECN1313
<input type="radio"/> 新时达 iAstar		ERN1387/ TS5213N2503/ EI53C9.25-2048-SA5N2T
<input type="radio"/> 西威 SIEI		
<input type="radio"/> 科比 KEB F5		
<input type="radio"/> 艾默生 Emerson CN7		
<input type="radio"/> 索德 Soder S9		
<input type="radio"/> 默纳克 Monarch		
<input type="radio"/> 其它/Others		

### 证书/Certification

- ☐ GB7588 -2003+XG1-2015
 ☐ EN81-20/50:2014
- ☐ TSX F38003820180124
 ☐ TSX F38003820180204
- UCMP证书1: 适用于Ø400轮径, 额定载重≤1050kg, 速度≤2m/s
UCMP证书2: 适用于Ø400轮径, 额定载重≤1150kg, 速度≤2.5m/s
或Ø450轮径, 额定载重≤1050kg, 速度≤2.5m/s

### 包装/Package

- ☐ 夹板箱 (每箱1台, 不可堆叠) / Plywood box (one per box, can not be stacked)
 ☐ 夹板箱 (每箱1台, 可堆叠2层) / Plywood box (one per box, stackable 2 layers)
 ☐ 其他/Others