



# Liftmaterial

a WITTUR brand

**Manuale di Installazione**  
*Installation manual / Notice technique*  
*Installationshandbuch / Manual de Instalación*

**V. 1.2**

## Index

### **FLOORS connection diagrams**

With or without "Call Enable Key" - *page 4*

With or without "Call Enable Key" + DISPLAY LIP - *page 5*

With or without "Call Enable Key" + DISPLAY LOP - *page 6*

With "Service Key" only - *page 7*

With "Service Key" only + DISPLAY LIP - *page 8*

With "Service Key" only + DISPLAY LOP - *page 9*

### **COP mounting instructions**

COP-short - Silverlight - *page 10*

COP-long - Silverlight - *page 12*

### **LOP mounting instructions**

LOP - Silverlight - *page 14*

LOP - Beetle - *page 16*



for

# Liftmaterial

a WITTUR brand

## V-BDU layout

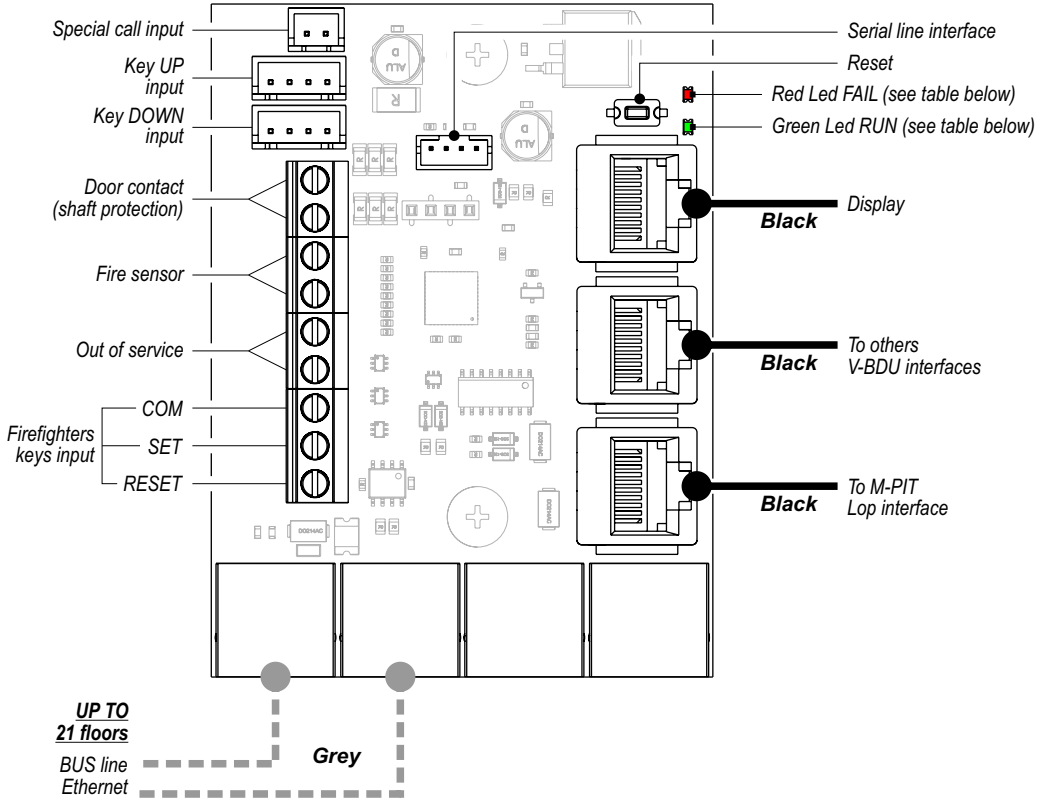

### RJ-45 (T8) Black

Connections to the floor length 4mt



### RJ-45 (T8) Grey

CAT.6-AWG22  
for additional supply  
interfloor-interfloor: 5 mt  
interfloor-shaft room: 10 mt

Blue AWG24 Cat.5 cable and Grey AWG22 Cat.6 cable will be used to max 14 floors and to while supplies of Blue AWG24 Cat.5 cable. For more than 14 floors (and after while supplies) only Grey AWG22 Cat.6 will be used.

Red Led Green Led

FAIL



RUN



### Description

OFF	ON	On duty
OFF	OFF	Out of service (not powered / broken power supplier)
ON	OFF	Out of service (micro fault / not programmed)
ON	1	Out of service (serial line communication)
ON	2	Out of service (undefined BDU address)
ON	3	Out of service (Car at the floor with invalid or unprogrammed BDU)

### Legend

ON = power on



= continuous blinking

OFF = shut down



= continuous blinking



## With or without "Call Enable Key" + DISPLAY LIP

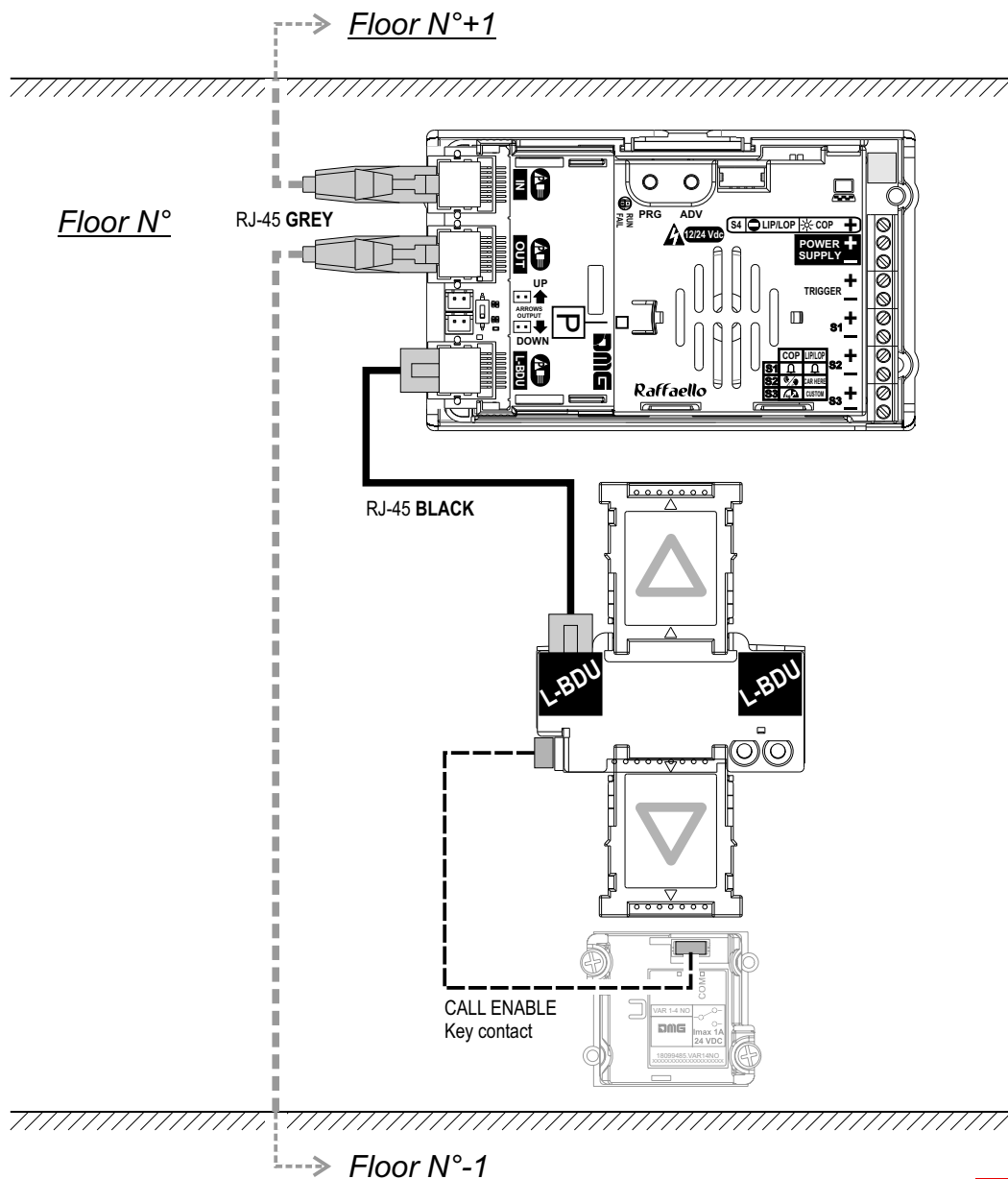

With or without "Call Enable Key" + DISPLAY LOP

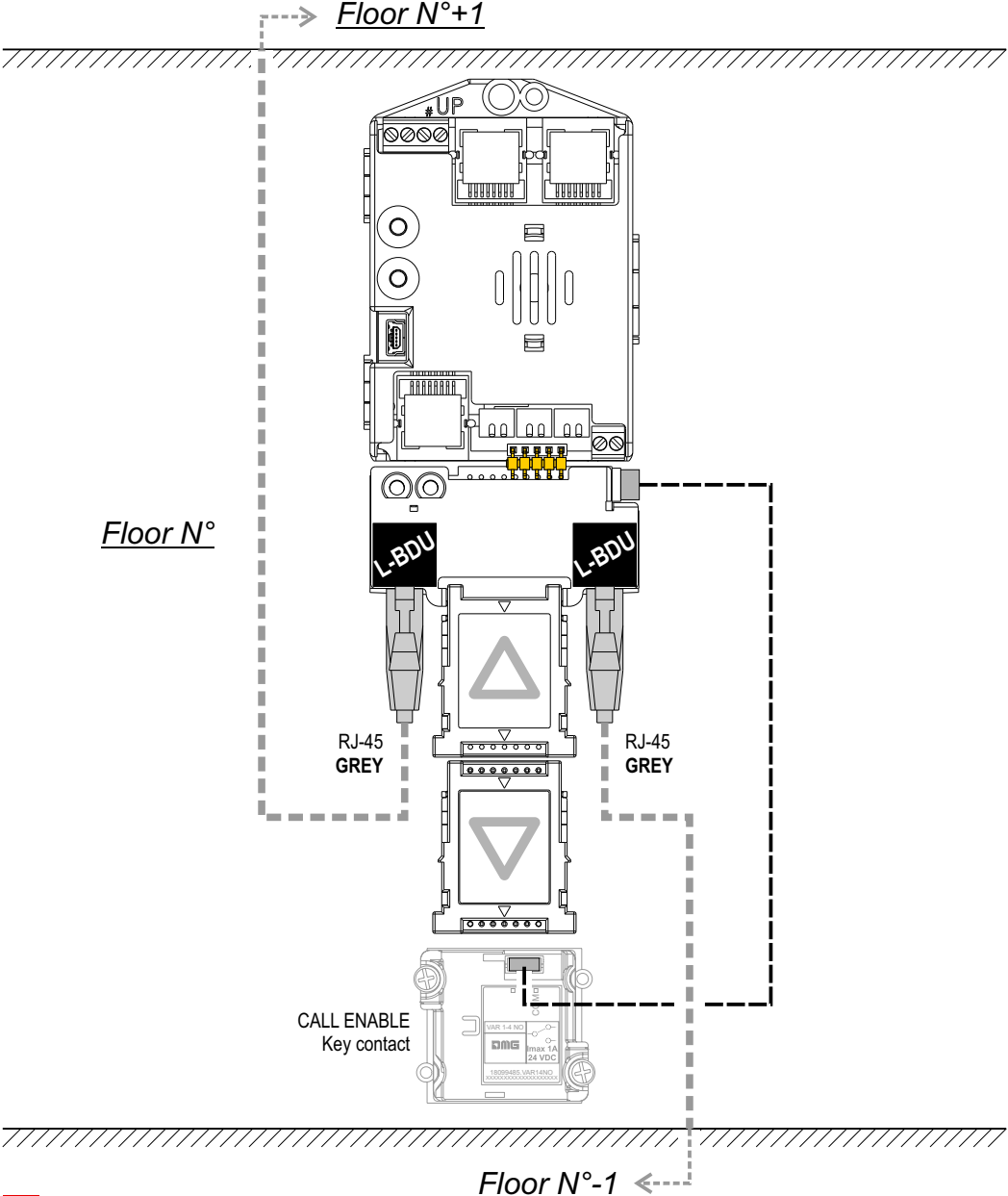

## With "Service Key" only

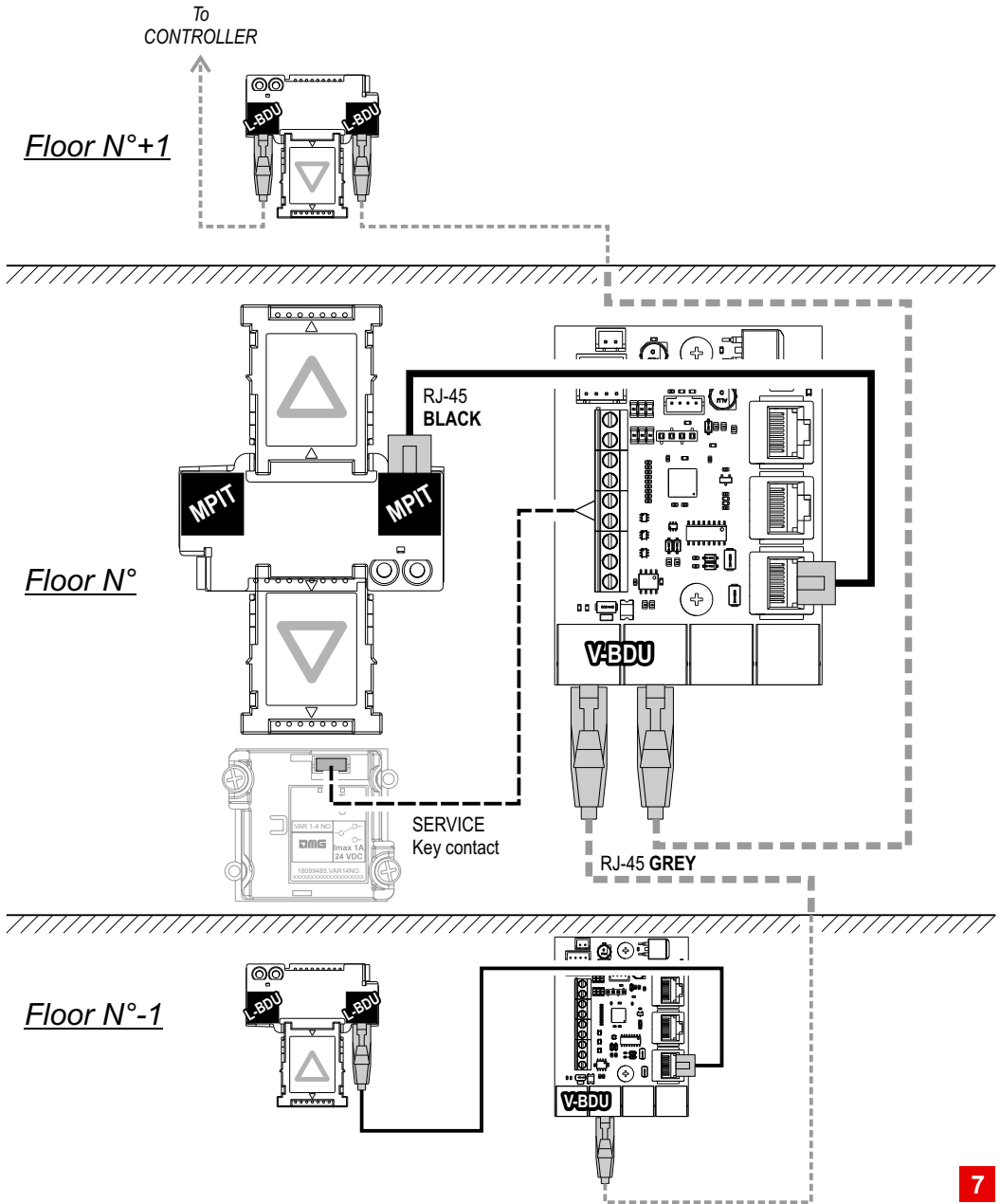

## With "Service Key" only + DISPLAY LIP

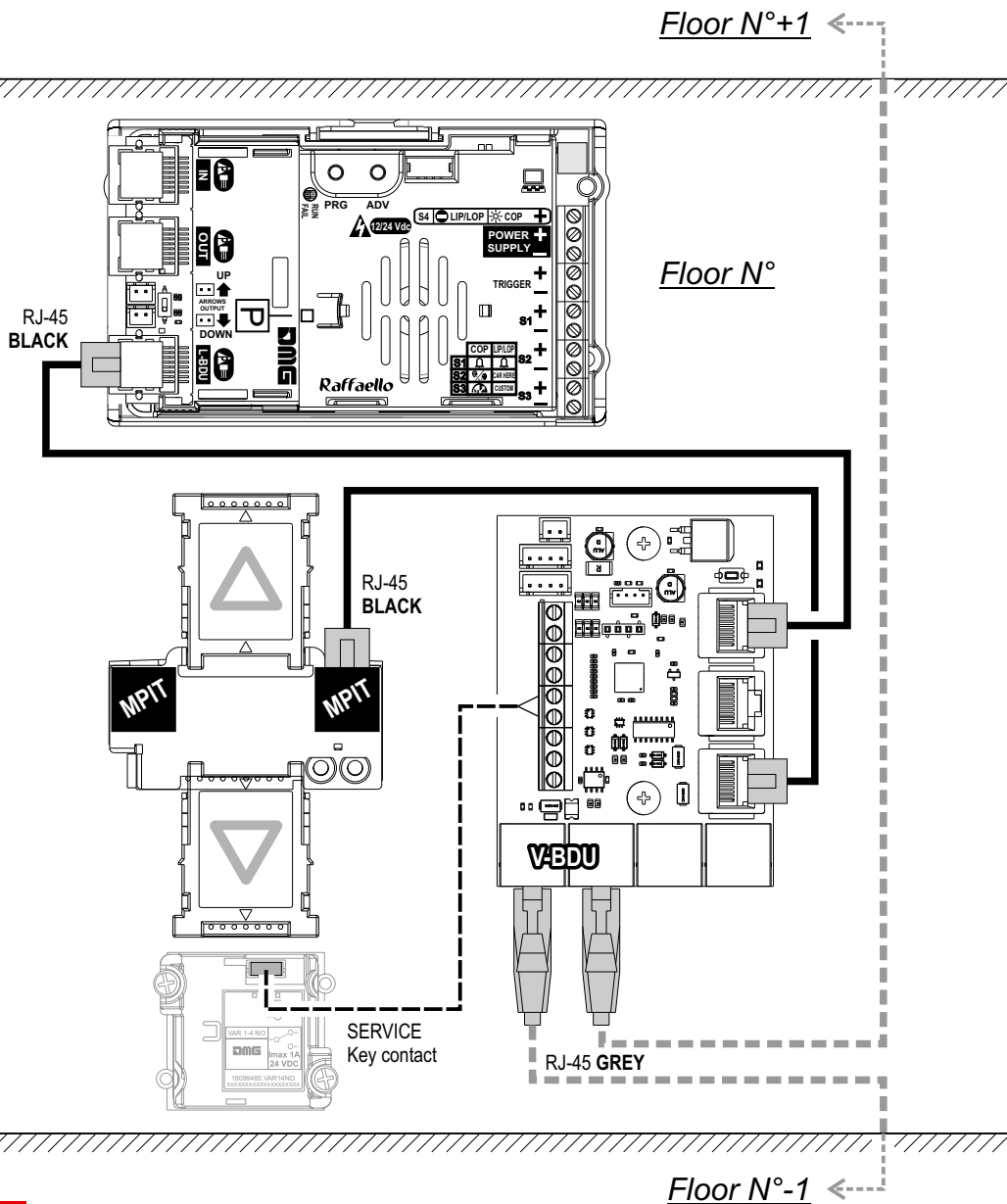



# With "Service Key" only + DISPLAY LOP

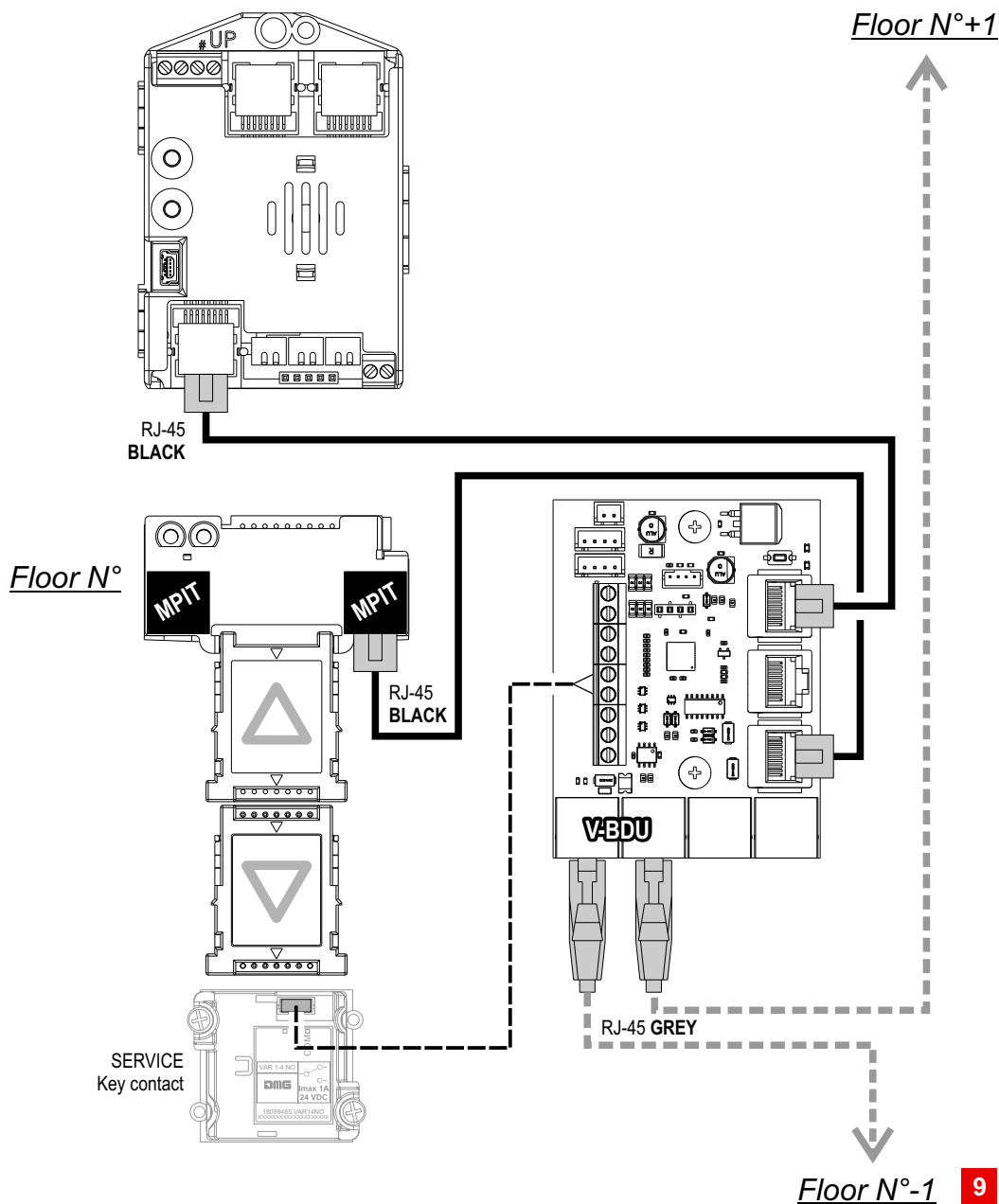

# COP mounting instructions

## COP-short - *Silverlight*

### Fixing kit

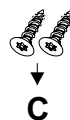
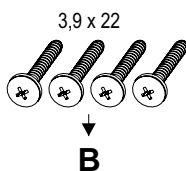
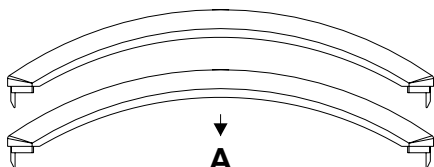

**1**

Free zone for end caps fixing.

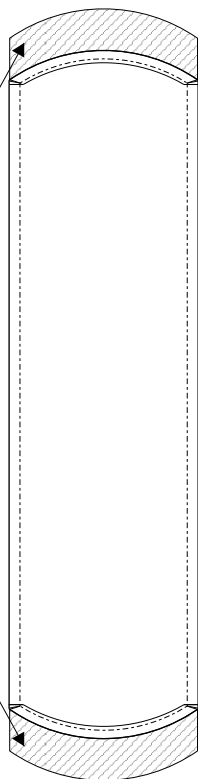

**2**

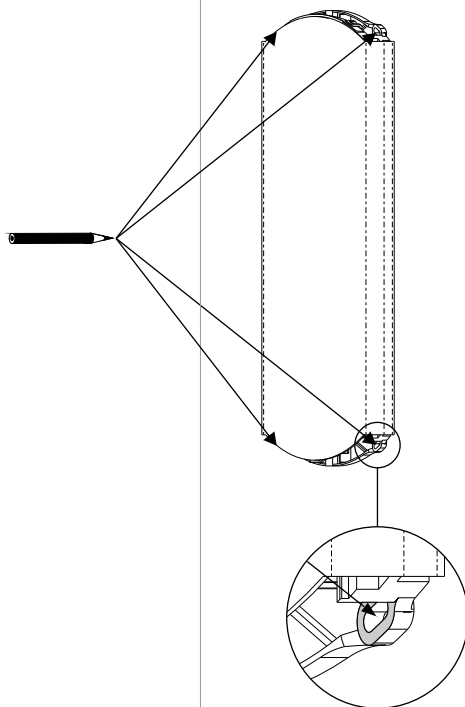

3

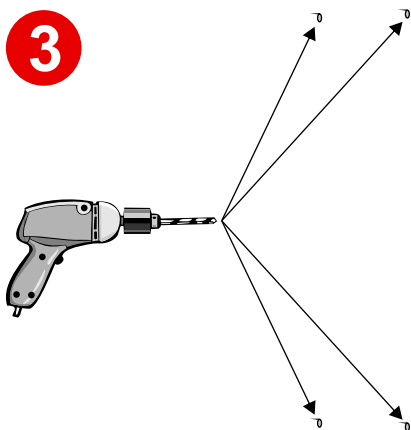

----- TABLE OF REFERENCE HOLES -----

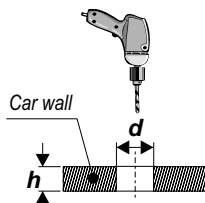

$h$	$d$
$0,5 \pm 0,9 \text{ mm}$	2,95 mm
$0,9 \pm 1,2 \text{ mm}$	3,10 mm
$1,2 \pm 1,5 \text{ mm}$	3,25 mm
$1,5 \pm 1,9 \text{ mm}$	3,50 mm
$1,9 \pm 2,7 \text{ mm}$	3,60 mm

4

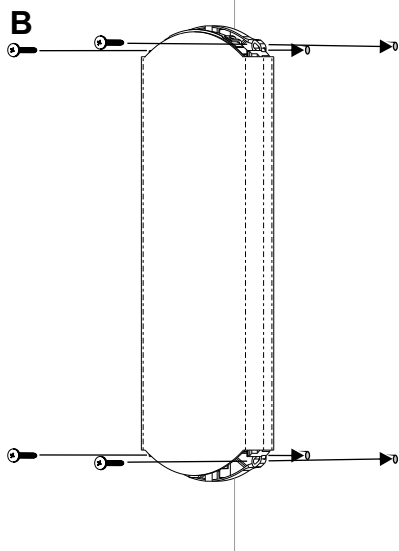

5

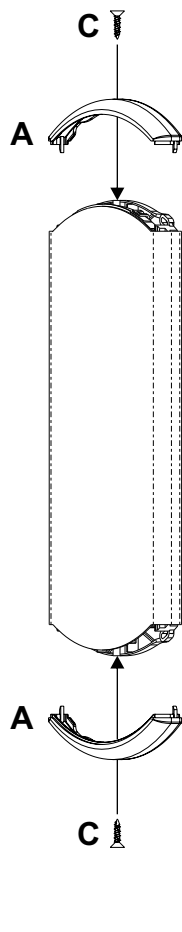

# COP-long - Silverlight

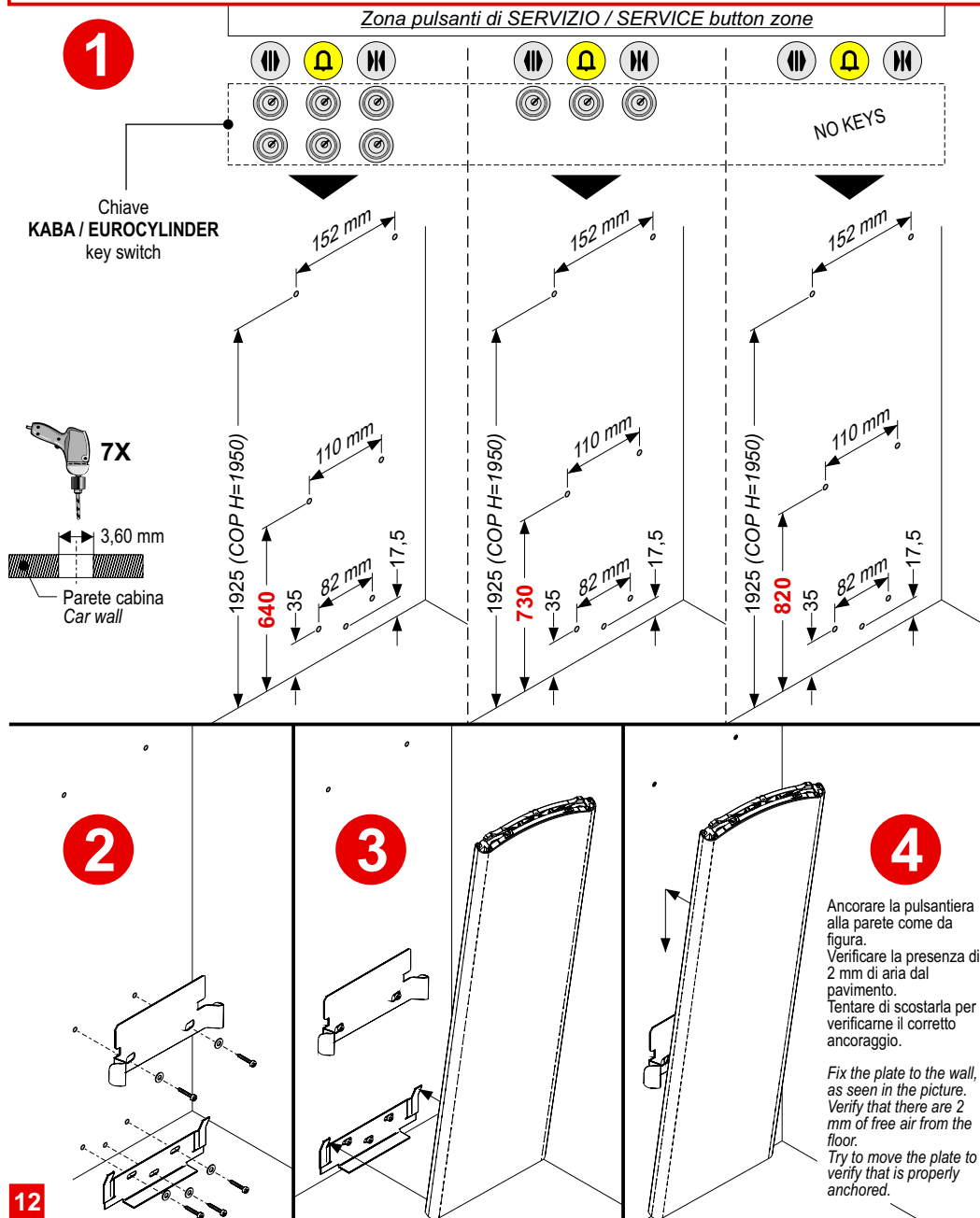

5

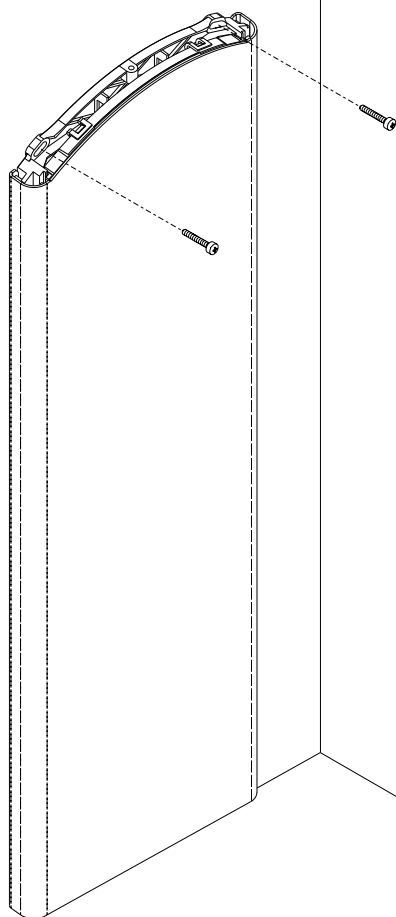

6

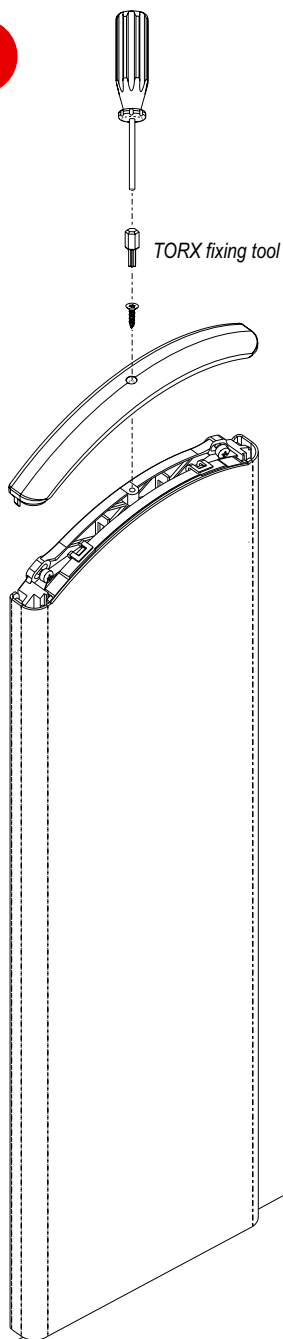

# LOP mounting instructions

## LOP - *Silverlight*

### Fixing kit

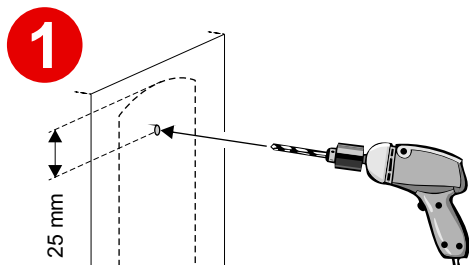
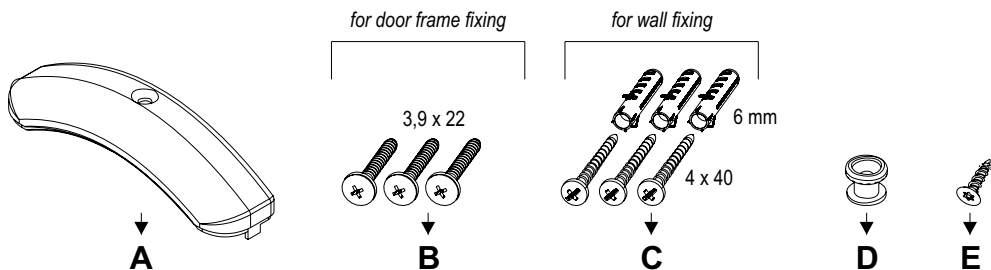
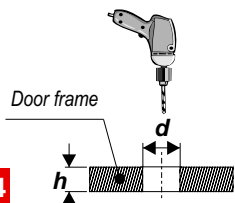
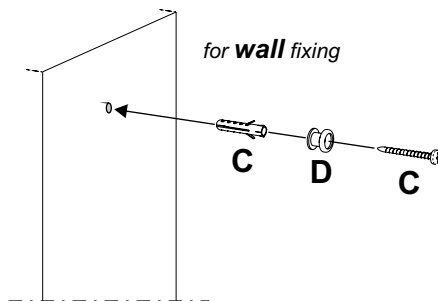
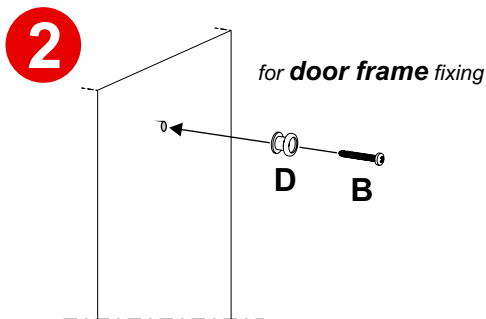

TABLE OF REFERENCE HOLES



$h$	$d$
$0,5 \div 0,9 \text{ mm}$	$2,95 \text{ mm}$
$0,9 \div 1,2 \text{ mm}$	$3,10 \text{ mm}$
$1,2 \div 1,5 \text{ mm}$	$3,25 \text{ mm}$
$1,5 \div 1,9 \text{ mm}$	$3,50 \text{ mm}$
$1,9 \div 2,7 \text{ mm}$	$3,60 \text{ mm}$



3

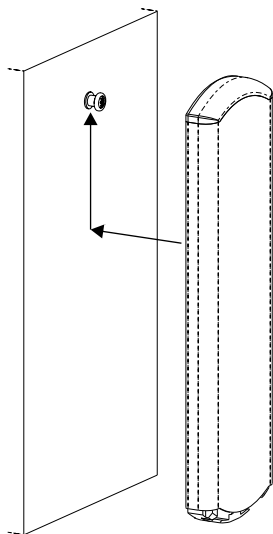

4

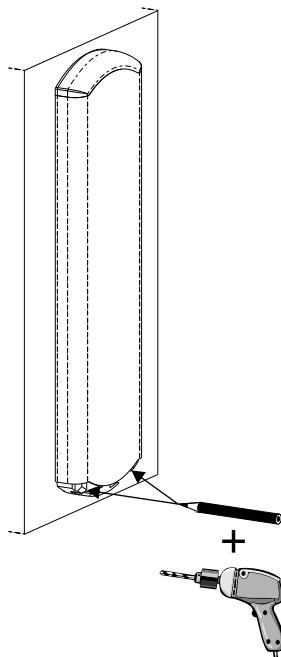

5

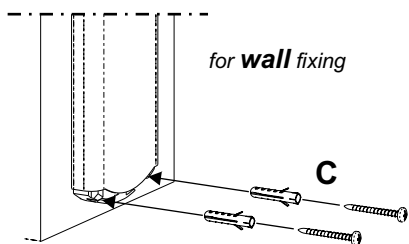
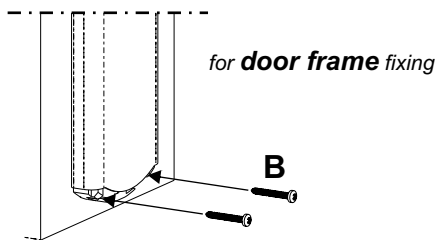

6

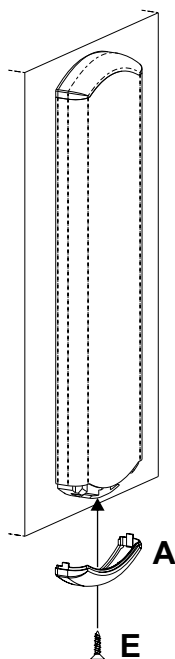

# LOP - BEETLE

## Fixing kit

Ref. Q.ty

Fixing support



— A — 1

for door frame fixing 3,9 x 22



— B — 4

for wall fixing  
4 x 40



— C — 4

6 mm



— D — 4

Spacers for push button mounting



1

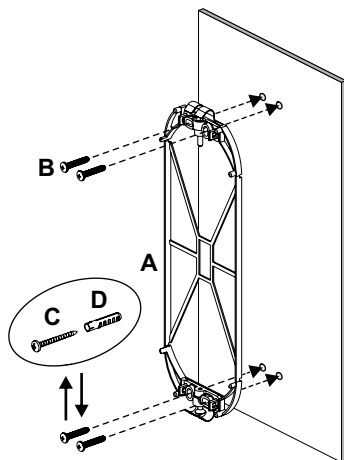

2

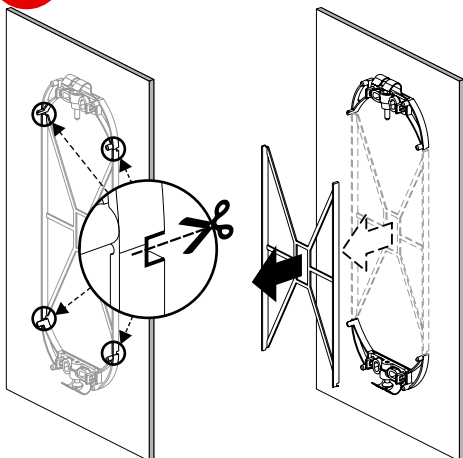

3

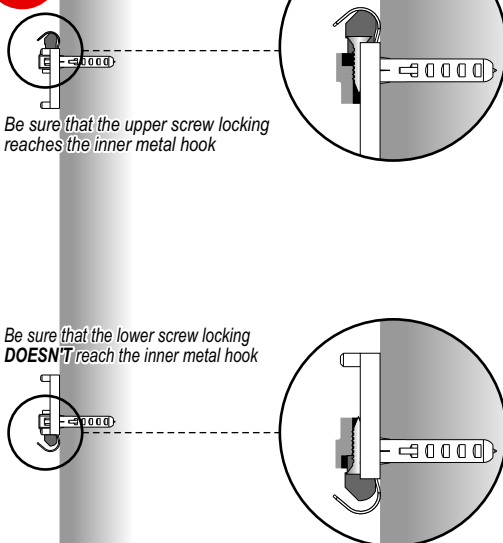



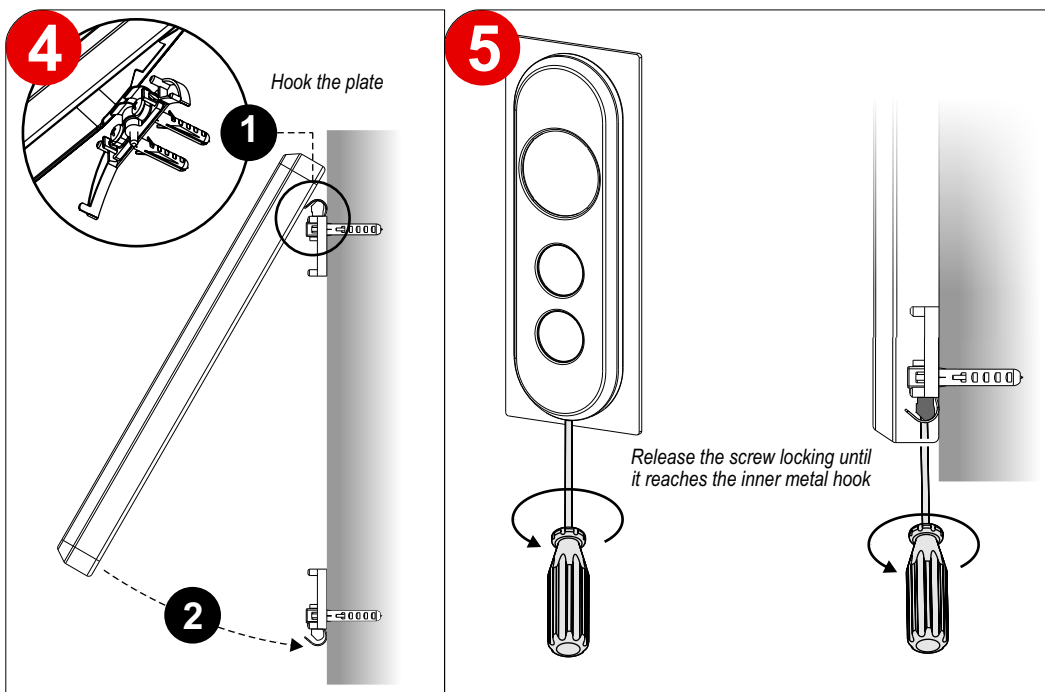

### **Dismantling**

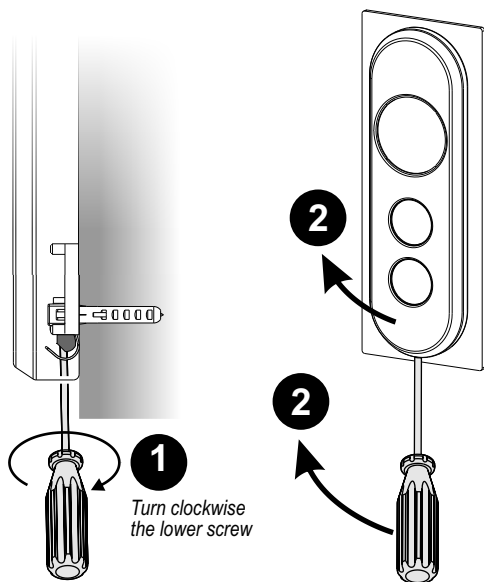





Consultare il manuale **"Precauzioni d'uso e sicurezza"**  
Refer to the **"Safety and usage precautions"** manual  
Consulter manuel technique **"Precautions de securite et d'emploi"**  
Handbuch lesen **"Sicherheits- und Gebrauchsanweisung"**  
Consulte el manual **"Precaucioned de seguridad"**



[www.dmg.it](http://www.dmg.it) / solutions



**DMG SpA**

*Via delle Monachelle, 84/C • 00071 POMEZIA (ROMA) • ITALIA*

*Tel. +39 06930251 • Fax +39 0693025240*

*info@dmg.it • www.dmg.it*

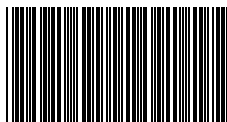

93010260